

PRINCESS F55



BROKERAGE

HIGHLIGHTS

/ LOW ENGINE HOURS
/ PERFECT CONDITION
/ 3 CABINS + 1 CREW
/ AC
/ 17.5 KW GENERATOR

/ ELECTRO-HYDRAULIC PLATFORM AND PASSARELLE
/ PREMIUM UPHOLSTERY
/ PREMIUM TV/AV EQUIPMENT
/ UPGRADED LIGHT PACKAGE

SPECIFICATIONS

Localisation	Italy, Naples	Contenance en eau douce	608 l
Année	2019	Cabines	3+1
Longueur	17.6 m	Moteurs	VOLVO PENTA
Largeur	4.87 m	Puissance max	2 x 900 hp
Tirant d'eau	1.46 m	Vitesse max	33 +
Déplacement	25 tonnes	Engine hours	490 m/h
Capacité en carburant	2750 l	Prix	1 600 000 € (inc VAT)

EQUIPMENT

Walnut interior wood Satin finish (galley floor is walnut as standard)

International VHF

Continental 200v/240v sockets

Aft Cabin fit out

Teak laid flybridge deck

Electro-hydraulic transom platform

Electro-hydraulic telescopic passerelle (2,9m) with automatic hand rails

Additional 20m of 10mm anchor chain to give a total of 60 meters

Onan 17,5 kw generator in place of standard

Dishwasher fitted in galley

Foredeck freshwasher anchor/deckwash system

Stern docking lights

Exterior Lightning Upgrade Package

Premium Audio System

Master stateroom 40 » LED TV

Forward stateroom 32 » LED TV

Garmin XHD colour radar with 24 » kw Radome

Additional 16 Garmin installed to upper and lower helm

Garmin remote control keypad at the lowe helm position

Garmin AIS 800 Class B transponder

Foredeck seating in upgraded Comfort Exterior II Met

Airconditioning/heating reverse cycle (78,000 BTU) suitable for temperature to 40 grades (tropical)

Aft cabin air conditioning

Electric overboard discharge system in addition to standard to manual system

Aft cabin toilet to be connected into holding tank system

Electric stern rope handling winches (2)

Foredeck sunbedcushion(with adjustable headrest) in upgraded Comfort Exterior III Met

Reticulated foam for foredeck sunbeds

Reticulated foam for all standard exterior cockpit foredeck and flybridge seating/sunpads

Foredeck seating in Comfort Exterior III Vogue

Cockpit and flybridge upholstery including helms seats in upgraded Comfort Exterior III Vogue

Supply of scatter cushions

Stools for use at dinette in forward saloon area (2)

Quilts rectangular quilted blankets and headboards

Foredecking seating Comfort Exterior III Vogue

Bidet Shower

Supply Jabsco water pump

Supply additional lighting

Supply with mood lighting under saloon

MOTEURS

2 x VOLVO PENTA 900 HP (490 hours)

EXTERIOR



INTERIOR



LAYOUTS

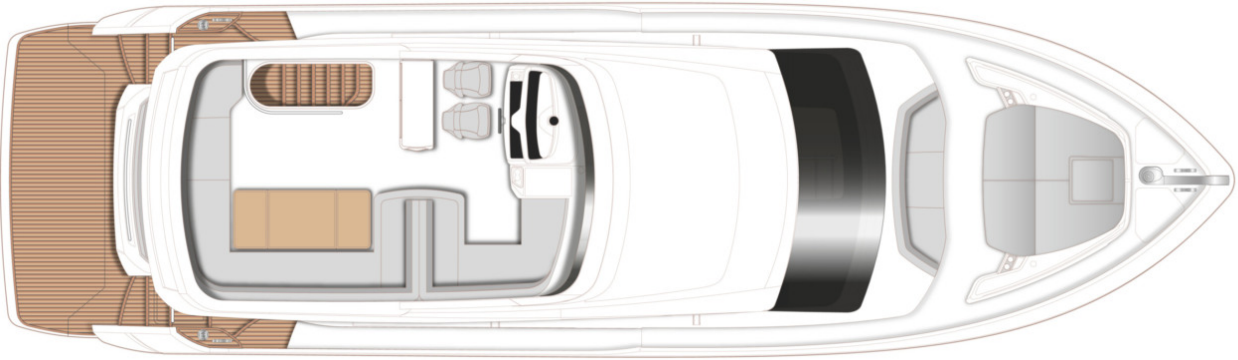

FLYBRIDGE

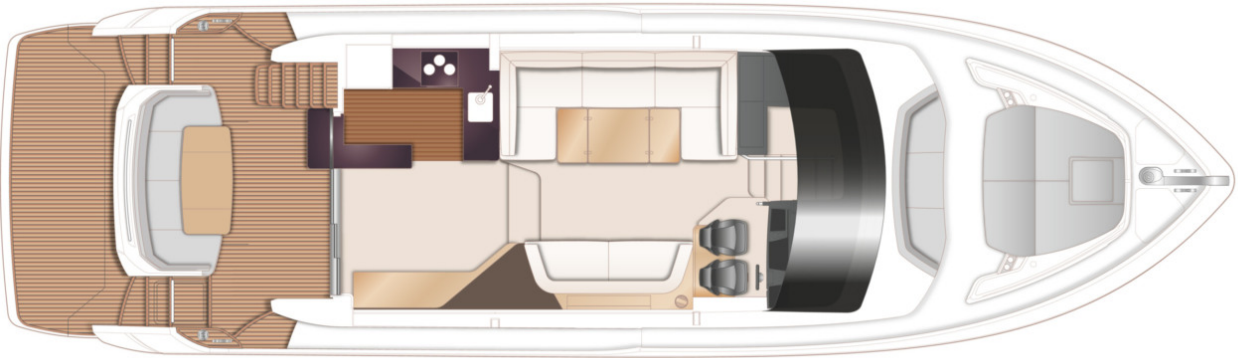

MAIN DECK

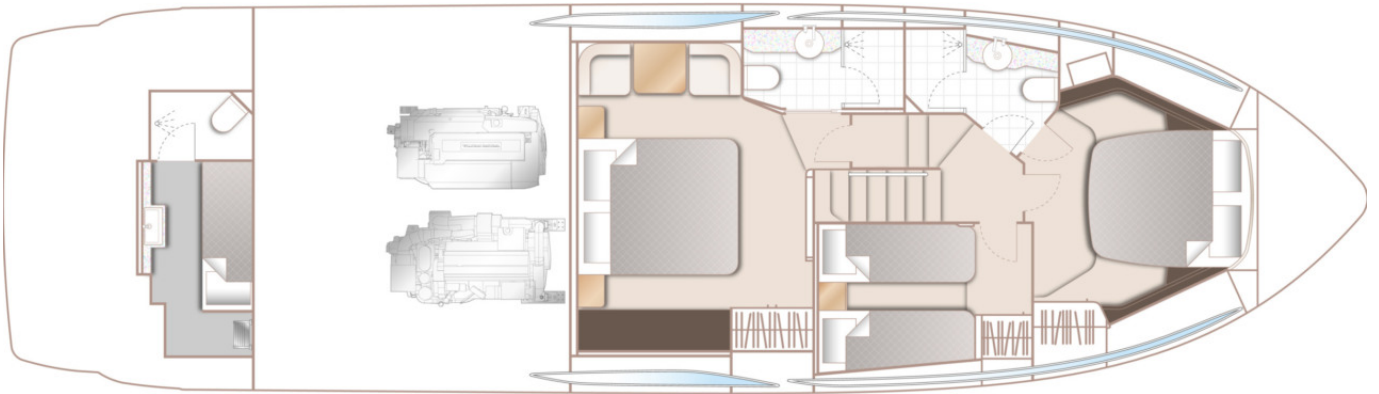

LOWER DECK
