

PRINCESS F55

1 600 000 € (inc VAT)



BROKERAGE

HIGHLIGHTS

/ LOW ENGINE HOURS
/ PERFECT CONDITION
/ 3 CABINS + 1 CREW
/ AC
/ 17.5 KW GENERATOR

/ ELECTRO-HYDRAULIC PLATFORM AND PASSARELLE
/ PREMIUM UPHOLSTERY
/ PREMIUM TV/AV EQUIPMENT
/ UPGRADED LIGHT PACKAGE

SPECIFICATIONS

Location	France, Antibes
Year	2019
Length	17.6 m
Beam	4.87 m
Draft	1.46 m
Displacement	25 tonnes
Fuel capacity	2750 l

Water capacity	608 l
Cabins	3+1
Engines	VOLVO PENTA
Max power	2 x 900 hp
Max speed	33 +
Engine hours	490 m/h
Price	1 600 000 € (inc VAT)

EQUIPMENT

Walnut interior wood Satin finish (galley floor is walnut as standard)
International VHF
Continental 200v/240v sockets
Aft Cabin fit out
Teak laid flybridge deck
Electro-hydraulic transom platform
Electro-hydraulic telescopic passerelle (2,9m) with automatic hand rails
Additional 20m of 10mm anchor chain to give a total of 60 meters
Onan 17,5 kw generator in place of standard
Dishwasher fitted in galley
Foredeck freshwasher anchor/deckwash system
Stern docking lights
Exterior Lightning Upgrade Package
Premium Audio System
Master stateroom 40" LED TV
Forward stateroom 32" LED TV
Garmin XHD colour radar with 24" kw Radome
Additional 16 Garmin installed to upper and lower helm
Garmin remote control keypad at the lowe helm position
Garmin AIS 800 Class B transponder
Foredeck seating in upgraded Comfort Exterior II Met

Airconditioning/heating reverse cycle (78,000 BTU) suitable for temperature to 40 grades (tropical)
Aft cabin air conditioning
Electric overboard discharge system in addition to standard to manual system
Aft cabin toilet to be connected into holding tank system
Electric stern rope handling winches (2)
Foredeck sunbedcushion(with adjustable headrest) in upgraded Comfort Exterior III Met
Reticulated foam for foredeck sunbeds
Reticulated foam for all standard exterior cockpit foredeck and flybridge seating/sunpads
Foredeck seating in Comfort Exterior III Vogue
Cockpit and flybridge upholstery including helms seats in upgraded Comfort Exterior III Vogue
Supply of scatter cushions
Stools for use at dinette in forward saloon area (2)
Quilts rectangular quilted blankets and headboards
Foredecking seating Comfort Exterior III Vogue
Bidet Shower
Supply Jabsco water pump
Supply additional lighting
Supply with mood lighting under saloon

ENGINES

2 x VOLVO PENTA 900 HP (490 hours)

EXTERIOR



INTERIOR

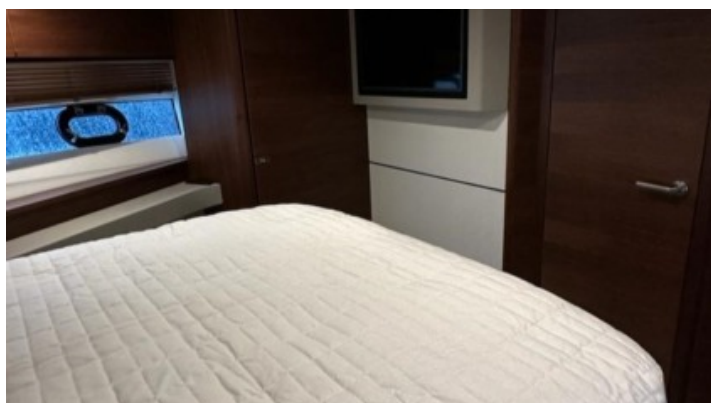

LAYOUTS

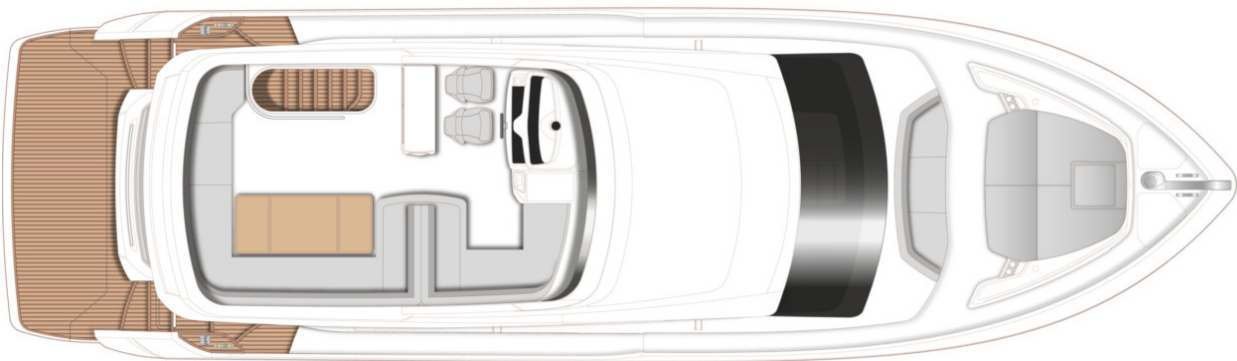

FLYBRIDGE

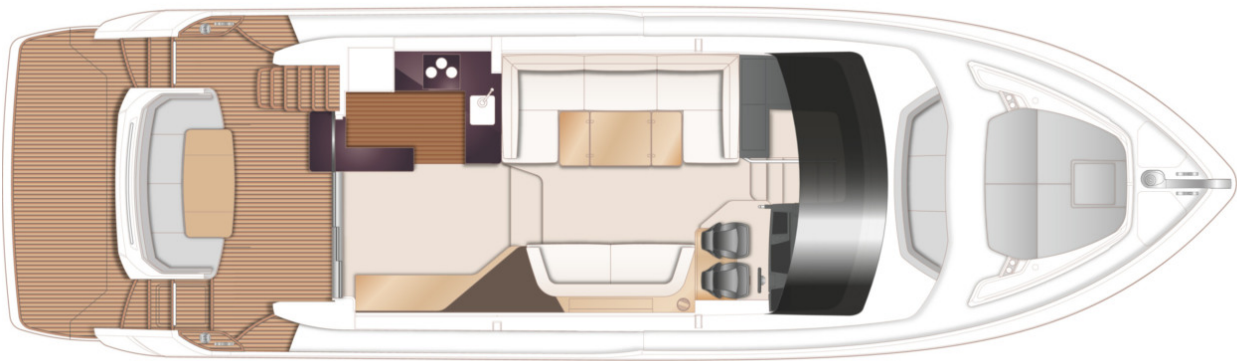

MAIN DECK

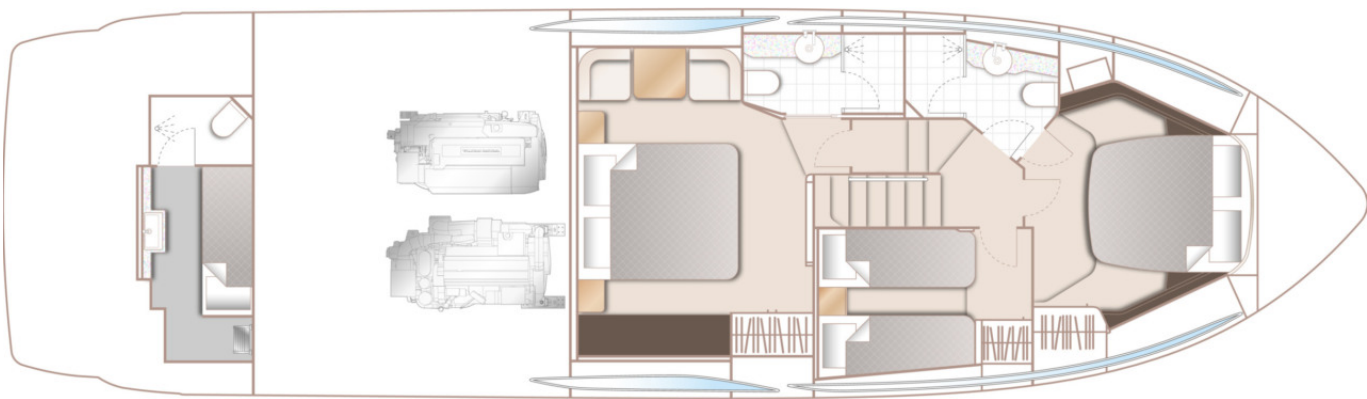

LOWER DECK

Yachts on the commission of Princess Yacht Monaco. The Company is not responsible for the accuracy of the information provided by the Shipowner (images used, yacht specifications, parameters, engine performance, legal design issues). The operating time of the engines is indicated at the time of preparation of the information and may change during further operation. The need for an inspection remains at the discretion of the Buyer. Exact parameters and characteristics can be specified in the contract of sale. Additional information is available from the manager on request.