

OCEAN CLASS 68

2 400 000 € (ex VAT)



HIGHLIGHTS

/ BRAND NEW CONDITION

SPECIFICATIONS

Location	Slovenia	Water capacity	1000 l
Year	2021	Cabins	3
Length	20.8 m	Berths	6
Beam	5.45 m	Engines	CAT 12.9
Draft	1.4 m	Max power	2 x 1 000 hp
Displacement	28 tonnes	Engine hours	Contact seller
Fuel capacity	4000 l	Price	2 400 000 € (ex VAT)

EQUIPMENT

Main deck	Large flybridge area is easily accessible from the cockpit via external teak steps and with watertight hatch (Port side)
Steel railing on side gunwales in polished stainless steel tube with teak capped railing	Upholstered driving bench with steering wheel to Port side
Tempered safety glass windows	Large upholstered U-shaped sofa with fixed table to Starboard side
Non-slip surfaces on side decks and bow area	Bar unit with built-in sink, locker and electric refrigerator, behind U-shaped sofa
Teak floor in the cockpit and swimming platform	Large upholstered sun tanning area forward from steering and L-shaped sofa
Fuel fillers, stainless steel (one on each side)	A radar arch with stainless steel holder for navigation lights and optional radar and antennas
Water filler, stainless steel	Navigation lights
Black water tanks discharge, stainless steel	Horn
Optional gray water tank discharge, stainless steel	Non-slip deck surfaces
Two shore power inlets, stainless steel, aft, 50A, with cable	Easy-grip handrails and railings all around
50 kg anchor with 100m of 12 mm chain	Front wind-breaking shield
Anchor windlass 24 V with brake and stainless steel protection	The helm console includes: <ul style="list-style-type: none">o Steering wheelo Main engine displayo Anchor windlass controlo Bilge visible alarmo Horn control
Anchor windlass control: handheld on bow, flybridge and pilothouse	Cover for helm console
A rope capstan on the windlass permits easy powered handling of the bow ropes in the harbor	Courtesy lights
Anchor chain and fender/rope storage with drain • Chain wash down in the bow anchor chain storage, fresh water, with hose	Flagpole with holder, stern
Bow seating area with a sun pad	Interior layout and equipment
Storage area under the sun pad and the sides	All wooden parts are fabricated of walnut veneered verticals, varnished with silk-gloss and darker laminate horizontals
2 electric windscreen wipers with freshwater wash system	Wood essence to owner preference on request Helm position, 2 steps above the lower salon area, Starboard side
6 stainless steel cleats • 4 stainless steel fairleads	Upholstered driving seat with steering wheel
Stainless steel grab rails on the bow area	Side door to starboard walking deck
Deck access door to the helm area from deck on Starboard side	The helm console includes:
Saloon door with tempered glass, three part	Steering wheel
2 electric capstans aft for handling of aft mooring lines with foot controls	Main engine display
A molded settee centrally in the aft part of the cockpit, upholstered	Anchor windlass control
A fixed teak table in front of the cockpit settee	Bilge visible alarm
Lights in cockpit ceiling and side decks	Magnetic compass with light o Switches for:
Courtesy lights around the cockpit and on the side decks	horn
2 x Stainless steel tubing stern gate leading to the swim platform	windscreen wipers
Steps on both sides for swim platform access	navigation lights
Shower with hot and cold water at the swim platform	bilge pumpsUSB socket
Stainless steel removable bathing ladder	
Fixed stern platform with side access from the pontoon	
Pantographic door to stern storage locker (toys, optional skipper cabin, etc.)	
A door from this storage locker to the engine room	
Flybridge	Navigation electronic to owner choice (optional)

Overhead lights	Full-beam cabin
Red night light	Double island bed with headboard and bedside night tables, with mattress
Carpeted floor	Storage space under the bed
To Port side of the helm position	Large hanging locker/wardrobe and shelves to Port and Starboard side
Large dinning settee with table to Port side	Office/dressing table with a seat at the entrance to the cabin
Courtesy lights • Ceiling lights	Drawers and lockers to Port side
Curtains	Sofa to Starboard side
Carpeted floor	Ceiling lights
Galley	Reading lights
Galley area to Starboard side	Courtesy lights
Storage cabinets and lockers	Space for optional entertainment system
Overhead lockers	Space for optional TV
Artificial marble worktop, faucet	Door to master's washroom
Induction hob with four burners	Carpets and curtains
Conventional oven	Two large non-opening hull glazing windows
Front-opening refrigerator	Master's washroom
Cutlery drawer crockery storage	Artificial marble countertop
Provision for optional dishwasher	Washbasin with single lever faucet
Worktop lights	Marine toilet, electric
Courtesy lights	Warm and cold water
Ceiling lights	Mirror and cabinets
Darker laminate floor and curtains	Bathroom accessories
Lower salon area	Portlight (opening)
Large sofa to Starboard side	A full size stand-in shower, small bench and with tampered glass door, electric pump-out –
Locker with 40" LCD TV and lifting mechanism to Port side	Ceiling lights
Place for optional small fridge or ice maker or wine locker to Port side	Darker laminate floor and curtains
Door with tempered glass, three part	VIP cabin, forward
Courtesy lights	Double island bed with headboard and bedside night tables, with mattress
Ceiling lights	2 drawer units under the bed
Carpeted floor	Wardrobe and shelves to Port and Starboard side
Curtains	Ceiling lights
Lower deck accommodation	Reading lights
Access via companionway steps to Port of the helm position	Courtesy lights
Corridor leads to: o Master cabin, aft o VIP cabin, forward o Guest cabin, Starboard side	Space for optional entertainment system
Large locker or space for optional washing/drying machine	Space for optional TV
Overhead lights	Carpeted floor and curtains
Courtesy lights	Two large none opening hull glazing windows
Master cabin	Door to VIP washroom

VIP washroom
Artificial marble countertop
Washbasin with single lever faucet
Marine toilet, electric
Warm and cold water
Mirror and cabinets
Bathroom accessories
Portlight (opening)
A full size stand-in shower, small bench and with tampered glass door, electric pump-out, fiberglass throughout
Ceiling lights
Darker laminate floor and curtains
Guest cabin to Starboard
2 single beds with headboard and middle bedside night table, with mattress
Locker space under the beds
Hanging locker and wardrobe/shelves forward
Mirror • Ceiling lights
Reading lights
Space for optional TV
Carpeted floor and curtains
Two portlights (opening)
Door to corridor
Guest cabin washroom
Artificial marble countertop
Washbasin with single lever faucet
Marine toilet, electric
Warm and cold water
Mirror and cabinets
Bathroom accessories
Portlight (opening)
A full size stand-in shower with tampered glass door, electric pump-out, fiberglass throughout
Ceiling lights
Darker laminate floor curtains
Optional aft skipper cabin, access from the stern platform area
1 single bed
Storage lockers
Ceiling light
Reading light
Separate compartment with electric marine toilet, washbasin and shower faucet

Two portlights to cockpit
Electrical system and equipment
The following voltages are used on board: 120V/240V AC, 24 V DC
The main control panels are installed at corridor/helm area
Generator: with water separator on exhaust system, in the engine room – 110V – ONAN 13.5 KW
A 24 to 220 V inverter/charger 2000 W
Shore power intakes, 2, aft
Batteries, AGM deep cycle, in battery boxes: <ul style="list-style-type: none">o Service battery bank (800 Ah)o Battery to start each engine (to match the engine requirements)o Battery to start the generator (to match the generator requirements)
Battery main switches, emergency paralleling
Bow thruster with own battery
Engine room blowers
Engine room lights
Air horn
Air conditioning in all cabins and saloon, reversed cycle, 64k BTU
Navigation lights
Tank gauges for fuel, water and black tank
220 V power points in all cabins, heads, galley and saloon
Bilge system
Four electric 24 V pumps
4 level alarms
2 manual emergency pumps
Fire fighting system
6 fire extinguishers
2 T-sensing automatic fire extinguishers in the engine room Fuel system
Stainless steel tank, capacity 4000 l
Electronic gauge in lower helm position
Optical fuel level gauge on tank with graduated scale
Fresh water system
Water tank, capacity 1000 l
Pressure pump 24 V
A 60 l boiler on engines and 110 V
Deck filler
Electronic level gauge
Space for optional water maker
Black water system

Accessories	
Boat hook	6 mooring lines
8 inflatable fenders	Owner's manual and engine manual

EXTERIOR



Yachts on the commission of Princess Yacht Monaco. The Company is not responsible for the accuracy of the information provided by the Shipowner (images used, yacht specifications, parameters, engine performance, legal design issues). The operating time of the engines is indicated at the time of preparation of the information and may change during further operation. The need for an inspection remains at the discretion of the Buyer. Exact parameters and characteristics can be specified in the contract of sale. Additional information is available from the manager on request.

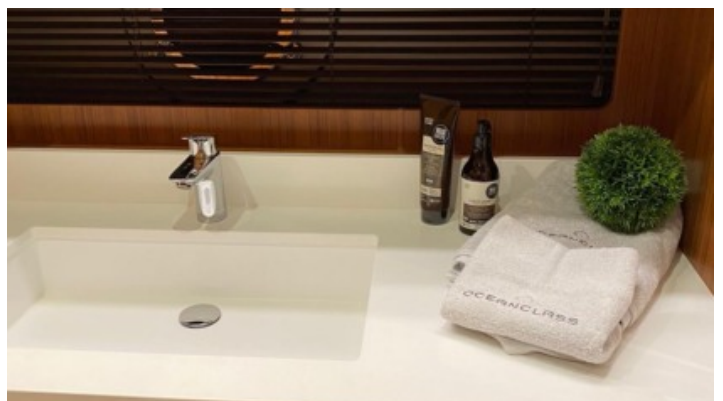

ble for the accuracy of the information provided by the Shipowner (images used, rating time of the engines is indicated at the time of preparation of the information at the discretion of the Buyer. Exact parameters and characteristics can be specified in the

LAYOUTS

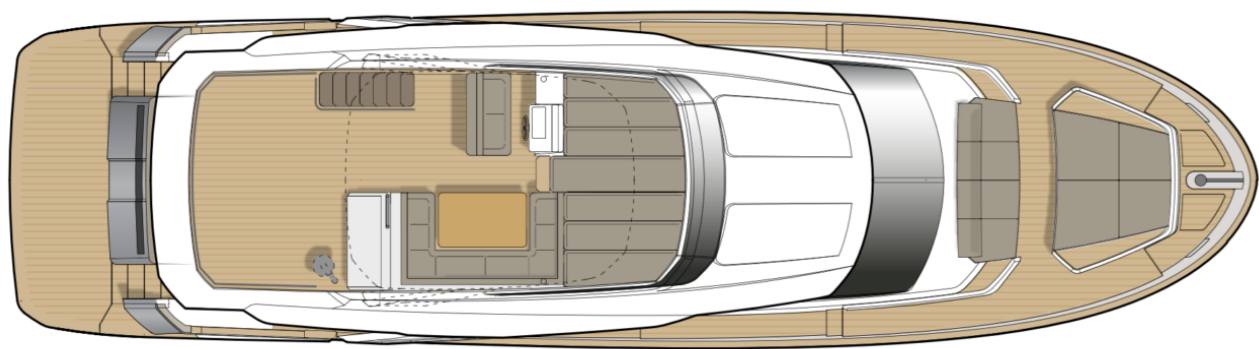

FLYBRIDGE

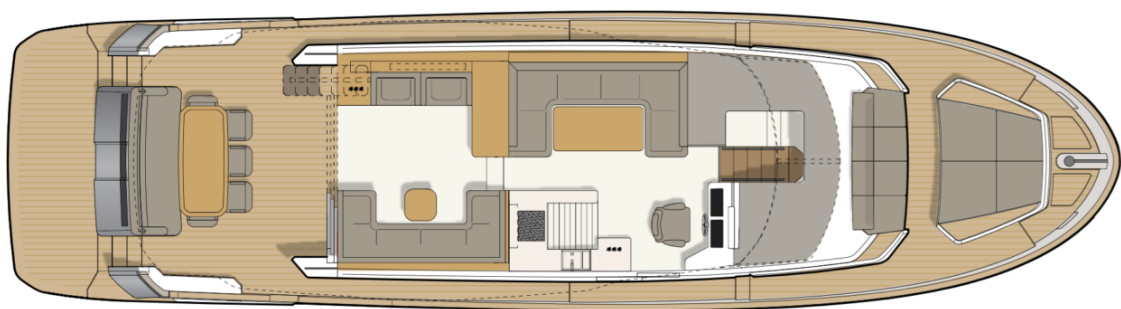

MAIN DECK

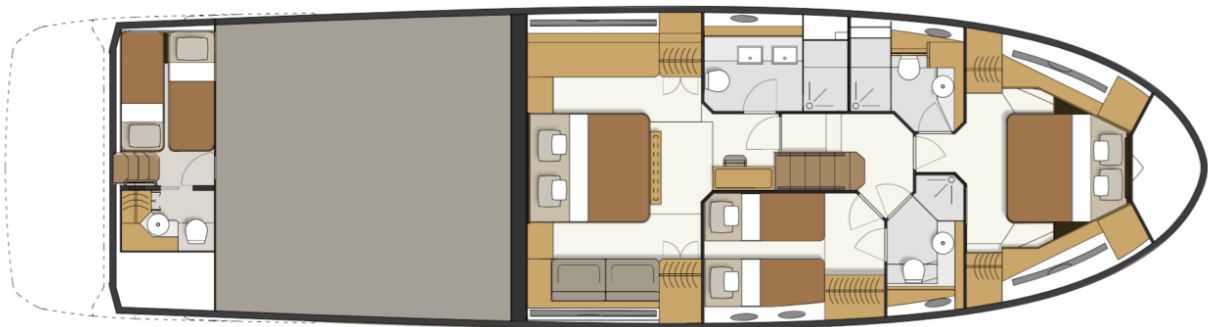

LOWER DECK

Yachts on the commission of Princess Yacht Monaco. The Company is not responsible for the accuracy of the information provided by the Shipowner (images used, yacht specifications, parameters, engine performance, legal design issues). The operating time of the engines is indicated at the time of preparation of the information and may change during further operation. The need for an inspection remains at the discretion of the Buyer. Exact parameters and characteristics can be specified in the contract of sale. Additional information is available from the manager on request.