

PRINCESS 60

880 000 € (ex VAT)



SOLD

SPECIFICATIONS

Location	Baltic
Year	2013
Length	18.61 m
Beam	4.83 m
Draft	1.27 m
Displacement	30.5 tonnes
Fuel capacity	2818 l
Water capacity	793 l

Cabins	3+1
Berths	6+2
Engines	2 x Volvo Penta
Max power	800 hp
Engine hours	900 m/h
Price	880 000 € (ex VAT)

EQUIPMENT

Hull colour: White
Walnut interior wood gloss finish Black tiled floors as standard
Copper Canyon galley worktop
Electrical Continental 220v/240v sockets
Aft cabin Fit out
Passerelle (letterbox type) with automatic handrails
Sternthruster (130 KgF)
Starboard cabin inboard berth to have electrically powered sliding mechanism to convert to double berth
Electric stern rope handling winches (2)
Additional 20m of 10mm anchor chain to give a total of 60 metres
Stainless steel anchor in place of standard (25kg)
Dishwasher in galley (drawer type - 6 place setting)
Foredeck freshwater anchor / deckwash system
ONAN 13.5 kW/ 50 Hz generator in place of standard
Raymarine e125 multifunction 12.1" brilliant colour display at upper helm
Fit teak to flybridge
Teak laid side decks
Premium audio system Incorporates:
Saloon - BOSE Lifestyle 48 DVD media system
Master Stateroom - BOSE 3.2.1 GS DVD media system linked to saloon Lifestyle 48 system
Flybridge - Waterproof speakers linked to saloon Lifestyle 48 system with separate remote control
iPOD docking station in saloon

Reverse cycle Air-conditioning system
Air-conditioning: AFT CABIN trunked from saloon
Windscreen demist system using warm air heater powered from calorifier
Refrigerator unit fitted above standard washer/dryer
Mosquito screens for portholes (5)
Mosquito screens for portholes FWD cabin (2)
Big Mosquito screens for portholes Master cabin (2)
Refrigerator unit fitted above standard washer/dryer
Mosquito screens for portholes (5)
Mosquito screens for portholes FWD cabin (2)
Big Mosquito screens for portholes Master cabin (2)
Vacuum Toilets (with holding tank)
Fit seacocks for later fresh water maker installation
Foredeck sunbed cushions in Movida
Metallic Beige
Cockpit & flybridge seating including helm seats and sunbed cushions - Movida Metallic, Colour : Beige Inlay Weiss
Additional charge for Quartz leather upholstery
Bimini Top - Dark Blue sunbrella canvas / Bimini top Dark Blue sunbrella
Additional charge for using of non standard fabrics in yacht interiors
All external covers are Dark Blue sunbrella



INTERIOR



LAYOUTS

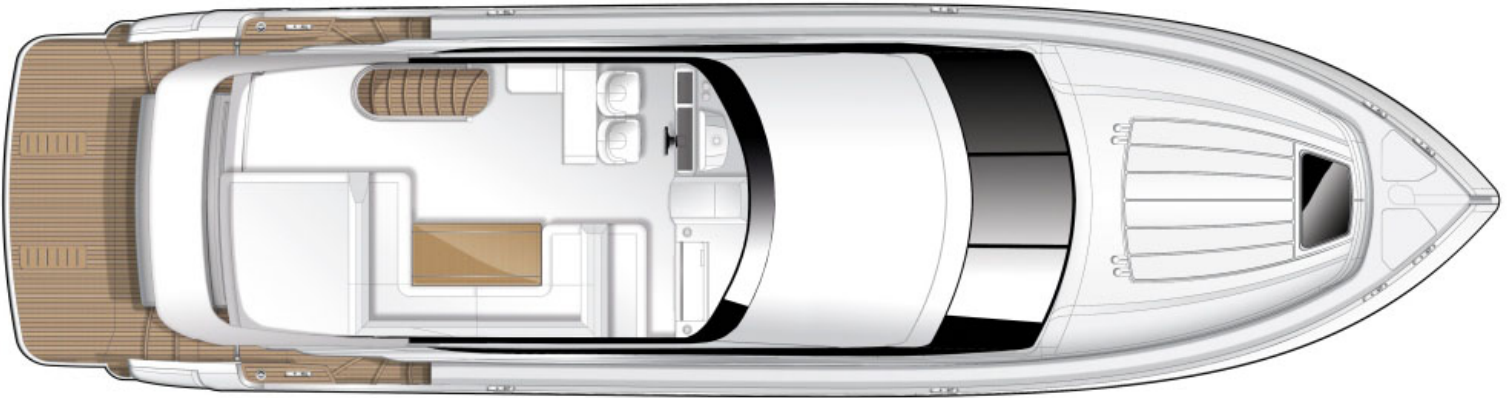

FLYBRIDGE

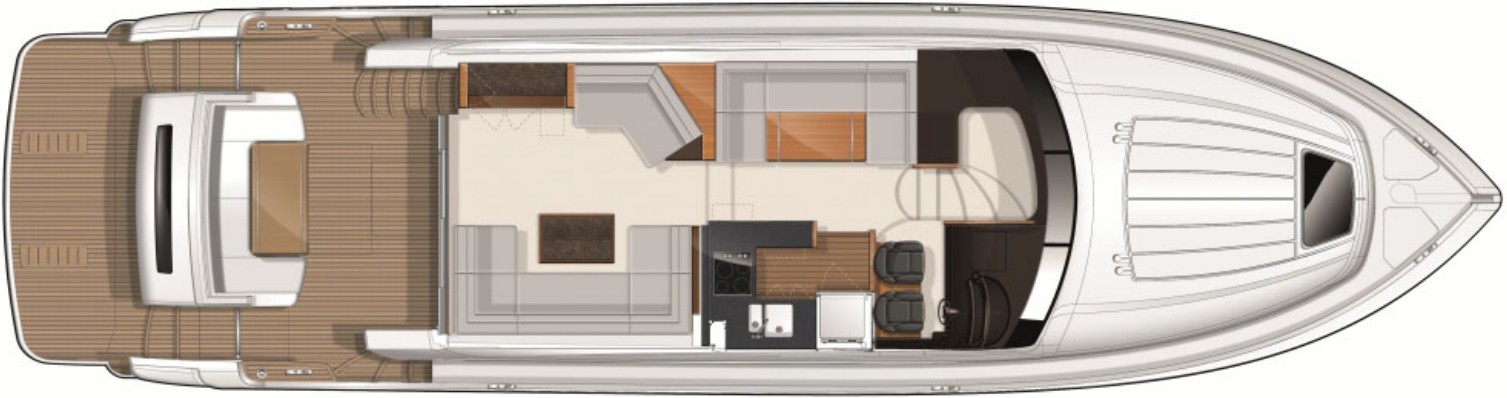

MAIN DECK



LOWER DECK
