

PRINCESS V39

Price on application



BROKERAGE

SPECIFICATIONS

Location	France, Fréjus
Year	2014
Length	12.5 m
Beam	3.8 m
Draft	0.56 m
Displacement	8.7 tonnes
Fuel capacity	730 l

Water capacity	332 l
Cabins	2
Berths	4
Engines	Volvo D6
Max power	2 x 330 hp
Engine hours	240 m/h
Price	Price on application

EQUIPMENT

HULL COLOUR

White hull with dark grey waterline

NAVIGATIONAL EQUIPMENT

Raymarine e125 Chart Plotter/GPS with external GPS & 12.1" colour multifunction display.

Raymarine p70R autopilot

International VHF

DECK EQUIPMENT

Electro-hydraulic telescopic passerelle (letterbox type and including folding handrails)

Transom platform with electro-hydraulic lift mechanism

Cockpit table with telescopic legs

Raised teak deck at helm position which folds below helm seat when not in use

Open bow pulpit

Full height cockpit cover in White Sunbrella with removeable side and back (on telescopic stainless steel frame and vertical supports). Top part acts as a sun awning when sides are removed

Foredeck sunbed cushions

Cockpit wetbar with electric BBQ grill and fridge

Cockpit speakers

Bimini

LED overhead lighting

Blue low level cockpit and bathing platform LED lights

SHIP'S SYSTEMS

Onan 4kW generator with Hydrohush exhaust system and sound shield)

Bowthruster (60Kgf)

Electro-hydraulic passerelle

Eberspacher heating

Electro-hydraulic transom platform

Continental 220v/240v sockets

System 2 holding tank

INTERIOR ARRANGEMENTS

Serotina Cherry interior wood, satin finish

Midnight black galley worktop

Loop Silver carpet

Ermine ultraleather sofa

Teak galley floor

2 cabins

Aft cabin twin with sliding double berth conversion

Bathroom with electric toilet, sink and shower

Sliding side window at helm position

INTERIOR EQUIPMENT

Ceramic electric hob (2 burner)

Mosquito screens to all portholes

Heat reflective blind to saloon overhead skylight

Black mesh windscreen covers

ENGINES

Volvo D6 (2 x 330 hp)

EXTERIOR



INTERIOR



LAYOUTS

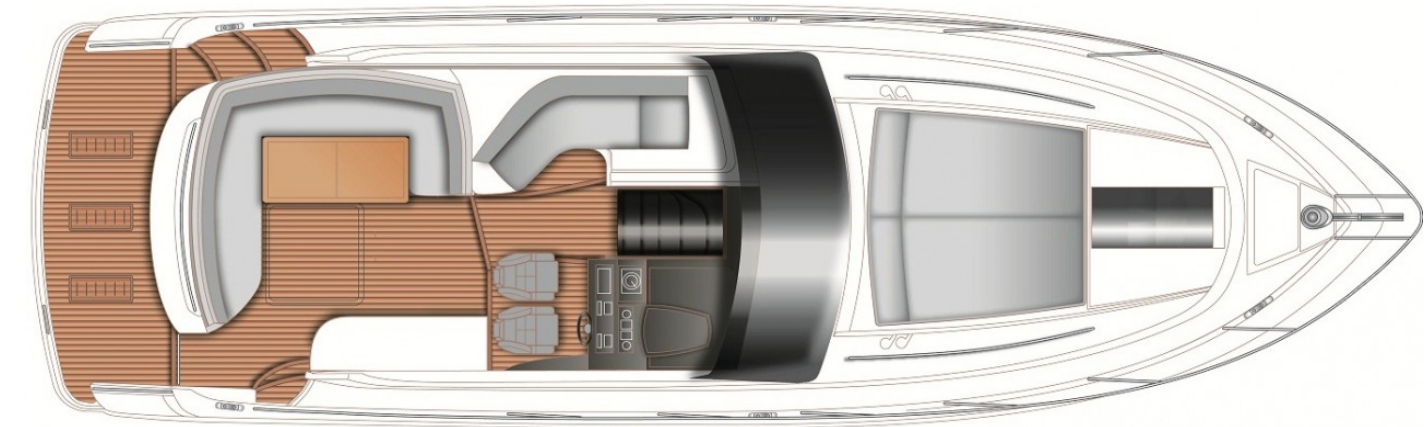

MAIN DECK

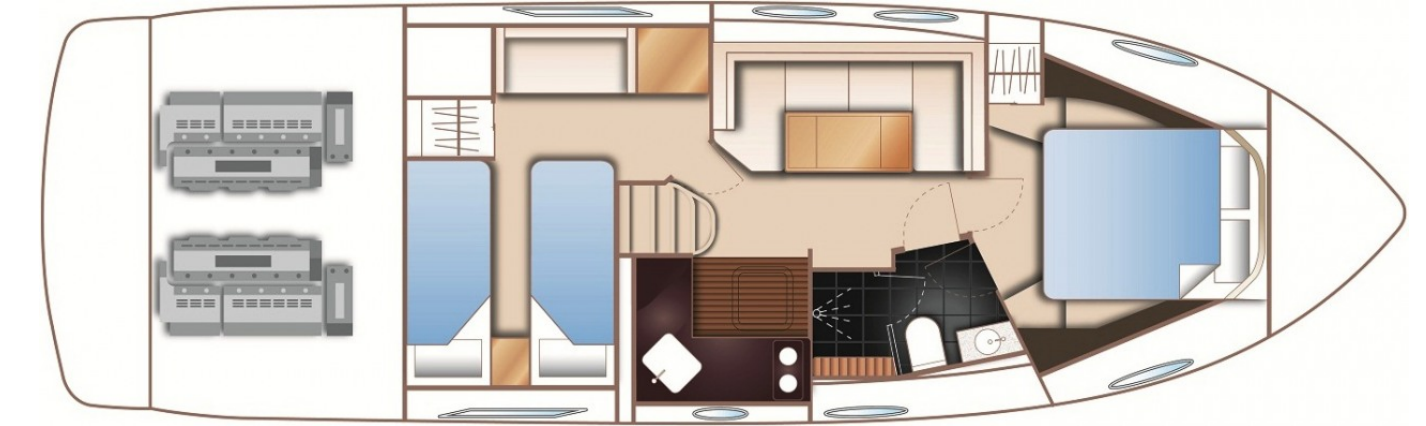

LOWER DECK
