

SANLORENZO 88

3 100 000 € (inc VAT)



HIGHLIGHTS

- / PERFECTLY MAINTAINED
  - / 4 CABIN LAYOUT
  - / WATERMAKER
  - / 2 GENERATORS
  - / HYDRAULIC GANGWAY
  - / ELECTRO-HYDRAULIC TRANSOM PLATFORM
- / TV/AV EQUIPPED
  - / ZERO SPEED STABILIZERS
  - / CCTV
  - / WILLIAMS TENDER
  - / RELIABLE CAT ENGINES

SPECIFICATIONS

Location	Monaco	Cabins	4
Year	2010	Berths	9
Length	26.75 m	Engines	Caterpillar C32 DITA
Beam	6.75 m	Max power	2 x 1902 hp
Draft	2.15 m	Max speed	28 +
Fuel capacity	12000 l	Engine hours	1200 m/h
Water capacity	3000 l	Price	3 100 000 € (inc VAT)

EQUIPMENT

Kohler generators, 1x33 kw + 1x27 kw
Condaria air conditioning
Hydraulic bow thruster
Hydraulic stern thruster
230 lt / h water maker
Retractable hydraulic gangway
Air compressor
Mitsubishi Zero Speed stabilizers
System Hamman black water purification
Infrared anti-intrusion system -
Fire -fighting system
Closed circuit TV system with cameras in the engine room and stern, monitor on the bridge,
GSM telephone
system - Mobile on flybridge with Miele electric plate, mini bar and sink
Electro-hydraulic crane on flybridge
Williams tender with hydrojet engine
Teak on the flybridge
Rigid bimini
Third maneuvering station aft
Underwater lights (6)
Two anchor winches with mooring bells and chain counter (fly and bridge)
Mooring winches aft
Mini Black communication satellite antenna
Satellite TV antenna
N. 7 LCD TV with 7 decoders, CD and DVD
LED lighting with dimmer
Miele coffee machine with built-in coffee grinder
Refrigerated wine cellar
Ice maker
Additional fridge / freezer
Miele washing machine and dryer ( professional)

Total winter and summer closure for the cockpit
Two Raymarine G170 monitors
Radar
Autopilot
GPS / plotter
Wind station
2 VHF
SSB
Ecosonde
On-board computer
Caterpillar engine control monitor
Intercom system

INTERIOR DESCRIPTION

Living room with “L” -shaped sofa, armchair and low table, opposing cabinet
Dining area with table and eight chairs
Daily service bathroom
Large kitchen with 75 cm induction hob, fridge / freezer column, double electric oven, microwave oven, dishwasher, waste compactor, crew dinette and ladder down to the crew
Raised wheelhouse with dinette.

LOWER DECK:

Owner cabin amidships with double bed, double bathroom with shower
A double cabin with twin beds + foldaway third bed, bathroom with shower
A double guest cabin currently used as an office, bathroom with shower
VIP cabin forward with double bed, bathroom with shower
Rosewood interiors, leather sofas, parquet flooring on the day deck
CREW:
Two double cabins with bunk beds, two bathrooms



EXTERIOR





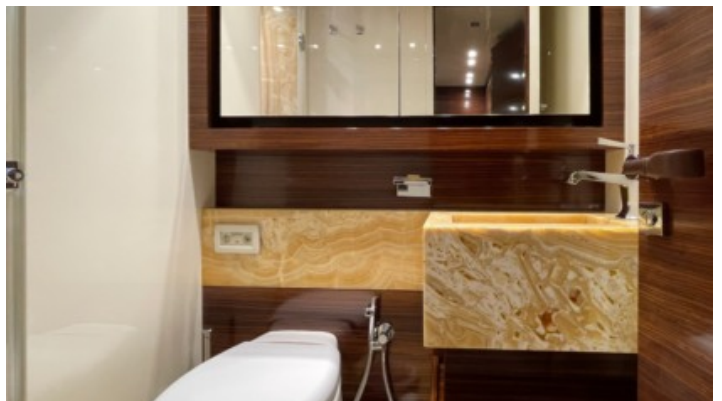



LAYOUTS

---

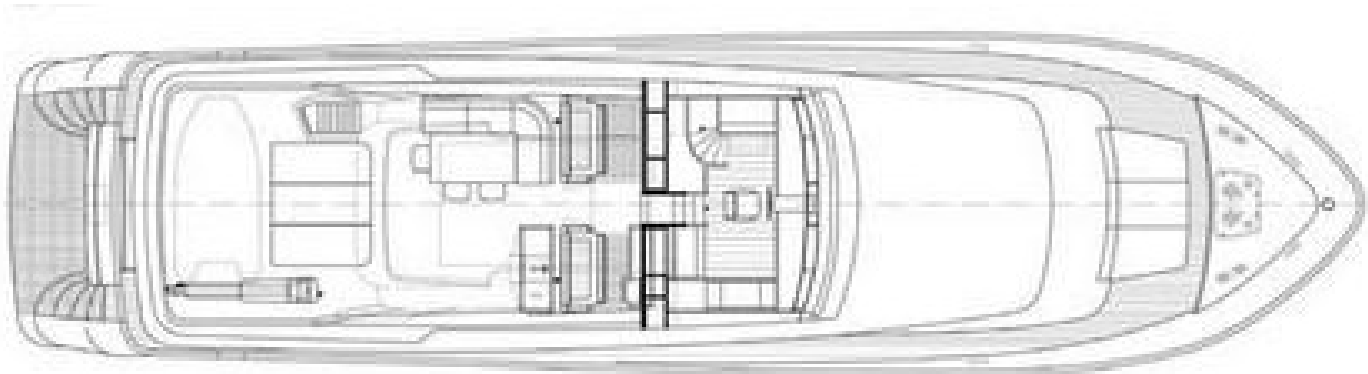

FLYBRIDGE

---

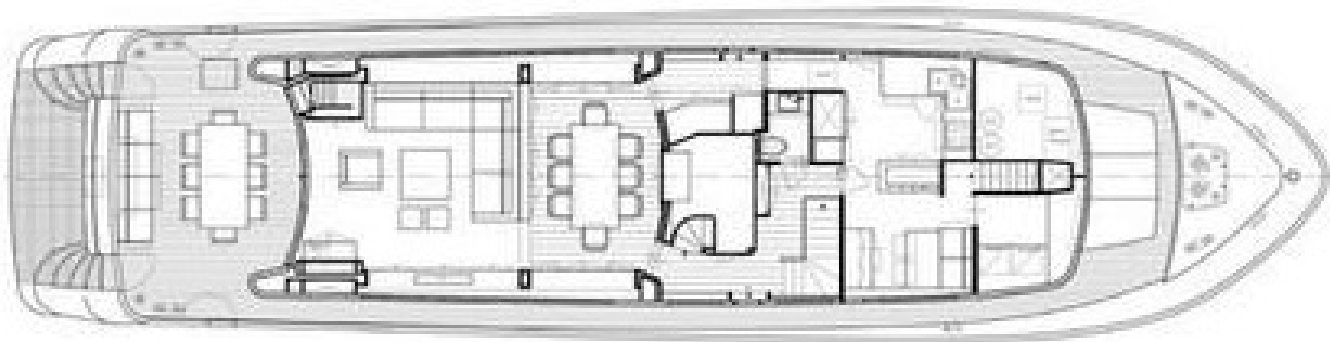

MAIN DECK

---



LOWER DECK

---