

## PRINCESS F60



SOLD

### SPECIFICATIONS

Localisation	Baltic	Cabines	3+1
Année	2013	Berths	6+2
Longueur	18.61 m	Moteurs	2 x Volvo Penta
Largeur	4.83 m	Puissance max	800 hp
Tirant d'eau	1.27 m	Engine hours	900 m/h
Déplacement	30.5 tonnes	Prix	880 000 € (ex VAT)
Capacité en carburant	2818 l		
Contenance en eau douce	793 l		

## EQUIPMENT

Hull colour: White

Walnut interior wood gloss finish Black tiled floors as standard

Copper Canyon galley worktop

Electrical Continental 220v/240v sockets

Aft cabin Fit out

Passerelle (letterbox type) with automatic handrails

Sternthruster (130 KgF)

Starboard cabin inboard berth to have electrically powered sliding mechanism to convert to double berth

Electric stern rope handling winches (2)

Additional 20m of 10mm anchor chain to give a total of 60 metres

Stainless steel anchor in place of standard (25kg)

Dishwasher in galley (drawer type - 6 place setting)

Foredeck freshwater anchor / deckwash system

ONAN 13.5 kW/ 50 Hz generator in place of standard

Raymarine e125 multifunction 12.1" brilliant colour display at upper helm

Fit teak to flybridge

Teak laid side decks

Premium audio system Incorporates:

Saloon - BOSE Lifestyle 48 DVD media system

Master Stateroom - BOSE 3.2.1 GS DVD media system linked to saloon Lifestyle 48 system

Flybridge - Waterproof speakers linked to saloon Lifestyle 48 system with separate remote control

iPOD docking station in saloon

Reverse cycle Air-conditioning system

Air-conditioning: AFT CABIN trunked from saloon

Windscreen demist system using warm air heater powered from calorifier

Refrigerator unit fitted above standard washer/dryer

Mosquito screens for portholes (5)

Mosquito screens for portholes FWD cabin (2)

Big Mosquito screens for portholes Master cabin (2)

Refrigerator unit fitted above standard washer/dryer

Mosquito screens for portholes (5)

Mosquito screens for portholes FWD cabin (2)

Big Mosquito screens for portholes Master cabin (2)

Vacuum Toilets (with holding tank)

Fit seacocks for later fresh water maker installation

Foredeck sunbed cushions in Movida

Metallic Beige

Cockpit & flybridge seating including helm seats and sunbed cushions - Movida Metallic, Colour : Beige Inlay Weiss

Additional charge for Quartz leather upholstery

Bimini Top - Dark Blue sunbrella canvas / Bimini top Dark Blue sunbrella

Additional charge for using of non standard fabrics in yacht interiors

All external covers are Dark Blue sunbrella

## EXTERIOR

---



## INTERIOR

---



# LAYOUTS

---



FLYBRIDGE

---

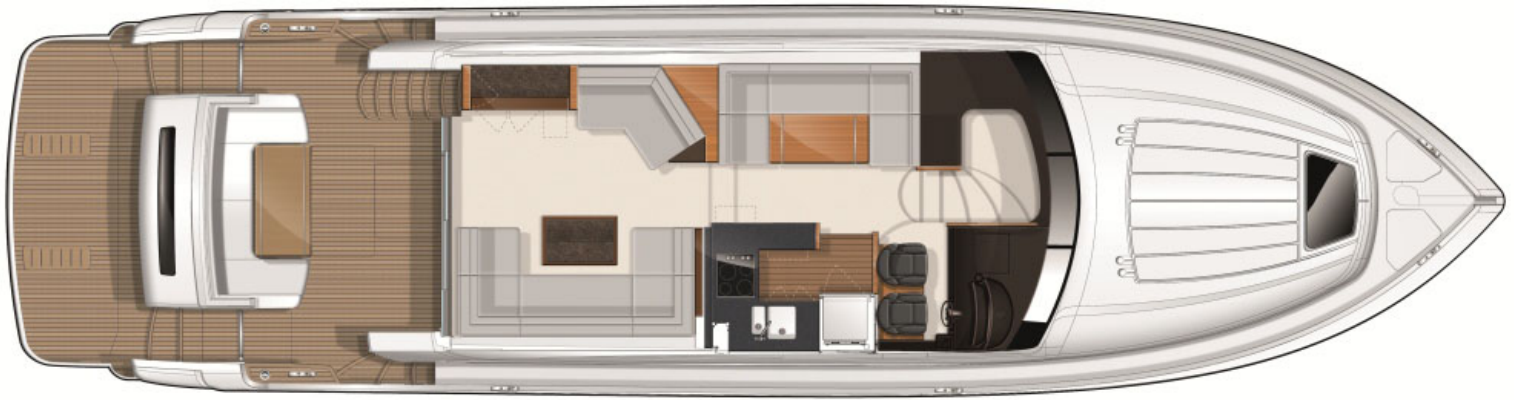

MAIN DECK

---



LOWER DECK

---