

PRINCESS 52



SOLD

HIGHLIGHTS

/ GREAT CONDITION

/ CREW CABIN

/ TENDER ZODIAC WITH
YAMAHA ENGINES

/ FULL OPTIONS

/ READY FOR DELIVERY

SPECIFICATIONS

Localisation	Monaco	Contenance en eau douce	608 l
Année	2015	Cabines	3+1
Longueur	16.66 m	Berths	6+2
Largeur	4.75 m	Moteurs	Volvo D11
Tirant d'eau	1.25 m	Puissance max	2 x 715 hp
Déplacement	24.6 tonnes	Engine hours	245 m/h
Capacité en carburant	2400 l	Prix	830 000 € (inc VAT)

















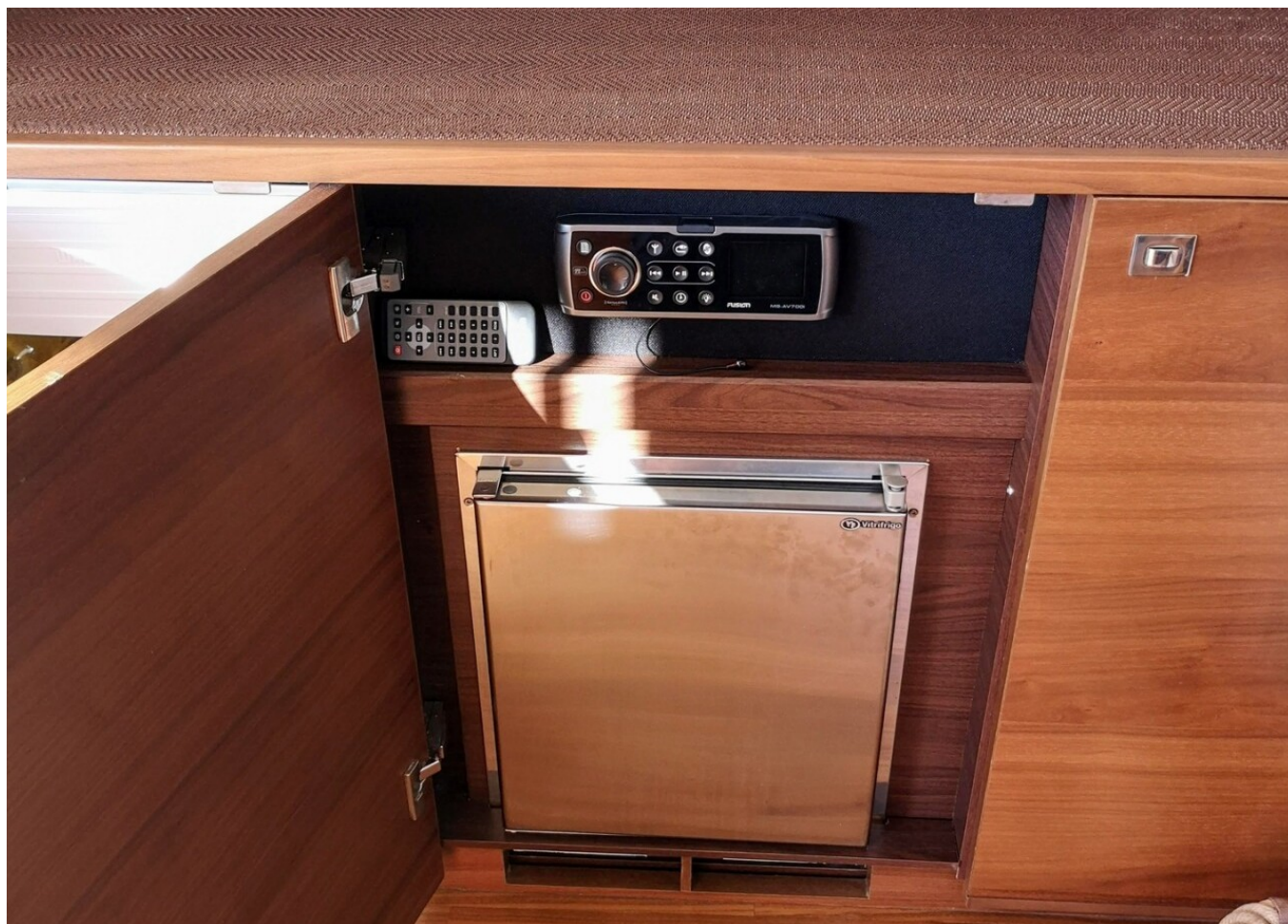



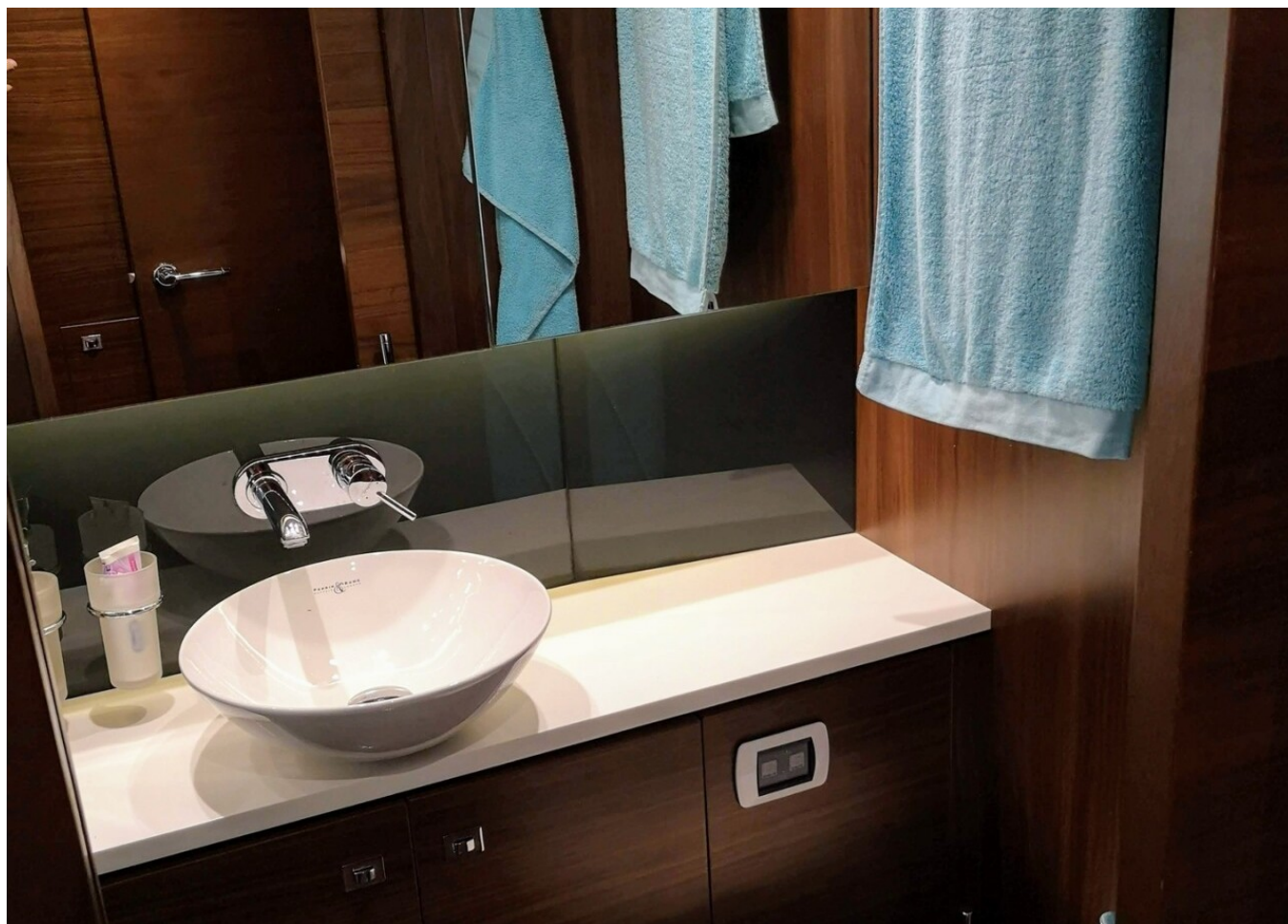

LAYOUTS

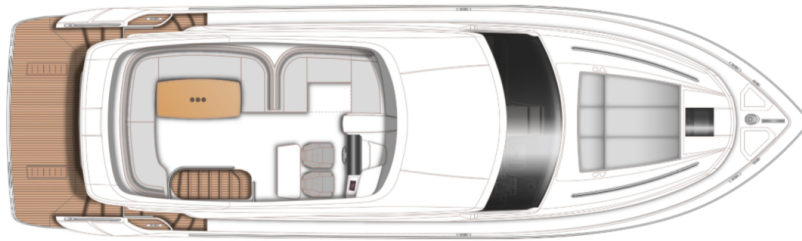

FLYBRIDGE

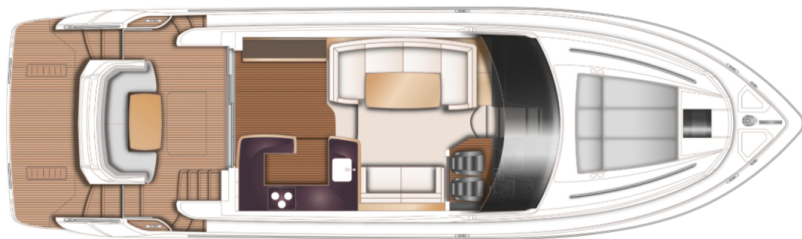

MAIN DECK

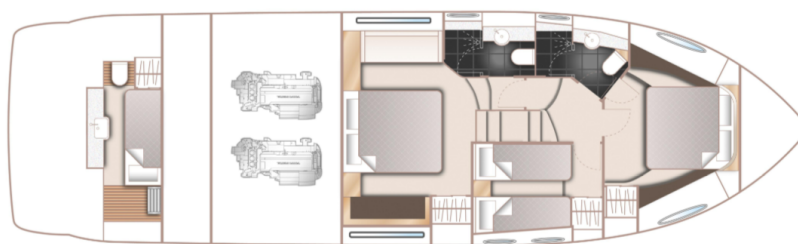

LOWER DECK

EQUIPMENT

White hull

Electro-hydraulic trim tabs with indicator at helm

Crew Cabin

Tender Zodiac with Yamaha engines

Serchlight with remote control

Dual station autopilot Raymarine

Dual station chartplotter/GPS Raymarine E125

Dual station log Raymarine

Dual station echo-sounder Raymarine

Dual station VHF Raymarine

Variable speed bow and stern thrusters

Generator Onan 11 Kw

Battery charger

220V/240V shore power

Electric Toilets with holding tanks

Airconditioning with reverse cycle in saloon and cabins (inc. crew cabin)

Combination microwave/conventional oven with grill

Icemaker

Dishwasher

Washing machine/dryer

Triple opening stainless steel framed saloon doors to aft cockpit

Electrically operated port starboard windows

Teak laid floor in saloon

Holding tank

Foredeck sunbed cushions

Cockpit cover

Electro-hydraulic telescopic gangway

Electric anchor winch

Stern rope mooring winches

Teak cockpit deck

Flybridge wet bar with refrigerator and electric barbecue

Transom door leading to bathing platform

Hot and cold transom shower

Cockpit table

Bimini top (not hydraulik)

Princess China , Princess glasses and cutlery

MOTEURS

Volvo Penta D11 2 x 715 hp

PRINCESS 52

+33 6 40 61 88 46 

m.st.pierre@princessyachtsmonaco.com

Follow Princess Yachts Monaco

