

## PRINCESS F55



SOLD

### HIGHLIGHTS

/ LOW ENGINE HOURS	/ PERFECT CONDITION	/ 3 CABINS + 1 CREW
/ AC	/ 17.5 KW GENERATOR	/ ELECTRO-HYDRAULIC PLATFORM AND PASSARELLE
/ PREMIUM UPHOLSTERY	/ PREMIUM TV/AV EQUIPMENT	/ UPGRADED LIGHT PACKAGE

### SPECIFICATIONS

Localisation	Antibes, France	Contenance en eau douce	608 l
Année	2019	Cabines	3+1
Longueur	17.6 m	Moteurs	VOLVO PENTA
Largeur	4.87 m	Puissance max	2 x 900 hp
Tirant d'eau	1.46 m	Vitesse max	33
Déplacement	25 tonnes	Engine hours	490 m/h
Capacité en carburant	2750 l	Prix	1 600 000 € (inc VAT)

The yacht is on the commission of Princess Yacht Monaco. The Company is not responsible for the accuracy of the information provided by the Yacht owner (images, specification, parameters, engine performance, legal, etc). The operating time of the engines is indicated at the time of preparation of the information and may change during further operation. The need for an inspection remains at the discretion of the Buyer. Exact parameters and characteristics can be specified in the contract of sale. Additional information is available upon request.



























# LAYOUTS

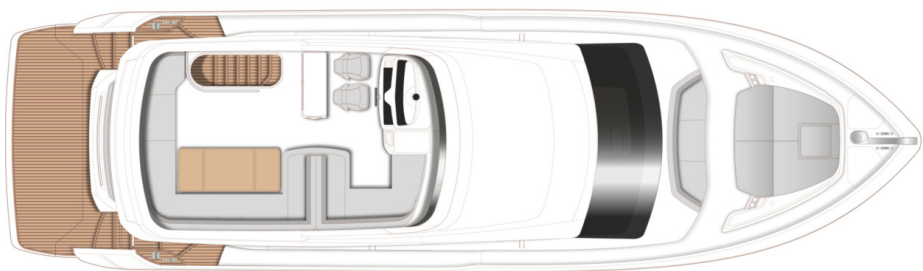

FLYBRIDGE

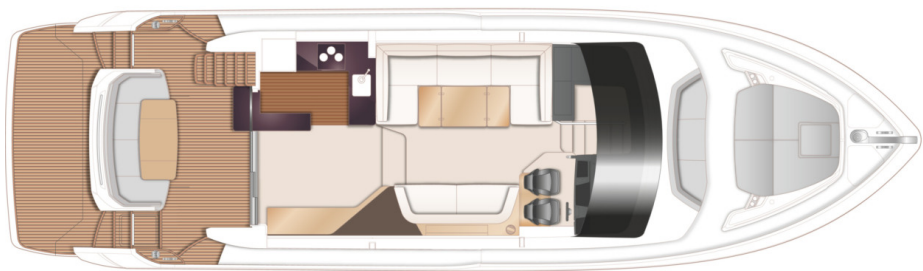

MAIN DECK

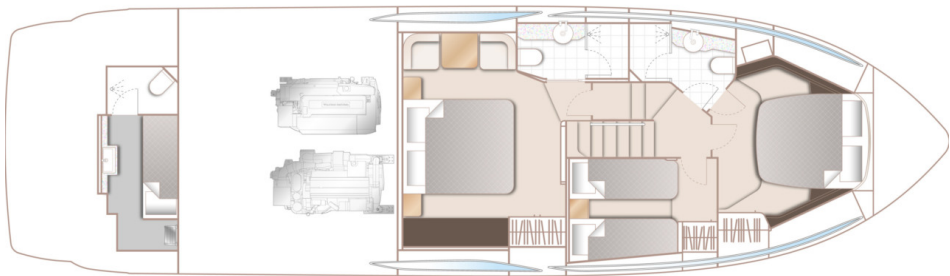

LOWER DECK

# EQUIPMENT

Walnut interior wood Satin finish (galley floor is walnut as standard)

Continental 200v/240v sockets

Teak laid flybridge deck

Electro-hydraulic telescopic passerelle (2,9m) with automatic hand rails

Onan 17,5 kw generator in place of standard

Foredeck freshwasher anchor/deckwash system

Exterior Lightning Upgrade Package

Master stateroom 40" LED TV

International VHF

Aft Cabin fit out

Electro-hydraulic transom platform

Additional 20m of 10mm anchor chain to give a total of 60 meters

Dishwasher fitted in galley

Stern docking lights

Premium Audio System

Forward stateroom 32" LED TV



Garmin XHD colour radar with 24" kw Radome	Additional 16 Garmin installed to upper and lower helm
Garmin remote control keypad at the lower helm position	Garmin AIS 800 Class B transponder
Foredeck seating in upgraded Comfort Exterior II Met	Airconditioning/heating reverse cycle (78,000 BTU) suitable for temperature to 40 grades (tropical)
Aft cabin air conditioning	Electric overboard discharge system in addition to standard manual system
Aft cabin toilet to be connected into holding tank system	Electric stern rope handling winches (2)
Foredeck sunbed cushion (with adjustable headrest) in upgraded Comfort Exterior III Met	Reticulated foam for foredeck sunbeds
Reticulated foam for all standard exterior cockpit foredeck and flybridge seating/sunpads	Foredeck seating in Comfort Exterior III Vogue
Cockpit and flybridge upholstery including helms seats in upgraded Comfort Exterior III Vogue	Supply of scatter cushions
Stools for use at dinette in forward saloon area (2)	Quilts rectangular quilted blankets and headboards
Foredecking seating Comfort Exterior III Vogue	Bidet Shower
Supply Jabsco water pump	Supply additional lighting
Supply with mood lighting under saloon	

## PRINCESS F55

+33 6 40 61 88 46 

[m.st.pierre@princessyachtsmonaco.com](mailto:m.st.pierre@princessyachtsmonaco.com)

---

Follow Princess Yachts Monaco

