

PRINCESS F60 (018)



SOLD

HIGHLIGHTS

/ SATELLITE INTERNET
/ CREW CABIN FIT OUT
/ WATERMAKER

/ GENERATOR ONAN 13,5 KW
/ TELESCOPIC GANGWAY

SPECIFICATIONS

Localisation	Croatia	Cabines	3+1
Année	2012	Berths	6+2
Longueur	18.61 m	Moteurs	Volvo Penta D13
Largeur	4.83 m	Puissance max	2 x 800 hp
Tirant d'eau	1.27 m	Vitesse max	33 +
Déplacement	30.5 tonnes	Engine hours	750 m/h
Capacité en carburant	2818 l	Prix	790 000 € (ex VAT)
Contenance en eau douce	793 l	Flag	Jersey

EQUIPMENT

Hull colour: Midnight Blue to 1" above boot topping line

Interior furniture: T.B.A.

Lower Helm seats to be Brown leather

Aztec Brown galley worktop avonite

Electrical Continental 220v/240v sockets

Aft cabin fit out

Stern thruster

Electric stern rope handling winches (2)

Additional 20m of 1 Omm anchor chain to give a total of 60 m

Fit dishwasher in galley

Foredeck freshwater anchor/deckwash

Onan 13,5 Kw generator in place of standard Onan 9,5 Kw

Raymarine C120W multifunctional 12" display at upper helm

Fit teak to flybridge

PREMIUM AUDIO SYSTEM Incorporates:

Saloon - BOSE Lifestyle 48 DVD media system; Master Stateroom - BOSE 3.2.1 GS DVD media system linked to saloon Lifestyle 48 system;

Flybridge - Waterproof speakers linked to saloon Lifestyle 48 system with separate remote control.

Fit additional pair of Infinity speakers in cockpit linked to head Bose system 48 with separate remote control

Fit optional 32" LCD TV SHARP in saloon in place of standard

Reverse cycle Air-conditioning system

Air-conditioning: AFT CABIN trunked from saloon

Windscreen demist system using warm air heater powered from calorifier

System 2 : (Aft Cabln)

Fresh water maker 156 liters per hour

Bimini Top - Dark Blue Canvas/acrylic

Additional charge for all external covers are blue in place of standard white

Standard leather upholstery

Set of the rescue equipment

Supply x 8 Mosquito screens for fitting to portholes

Large oval mosquito screens for Master cabin x 2

Foredeck sunbed cushions in Movida Metallac Beige

Supply 12 fender socks - Navy Blue with Princess Logo

1 Kg Hull/Superstructure gelcoat

Additional fenders with ropes x 4

Spare set anodes

Supply 5 liters of engine oil

MOTEURS

Volvo D13-800 (2 x 800 hp)

Engine hours: 750 m/h

EXTERIOR



INTERIOR



LAYOUTS



FLYBRIDGE

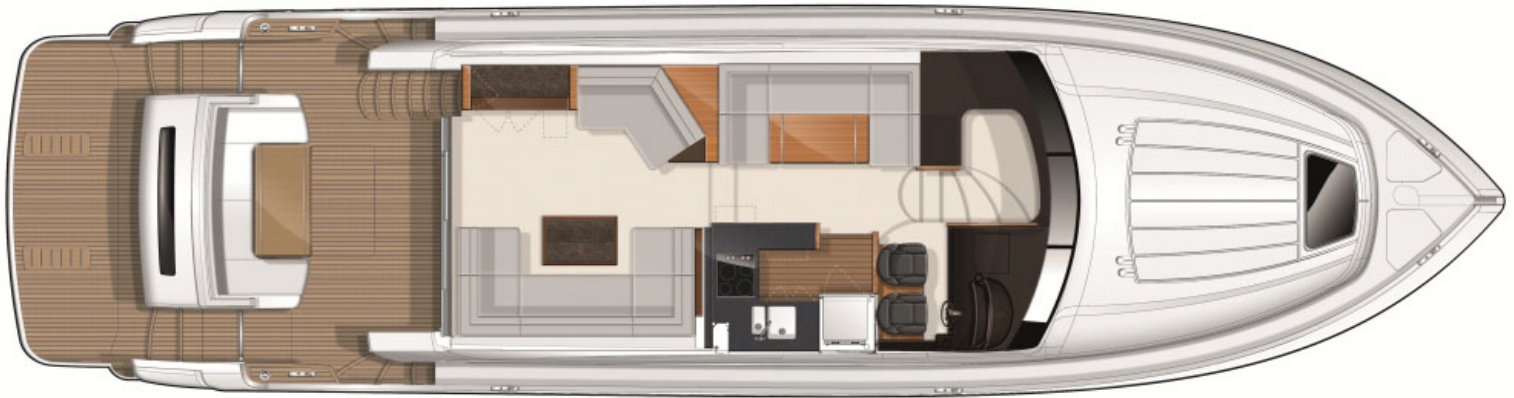

MAIN DECK



LOWER DECK
