

## 2025 PRINCESS S80



BEST VALUE ON THE MARKET

### HIGHLIGHTS

- / BRAND NEW BUILD
- / SEAKEEPER 26 STABILISER
- / TENDER GARAGE
- / VAST SOCIABLE COCKPIT
- / 4 GUEST CABINS WITH EN-SUITES
- / WATERMAKER
- / FULL UPGRADE PACKAGE

### SPECIFICATIONS

Localisation	Antibes, France	Contenance en eau douce	1400 l
Année	2025	Cabines	4
Longueur	25.4 m	Berths	8
Largeur	6.06 m	Moteurs	2
Tirant d'eau	1.78 m	Puissance max	2x MAN V12-2000 hp
Déplacement	66 tonnes	Engine hours	100 m/h
Capacité en carburant	7000 l	Prix	5 500 000 £ (ex VAT)

The yacht is on the commission of Princess Yacht Monaco. The Company is not responsible for the accuracy of the information provided by the Yacht owner (images, specification, parameters, engine performance, legal, etc). The operating time of the engines is indicated at the time of preparation of the information and may change during further operation. The need for an inspection remains at the discretion of the Buyer. Exact parameters and characteristics can be specified in the contract of sale. Additional information is available upon request.





































































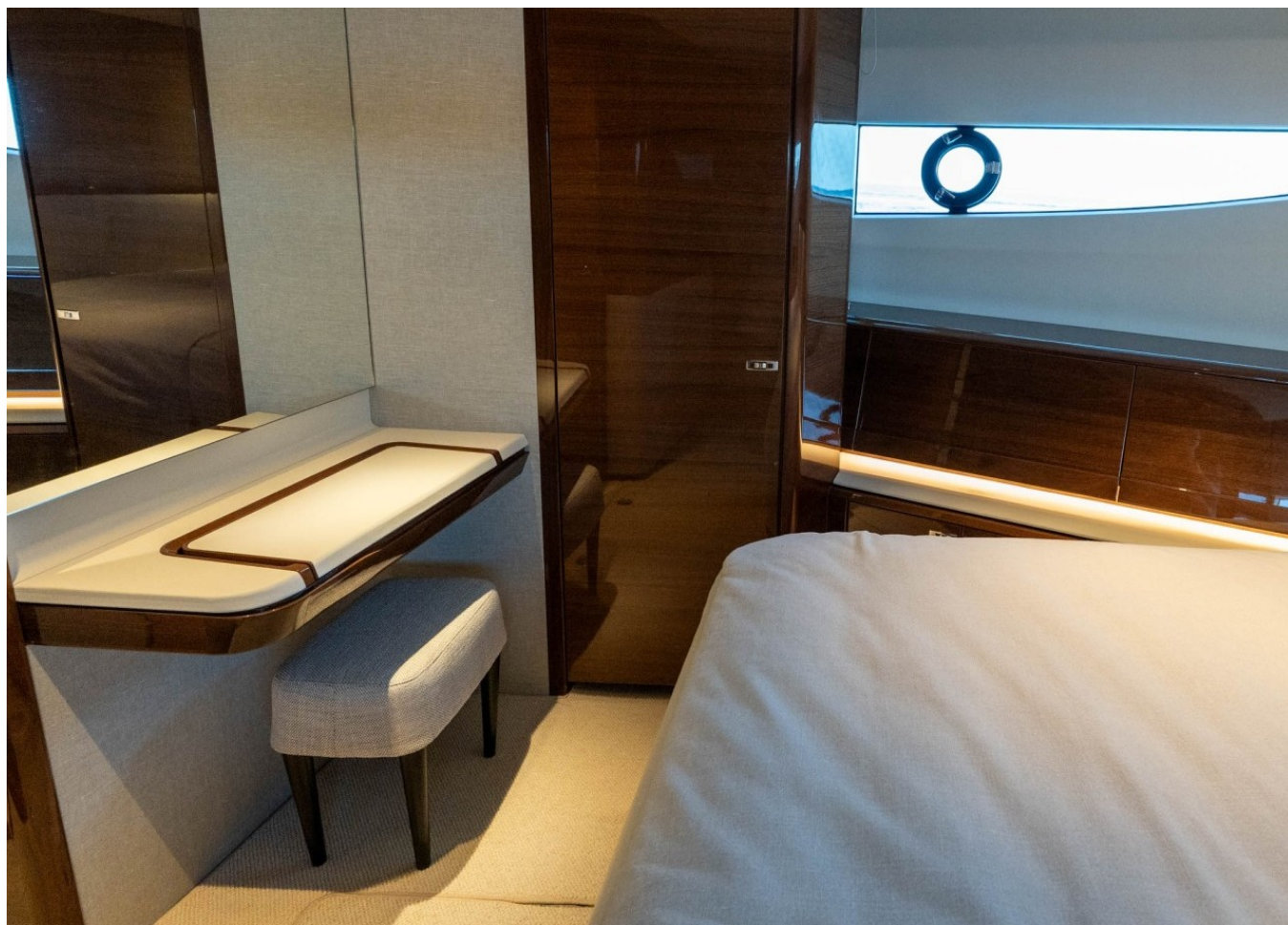























## LAYOUTS

---

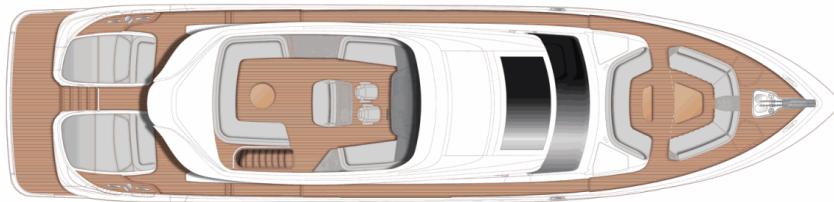

### FLYBRIDGE

---



### MAIN DECK

---

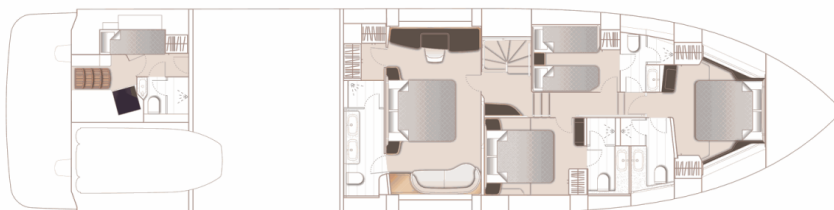

### LOWER DECK

---

## EQUIPMENT

---

### ACCOMMODATION

Teak (6mm) decking to transom platform,

Crew quarters to have sink, fridge and



transom steps, cockpit deck, stairway to sportbridge, side decks, foredeck & sportbridge;

---

Walnut interior wood gloss finish (galley floor, step to lower helm and lower helm floor are V-groove planked walnut as standard);

---

Main deck living area (saloon seating) floors to be in Vgroove planked timber (wood type same as galley floor), in place of standard carpet;

---

Up/down electro hydraulic transom platform with 550Kg SWL fitted as standard (maximum recommended tender weight is 430kg) ;

---

HYDRAULICS: Standard system comprises of separate engine driven hydraulic pumps allowing any system to be supplied with hydraulic power from either engine. Including hydraulic anchor winch and 340kgF hydraulic bow thruster and hold function docking system. All with dual station controls;

---

Tender garage suitable for up to a Williams Sportjet 435

---

Raymarine Axiom XL 16 Radar/Chartplotter with GPS and 3x 16" (15.6" display size) brilliant colour multifunction displays (two at lower helm with RMK-10 remote control & one at sportbridge helm).

- Raymarine Cyclone radar (55w pedestal with 4' open array scanner)
  - Raymarine p70Rs autopilot with rate gyro and i70s colour multifunction instruments
- 

2x Böning screens (one at each helm position)

---

Digital boat alarms

---

Lighting controls

---

AC/DC control & monitoring

---

Reverse Cycle Air Conditioning/heating (162,000 BTU fan capacity with 144,000 BTU chiller capacity)

---

Raymarine 90 Dual Station VHF

---

Continental 220v/240v sockets

---

microwave;

---

Shadow Pack – Elevate the styling of all bathrooms on board (excluding crew when selected) with the signature S & V Class Shadow Pack, a collection that adds modern black brightware and slate grey furniture units to all bathrooms

---

Feature shower bulkheads and shower floor in Solid Surface (to match Solid Surface floor), in place of standard synthetic teak accents;

---

Electrically operated sun awning to aft end of cockpit in anthracite grey mesh;

---

Additional 50m, per side, of 14mm galvanised anchor chain – one 150 m attached to 80 kg anchor & second 120m attached to 50 kg anchor

---

Plug in carbon pole transom shower and deck socket to transom;

---

2 x Kohler 28kW/50Hz generators (upgrade)

---

Three Phase shore support inlet (380v-415v / 42kVa @50Hz) in addition to the existing 2 x 63A single phase inlets;

---

Additional Power sockets (deck saloon, galley & all cabins, including crew quarters). Qi wireless chargers to sportbridge & main deck foredeck seating;

---

CCTV system with pan/tilt/zoom camera in aft cockpit and two fixed cameras in engine room, displayed on sportbridge and lower helm displays;

---

Dial in CCTV system with recording facility

---

Additional CCTV cameras

---

Freshwater maker (190L/h)

---

Combination washer/dryer machine located in guest lobby area under stairs

---

Electric roman blinds in place of manual venetian blinds in Master stateroom;

---

Electric sheer roller blind in Master stateroom



Exterior covers in grey colour	outboard of electric roman blind
8 place setting of china, cutlery & glasse<	Electric sheer roller blinds to all main deck living area windows (excl. wheelhouse, day head area and patio door)
Joystick control AVENTICS system	
Wing station (third) controls in port side cockpit buttress	AGM 90Ah batteries in place of standard (for start, domestic & generator batteries);
Hydraulic stern thruster (320kgF);	Cockpit servery 100L drawer fridge;
Gyro stabilisation (1x Seakeeper 26) controlled via the MFD screens;	Raymarine AIS Class B transponder interfaced with chart plotter;
Sliding doors to enclose lower helm and create wheelhouse (including full height bulkhead aft of lower helm)	Mosquito screens for portlights;
2x fixed bar stools in front of galley counter top;	Grey water tank (1,400 litres), in addition to standard black water tank (grey water to take waste water from sinks/shower, washing machine and dishwasher)
Combination toilet/bidet to Master Stateroom en-suite;	Reticulated foam to all fixed exterior cushions
Forward cabin to have bilge level dry storage space, accessed through a hatch in forward cabin floor, including access ladder. Interior finish is white gel with white laminate shelving;	Cockpit privacy screen;
Port cabin to have double berth conversion with powered sliding mechanism on inboard berth;	

## KEY FEATURES

4 spacious en-suite guest cabins:	Starboard twin cabin
Full-beam master suite	Well-appointed crew accommodation with private access and dedicated amenities
Forward VIP	
Port cabin with convertible sliding berths	Expansive main deck with vast cockpit dining area, open-plan saloon, sociable galley with breakfast bar, and panoramic windows
	Tender garage and bathing platform enabling easy launch of a Williams Sportjet 435

## ENTERTAINMENT and COMFORT

Joystick Control Aventics system for effortless	CCTV system with pan/tilt/zoom cockpit camera, fixed engine room cameras, and
---	---



docking	remote access
Gyro stabilisation – Seakeeper 26 for ultimate comfort at anchor and underway	Hydraulic bow & stern thrusters with hold function docking system
Sliding doors to enclose lower helm and create a private wheelhouse for full crew privacy	Two Kohler 28 kW generators (upgrade)
Fully equipped crew quarters for 2	Comprehensive Raymarine navigation suite with triple 16’ multifunction displays, Cyclone radar, AIS, and autopilot
Styling upgrades including Shadow Pack for a refined, modern interior finish	Reverse-cycle air conditioning (162,000 BTU)
Electrically operated sun awning to aft cockpit	Watermaker (190 L/h)



## 2025 PRINCESS S80

+33 6 40 61 88 46 

[m.st.pierre@princessyachtsmonaco.com](mailto:m.st.pierre@princessyachtsmonaco.com)

---

Follow Princess Yachts Monaco

