

PRINCESS X95



STOCK

HIGHLIGHTS

/ AVAILABLE IN STOCK

SPECIFICATIONS

Localisation	After request	Contenance en eau douce	1805 l
Année	2025	Cabines	4
Longueur	21.11 m	Moteurs	2 x MAN V12
Largeur	6.71 m	Puissance max	2 x 1900 hp
Tirant d'eau	2.03 m	Vitesse max	26 knots
Déplacement	104 tonnes	Engine hours	Contact seller
Capacité en carburant	13816 l	Prix	10 232 200 £ (ex VAT)



















LAYOUTS

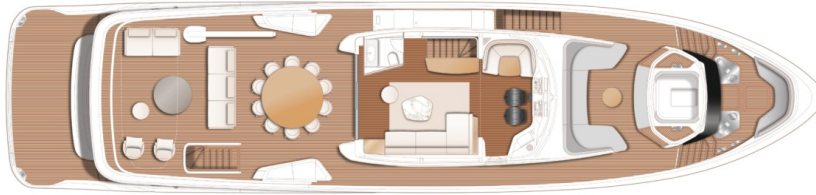

FLYBRIDGE



MAIN DECK

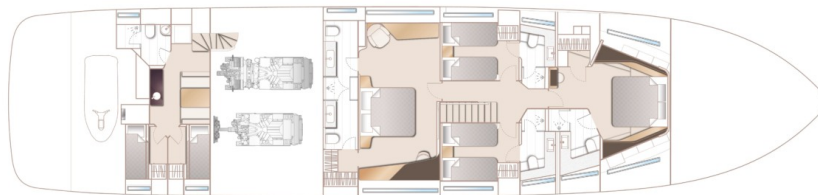

LOWER DECK

EQUIPMENT

ENGINES & DRIVE

Wing station controls on starboard side of flybridge coaming (engine controls, thruster controls, follow on tiller (steering input control) and engine emergency stops)

STABILISATION

Sleipner Hydraulic system (consisting of separate engine driven hydraulic pumps on each engine with cross connections allowing any system to be supplied with hydraulic power from either engine) and incorporating

SPS93/VF1950 vector fin stabiliser system.
When underway fins are driven by engine powered hydraulic motors or by a generator powered electric motor when the main engines are turned off

INTERIOR FURNITURE

Walnut interior wood – satin finish (standard layout – open galley and forward dining floors are V groove planked Walnut as standard. Skylounge (with inlaid rug) and wheelhouse floors are in V groove planked Walnut as standard)

Main deck Saloon and forward lounge/optional bar area floors to be in V groove planked wood with inlaid rug* in aft saloon area (wood type same as standard open galley and dining area)

DECK HARDWARE

Side entry gates to aft port & starboard side decks in addition to standard passerelle

Mooring package with leather fender saddles (x8 accommodates one side of the hull)

Cockpit servery unit, incorporating drawer fridge, sink, top loading coolbox and storage

Twin stainless-steel kedge anchors with 100m of 14mm galvanised chain in place of standard

An additional 2 x 50 metres of 14mm anchor chain to make 150 metres on each side (galvanised)

Flybridge port side bar unit included in outboard sideboard with 2 electric griddle type barbeques, drawer refrigerator, sink and waste bin

Flybridge starboard unit included in outboard sideboard to be fitted with top loading cool box and icemaker

Electric aft awning fitted to upper deck

Plug in carbon pole transom shower and deck socket to bathing platform

Flybridge port side GRP storage box (fits between skylounge and outboard rails)

GENERATOR

Upgrade to two ONAN 50 kW/50Hz generators to be fitted in place of standard

ELECTRICAL

Multi sockets, in place of standard sockets (throughout craft) * please note that as these sockets will take various plug types, it is the customers' responsibility to ensure that the appliance being plugged in matches the boats operating voltage. PYL cannot be held liable for equipment damage that results from a

Miele Professional washing machine and tumble dryer fitted in crew area (50Hz)

Underwater transom lights (4 Lumishore THX 803 full colour, interfaced with Radar/Chartplotter MFD's)

Underwater lighting to aft hull sides (8

mismatch of voltages

AGM 90Ah batteries in place of standard (for start, domestic and generator batteries)

Wine cooler (34 bottles) fitted in saloon sideboard

High impact mini dome anchor pocket camera (one for each anchor)

Additional CCTV cameras (each) - please specify location (maximum of 5 cameras in addition to the 3 standard cameras as below) (Note: Standard CCTV system includes 2x fixed cameras in engine room and 1x fixed pan/tilt aft cockpit camera)

Spot Zero combined watermaker and water purification system (190l/hr) - Purifies seawater and dockside water by removing dissolved solids

Underfloor heating in bathrooms (MAIN DECK MASTER, LOWER DECK MASTER, FORWARD CABINS)

Lumishore THX 803 full colour, interfaced with Radar/Chartplotter MFD's - 4 per side)

Electric sheer roller blind in place of manual in Lower deck Master stateroom outboard of standard electric roman blind

Forward Cabin - Additional electric sheer roller blind to outboard of standard electric roman blind

Electric curtains to aft patio and port and starboard full height windows in place of standard

Electric curtains to Sky lounge aft patio door in place of standard

AUDIO VISUAL & COMMUNICATIONS

Crew mess/ Optional Beach Club (when fitted) TV & Audio Package 32" LED TV, Naim Uniti Atom audio system with Bluetooth, multizone streaming* capability and dedicated app. Paired with Focal speakers

PREMIUM AUDIO UPGRADE : (does not include Crew mess/ optional Beach Club - please select separate option) Incorporates:

Deck Saloon - 65" LED TV on a power lift. Naim Uniti Star audio system - Stream your music in high-resolution, play, backup your CDs, store and access your music library or tune in to your favourite radio stations via DAB & FM radio.

Access a world of music with a host of streaming* and media sources with intuitive app enabled features. Paired with upgraded Focal speakers and subwoofer.

Owner's Stateroom - 55" LED TV, Naim Uniti Atom audio system with Bluetooth, multi-zone streaming* capability and dedicated app. Paired with upgraded Focal speakers and subwoofer.

Dummy KVH dome (89cm) x 2

Forward Stateroom 43' LED TV, Naim Uniti Atom audio system with Bluetooth, multizone streaming* capability and dedicated app. Paired with upgraded Focal speakers and subwoofer.

Starboard guest cabin 24' LED TV, Naim Uniti Atom audio system with Bluetooth, multizone streaming* capability and dedicated app. Paired with Focal speakers

Port guest cabin 24' LED TV, Naim Uniti Atom audio system with Bluetooth, multizone streaming* capability and dedicated app. Paired with Focal speakers

NAVIGATION

Raymarine Cyclone Pro Radar, 110W pedestal with 6' open array scanner in place of standard

Raymarine AIS Class B transponder interfaced with chartplotters

Additional Raymarine Cyclone Radar, 55W pedestal with 4' open array scanner

International VHF

European version plotter

MOSQUITO SCREENS

Mosquito screens for portlights

EXTERIOR UPHOLSTERY / CANVAS / COVERS

Reticulated foam to all standard exterior cockpit and foredeck fixed furniture (loose furniture items on the sundeck and loose cockpit chairs, if selected, are not included)

Cockpit privacy screen

SHIPPING

Handover Preparation Pack

SEA DELIVERY

FUEL: Fill with fuel (13,400 litres)

Supply 5 litre container of engine oil

Ecoworks for Princess – complete boat, sustainable cleaning solution. Including all concentrated products – washdown, engine, rib, teak deck, bilge, glass, all surface, laundry,

fabric, washroom & heads cleaners, sanitiser,
fog buster, wood & wax varnish, washingup
liquid, trigger spray bottles (x4) and jute
storage bag

PRINCESS X95

+33 6 40 61 88 46 

m.st.pierre@princessyachtsmonaco.com

Follow Princess Yachts Monaco

