

2010 SANLORENZO 88



BROKERAGE

HIGHLIGHTS

- / PERFECTLY MAINTAINED / 4 CABIN LAYOUT / WATERMAKER
- / 2 GENERATORS / HYDRAULIC GANGWAY / ELECTRO-HYDRAULIC
TRANSOM PLATFORM
- / TV/AV EQUIPPED / ZERO SPEED STABILIZERS / CCTV
- / WILLIAMS TENDER / RELIABLE CAT ENGINES

SPECIFICATIONS

| | | | |
|-------------------------|---------|---------------|-----------------------|
| Localisation | Monaco | Cabines | 4 |
| Année | 2010 | Berths | 9 |
| Longueur | 26.75 m | Moteurs | Caterpillar C32 DITA |
| Largeur | 6.75 m | Puissance max | 2 x 1902 hp |
| Tirant d'eau | 2.15 m | Vitesse max | 28 |
| Capacité en carburant | 12000 l | Engine hours | 1200 m/h |
| Contenance en eau douce | 3000 l | Prix | 2 600 000 € (inc VAT) |

The yacht is on the commission of Princess Yacht Monaco. The Company is not responsible for the accuracy of the information provided by the Yacht owner (images, specification, parameters, engine performance, legal, etc). The operating time of the engines is indicated at the time of preparation of the information and may change during further operation. The need for an inspection remains at the discretion of the Buyer. Exact parameters and characteristics can be specified in the contract of sale. Additional information is available upon request.



















LAYOUTS

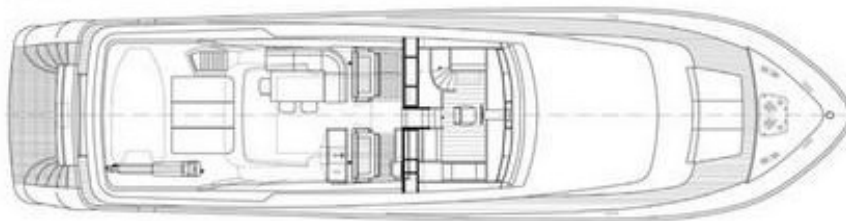

FLYBRIDGE

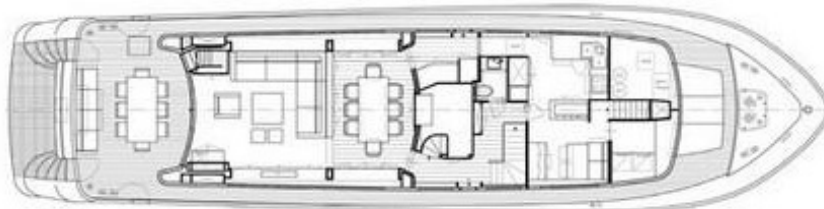

MAIN DECK



LOWER DECK

EQUIPMENT

Kohler generators, 1×33 kw + 1×27 kw

Hydraulic bow thruster

230 lt / h water maker

Air compressor

System Hamman black water purification

Fire -fighting system

GSM telephone

Electro-hydraulic crane on flybridge

Teak on the flybridge

Third maneuvering station aft

Two anchor winches with mooring bells and

Condaria air conditioning

Hydraulic stern thruster

Retractable hydraulic gangway

Mitsubishi Zero Speed stabilizers

Infrared anti-intrusion system -

Closed circuit TV system with cameras in the engine room and stern, monitor on the bridge,

system - Mobile on flybridge with Miele electric plate, mini bar and sink

Williams tender with hydrojet engine

Rigid bimini

Underwater lights (6)

Mooring winches aft

chain counter (fly and bridge)

Mini Black communication satellite antenna

N. 7 LCD TV with 7 decoders, CD and DVD

Miele coffee machine with built-in coffee grinder

Ice maker

Miele washing machine and dryer (professional)

Two Raymarine G170 monitors

Autopilot

Wind station

SSB

On-board computer

Intercom system

Living room with “L” -shaped sofa, armchair and low table, opposing cabinet

Daily service bathroom

microwave oven, dishwasher, waste compactor, crew dinette and ladder down to the crew

LOWER DECK:

A double cabin with twin beds + foldaway third bed, bathroom with shower

VIP cabin forward with double bed, bathroom with shower

CREW:

Satellite TV antenna

LED lighting with dimmer

Refrigerated wine cellar

Additional fridge / freezer

Total winter and summer closure for the cockpit

Radar

GPS / plotter

2 VHF

Ecosonde

Caterpillar engine control monitor

INTERIOR DESCRIPTION

Dining area with table and eight chairs

Large kitchen with 75 cm induction hob, fridge / freezer column, double electric oven,

Raised wheelhouse with dinette.

Owner cabin amidships with double bed, double bathroom with shower

A double guest cabin currently used as an office, bathroom with shower

Rosewood interiors, leather sofas, parquet flooring on the day deck

Two double cabins with bunk beds, two bathrooms

2010 SANLORENZO 88

+33 6 40 61 88 46 

m.st.pierre@princessyachtsmonaco.com

Follow Princess Yachts Monaco

