

PRINCESS 52



SOLD

SPECIFICATIONS

Posizione	Poole, United Kingdom	Capacità acqua	605 l
Anno	2014	Cabine	3+1
Lunghezza	16.8 m	Berths	6+1
Larghezza	4.6 m	Motorizzazione	2 x Volvo D11 Diesel
Pescaggio	1.25 m	Max potenza	725 hp
Peso	24.6 tonnes	Engine hours	70 m/h
Capacità carburante	2400 l	Prezzo	820 000 € (ex VAT)























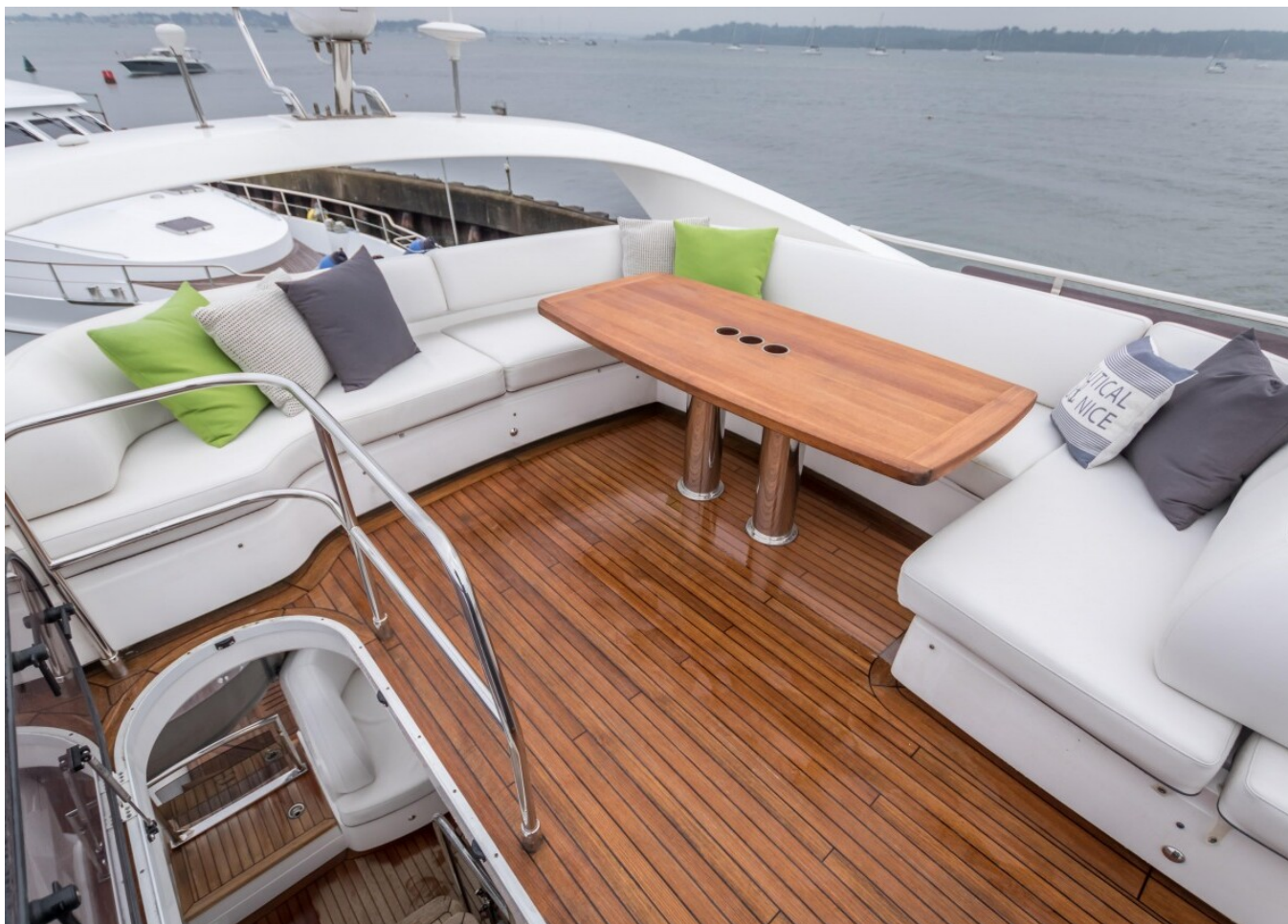

LAYOUTS

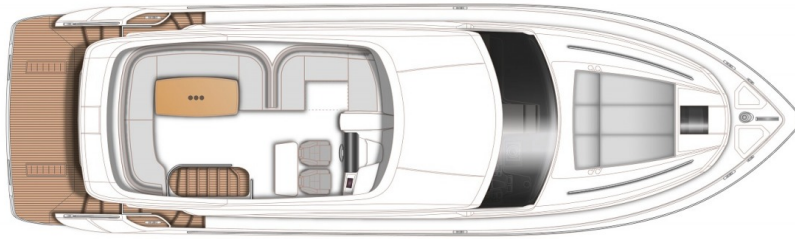

FLYBRIDGE

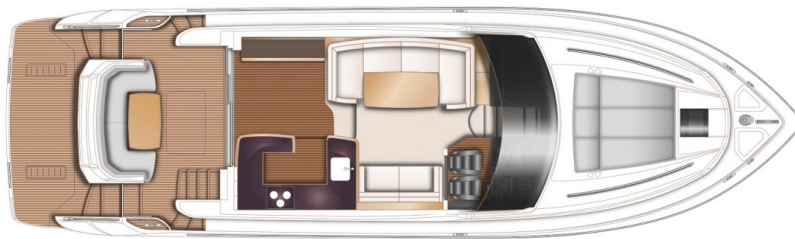

MAIN DECK

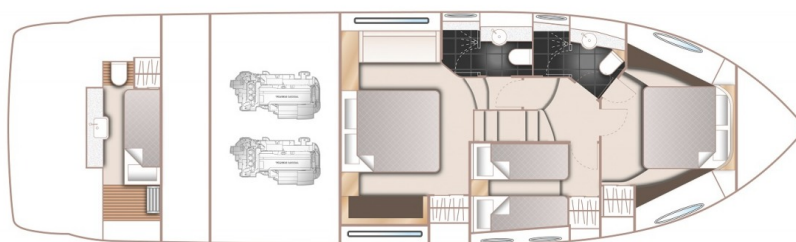

EQUIPMENT

Hull Colour

White hull and superstructure

Navigation Equipment

Raymarine E125 Chartplotter / GPS with external GPS and 12'inch brilliant multifunction display at lower helm and upper helm

Raymarine SHD digital colour radar with 48' 4kW scanner

Raymarine AIS class B transponder

Rear camera positioned on stern

Echo max

European version plotter charts

EU version VHF

Dual station instrumentation, controls and alarms including VHF / RT, speed and distance log

Deck Equipment

Electro hydraulic swimming platform

Electric stern docking winches

Interior Equipment

Stainless steel framed sliding door to cockpit

Saloon table with powered up / down mechanism to convert into coffee table

32'inch HD LED (3D compatible) TV on electric raise / lower mechanism linked to Fusion MS-AV700i radio / iPod /

MP3 with Bluetooth capability

28' LED TV with Fusion MS-AV700i radio / iPod / MP3 with Bluetooth capability fitted to owners stateroom

19' LED TV with Fusion MS-AV700i radio / DVD / MP3 with Bluetooth capability fitted to forward VIP double guest cabin

19' LED TV with Fusion MS-AV700i radio / DVD / MP3 with Bluetooth capability fitted to starboard twin cabin

Sideboard units with glass / bottle / general stowage and drink refrigerator

3 zone ceramic hob

Combination microwave / conventional oven

Teak laid transom platform / cockpit and flybridge	with grill
Dual station remote control searchlight	Stainless steel sink with monobloc mixer tap
Upholstered seating with teak table	Refrigerator with freezer compartment
Hatch to engine room / lazarette	Dishwasher
Large upholstered seating area with teak table to flybridge	Washer / dryer in utility space under lower accommodation stairway
Refrigerated top loading coolbox	Princess china 5 piece, 6 place settings
Flybridge wetbar including electric BBQ grill	David Mellor Paris cutlery (7 pieces) 6 place set
60m chain	Princess glasses (6 wine, 6 tumblers)
Foredeck freshwater anchor / deckwash system	
Williams 285 tender available by separate negotiation	
Ship's Systems	
Variable speed bow and stern thrusters with hold function docking facility and dual station controls	
UK 220v / 240v sockets	
Holding tank	
Duplex engine fuel filter	
60 amp battery charger	
4 x heavy duty batteries for engine starting	
Automatic electric bilge pumps	
Generator	
ONAN 11 kW diesel generator	
Heating	
Eberpacher M10 hydronic boat heating system	
Interior Arrangements	
3 cabin layout inc full beam master, forward VIP and starboard twin cabin	
Starboard cabin fitted with electrically powered double berth conversion	

Aft cabin fit out

3 Heads

Rovere oak interior wood with gloss finish

Aft saloon and galley floor in wenge wood

Midnight sky galley worktop

Helm seats in cocoa brown leather

PRINCESS 52

+33 6 40 61 88 46 

m.st.pierre@princessyachtsmonaco.com

Follow Princess Yachts Monaco

