

PRINCESS 60



BROKERAGE

SPECIFICATIONS

Posizione	Spain, Mallorca	Capacità acqua	796 l
Anno	2012	Cabine	4
Lunghezza	18.62 m	Berths	4
Larghezza	4.82 m	Motorizzazione	Volvo D13 - 900
Pescaggio	1.27 m	Max potenza	2 x 900 hp
Capacità carburante	2819 l	Prezzo	850 000 € (inc VAT)

EQUIPMENT

HULL COLOUR

- White hull and superstructure

NAVIGATIONAL EQUIPMENT

- Variable speed 130kgf bow & 170kgf stern thrusters with dual control
- Dual station radar/chart plotter/GPS with Simrad NSS 12 Multifunction 12.1" brilliant colour display at upper helm
- Dual station speed and distance log
- Dual station echo sounder with alarm
- EU version VHF
- Power-assisted hydraulic steering system
- Dual station electric trim tabs with indicators
- Dual station Autopilot
- Dual station VHF
- Remote control searchlight

DECK FITTINGS

- Complete boat teak-laid decks
- Reversible anchor winch with foredeck, helm position and flybridge controls
- Stemhead roller with automatic anchor launch and retrieve
- Self-stowing 25kg/55lbs Delta anchor with 60m of chain
- Full set of IMCO navigation lights
- Foredeck freshwater anchor/deckwash system
- Underwater transom lights
- U-shape sofa with folding table on flybridge
- Sunbed on flybridge
- Flybridge wetbar with electric BBQ
- Refrigerated coolbox on flybridge
- U-shape seating and teak folding table in cockpit
- Electro-hydraulically powered bimini with lighting

SHIP'S SYSTEMS

- Electric flush toilets with holding tank
- Premium Audio system
- 24V DC/240v AC electrical system
- 220v/240v sockets
- IPOD docking station in Saloon
- Automatic electric bilge pumps with manual override

GENERATOR

- ONAN 13.5Kw/50Hz generator

AIR CONDITIONING / HEATING

- Reverse cycle Airconditioning/heating 74,000Btu
- Three cabin layout with crew cabin
- 2 double berths with en-suite
- 1 twin berth with en-suite
- Twin crew cabin with head
- U-shaped sofa and coffee table in saloon with sofa opposite
- Entertainment centre incorporating LED TV and DVD/radio with surround-sound system

- Cocktail cabinet with storage, refrigerator and icemaker
- Dining area with U-shaped seating and additional stools
- Door fitted to forward bathroom for day access

INTERIOR EQUIPMENT

- Combination microwave/conventional oven/grill
- Refrigerator (full height with deep freeze)
- Cocktail cabinet (with icemaker and refrigerator)
- Starboard cabin electric sliding berths converting to double
- Separate washing machine & condenser dryer machine
- 19" LED TV/Radio/DVD/MP3 player in forward cabin
- 19" LED TV/Radio/DVD/MP3 player in Starboard cabin
- Dishwasher in galley

MOTORIZZAZIONE

Volvo D13-900 (2 x 900 hp)

Engine hours: XXX m/h

EXTERIOR



INTERIOR

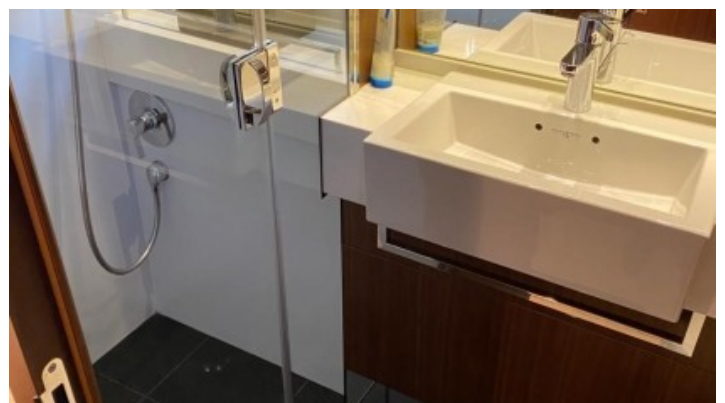
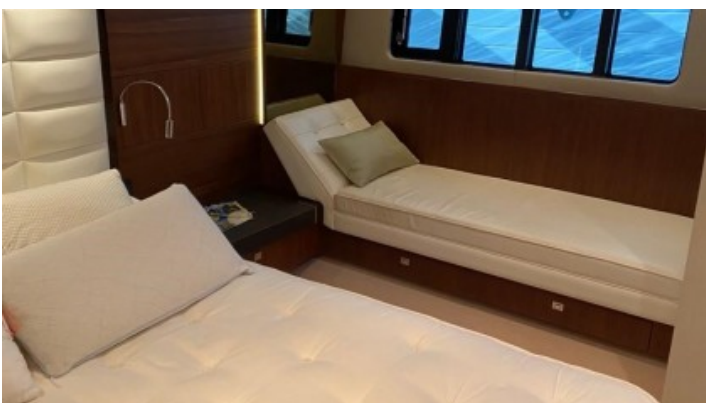

LAYOUTS



FLYBRIDGE

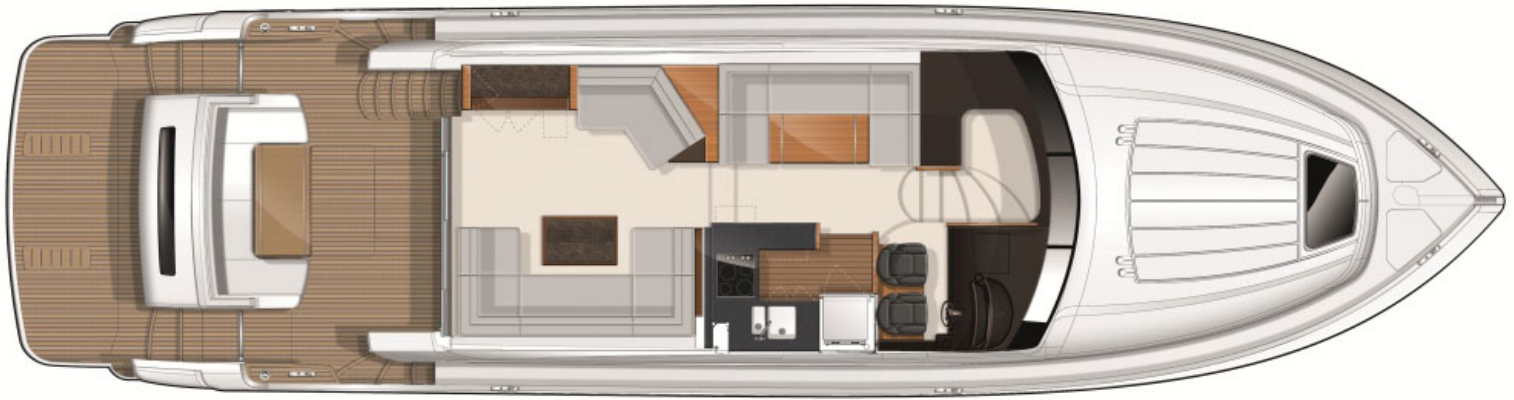

MAIN DECK



LOWER DECK
