

PRINCESS 64



BROKERAGE

SPECIFICATIONS

Posizione	After request	Capacità carburante	3409 l
Anno	2014	Capacità acqua	909 l
Lunghezza	19.70 m	Motorizzazione	2 x Volvo D13-900
Larghezza	5.03 m	Max potenza	2 x 900 hp
Pescaggio	1.45 m	Prezzo	Prezzo alla richiesta
Peso	34 tonnes		



GALLERY















LAYOUTS

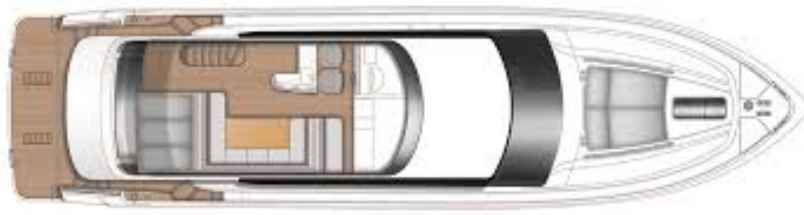

FLYBRIDGE

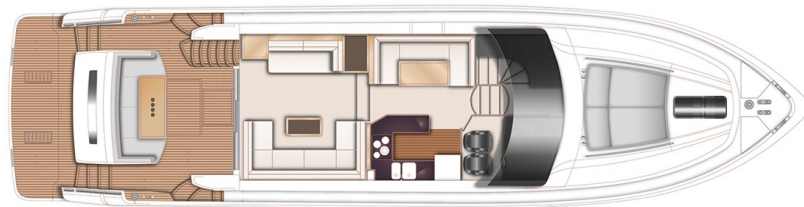

MAIN DECK

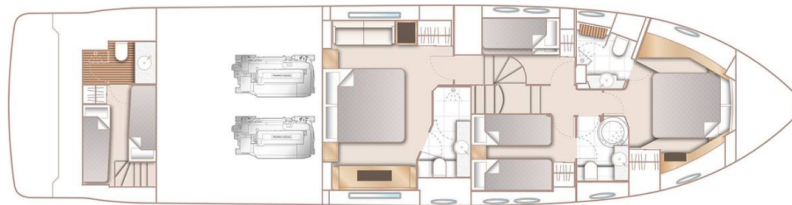

LOWER DECK

EQUIPMENT

HULL COLOR

White

INTERIOR

Walnut interior wood Gloss finish

Standard helm console in Chocolate Brown

Lower Helm seats to be Cocoa Brown leather
Bathroom worktops are in Kokoura avonite
Bathroom floors in Midnight Sky
Copper Canyon galley worktop
8 place setting of China, Cutlery & Glasses

Wood finish galley floor to be in wenge

Aft Cabin Fit out

Starboard Cabin to have double berth conversion with powered sliding mechanism

Additional charge for Platinum Leather upholstery

Princess China (5 piece consisting)

David Mellor 'Paris' Cutlery

Princess Glasses

NAVIGATION

Standard Navigation equipment incorporates: Raymarine e125 Radar/Chartplotter with GPS & 12.1' brilliant colour multifunction display and with 4kw SHD 48' digital colour open array scanner at lower helm. Raymarine p70 R autopilot with rate gyro and i70 colour multifunction instruments (for speed, distance, trip, depth, depth alarm, water temperature etc) at both helm positions (two i70's at lower and one at upper)

Raymarine e125 multifunction 12.1' brilliant colour multifunction display at upper helm

Raymarine AIS Class B transponder

GENERATOR

ONAN 17.5 kW / 50 Hz generator in place of standard ONAN 11.0 kW

ELECTRICAL

Continental 220v/240v sockets

Underwater transom lights (4 LUMISHORE SMX Blue)

AUDIO VISUAL & COMMUNICATIONS

PREMIUM AUDIO SYSTEM: Deck Saloon – Harman Kardon 5.1Blu-ray system (with Bluetooth connectivity) and KEF speakers Flybridge linked to the saloon audio system

Forward Guest Cabin – 22' LED TV with Fusion MS-AV700i Radio/DVD/MP3 player

AIR CONDITIONING

Airconditioning/heating reverse cycle (72,000 BTU)

Aft Cabin airconditioning

EXTERIOR UPHOLSTERY / COVERS

Craft are supplied with white PVC cockpit covers as standard

White mesh windscreen covers in place of standard black

Bimini top – Dark Blue sunbrella canvas

Teak laid side decks

Bimini top to have LED overhead lighting

Flybridge teak deck as standard

Bimini top to be electro-hydraulically powered

Foredeck sunbed cushions in Movida

Cockpit & flybridge seating including helm seats and sunbed cushions Movida

DECK HARDWARE

Dinghy chocks on bathing platform

Stainless steel anchor in place of standard

Electro-hydraulic telescopic passerelle

Sternthruster

Additional 20m of 10 mm anchor chain to give a total of 60 metres

MOSQUITO SCREENS

Mosquito screens for all opening portlights

YACHT TENDER

Turbojet 325-2014 – Sport 100HP

PRINCESS 64

+33 6 40 61 88 46 

m.st.pierre@princessyachtsmonaco.com

Follow Princess Yachts Monaco

