

PRINCESS F43 (644)



BROKERAGE

HIGHLIGHTS

/ 120 ENGINE HOURS
/ VAT INCLUDED
/ BOW/STERN THRUSTERS

/ JOYSTICK
/

SPECIFICATIONS

Posizione	Denmark
Anno	2015
Lunghezza	14.5 m
Larghezza	4.25 m
Pescaggio	1.14 m
Peso	15.1 tonnes
Capacità carburante	1363 l
Capacità acqua	455 l

Cabine	2
Berths	4
Motorizzazione	Cummins QSB 6.7
Max potenza	2 x 550 hp
Velocità	31 +
Engine hours	120 m/h
Prezzo	650 000 € (inc VAT)

EQUIPMENT

NAVIGATION SYSTEM

2x Simrad plotter/radar

2x autopilot

2x log/echo sounder

2x VHF

2x Compass

DRIVE SYSTEM & MANOUVERING

Joystick

Bow and stern thrusters (2x100kg) with variabe speed and hold function

Trim tabs

Demist system

Wind screen wipers with flush

Seachlight

Horn

Hydraulic steering

EXTERIOR

White hull

Teak side decks, flybridge, cockpit and bathing platform

Hydraulic bathing platform

Hydraulic passarelle

Electric anchor winch with stainless steel anchor and 10m extra chain

Wetbar on flybridge with BBQ griddle and sink

Cool box on flybridge

White covers cockpit + flybridge Hydraulic bimini top with light inside

Front window cover

Stereo/speakers on flybridge

Drop box pulpit

Shower on stern deck

Fresh water connection on foredeck

INTERIOR

Interior in glossy cherry

Electric stove

Oven/microwave

Dishwasher

Washing machine/Dryer

Extra fridge in saloon

32 inch TV on elevator in saloon

22 inch TV in fore cabins with Fusion stereo

Stereo/DVD in saloon

Electric sliding berth in midcabin Electric flush on toilets

Heated floor in WC

Dimmer on lights in saloon, cockpit and galley

OTHER

Shorepower/Charger

Calorifier

Upgraded generator to 9.5 kW Aircondition 42000 BTU (reversible)

Holding tank with ocean and deck emtying

Fenders and ropes

MOTORIZZAZIONE

Twin Cummins QSB 6.7 (2 x 550 hp)

Max speed 31 knots

EXTERIOR



INTERIOR



LAYOUTS

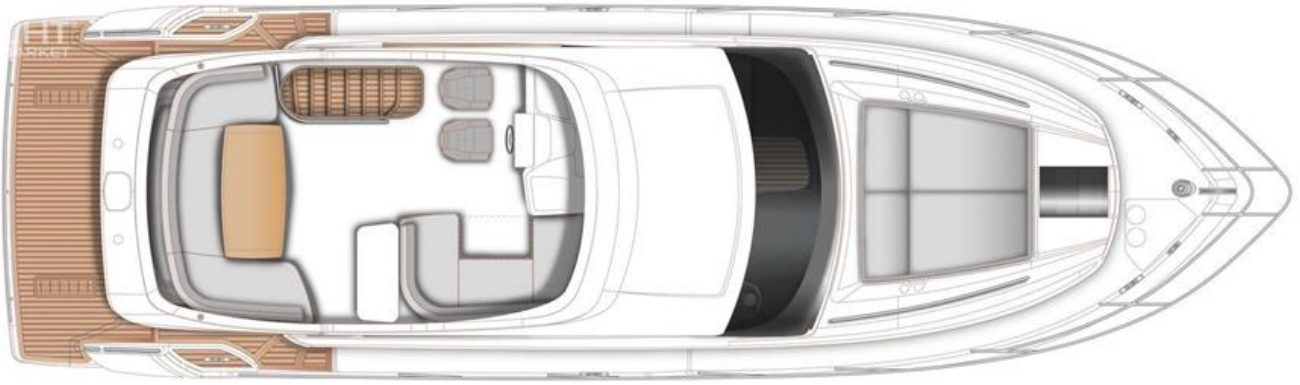

FLYBRIDGE



MAIN DECK

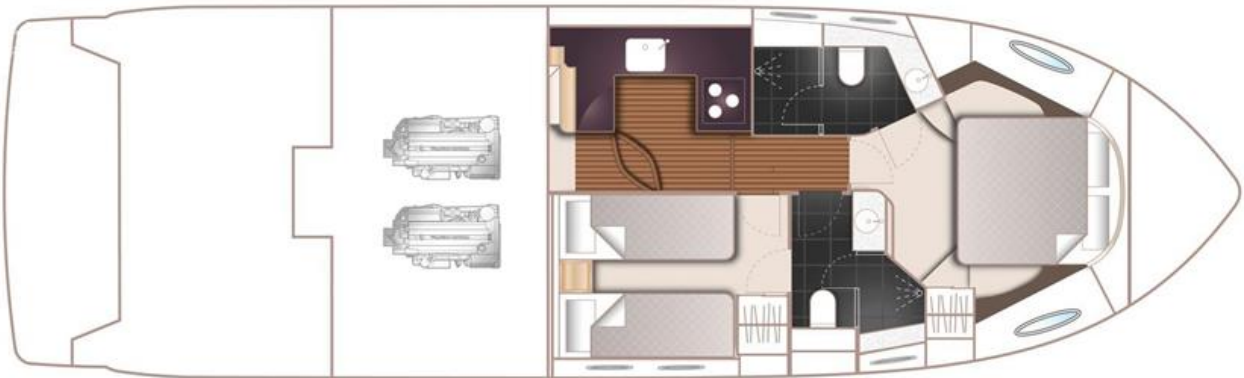

LOWER DECK
