

## PRINCESS F55



BROKERAGE

### HIGHLIGHTS

/ LOW ENGINE HOURS  
/ PERFECT CONDITION  
/ 3 CABINS + 1 CREW  
/ AC  
/ 17.5 KW GENERATOR

/ ELECTRO-HYDRAULIC PLATFORM AND PASSARELLE  
/ PREMIUM UPHOLSTERY  
/ PREMIUM TV/AV EQUIPMENT  
/ UPGRADED LIGHT PACKAGE

### SPECIFICATIONS

Posizione	Italy, Naples	Capacità acqua	608 l
Anno	2019	Cabine	3+1
Lunghezza	17.6 m	Motorizzazione	VOLVO PENTA
Larghezza	4.87 m	Max potenza	2 x 900 hp
Pescaggio	1.46 m	Velocità	33 +
Peso	25 tonnes	Engine hours	490 m/h
Capacità carburante	2750 l	Prezzo	1 600 000 € (inc VAT)

## EQUIPMENT

---

Walnut interior wood Satin finish (galley floor is walnut as standard)

---

International VHF

---

Continental 200v/240v sockets

---

Aft Cabin fit out

---

Teak laid flybridge deck

---

Electro-hydraulic transom platform

---

Electro-hydraulic telescopic passerelle (2,9m) with automatic hand rails

---

Additional 20m of 10mm anchor chain to give a total of 60 meters

---

Onan 17,5 kw generator in place of standard

---

Dishwasher fitted in galley

---

Foredeck freshwasher anchor/deckwash system

---

Stern docking lights

---

Exterior Lightning Upgrade Package

---

Premium Audio System

---

Master stateroom 40" LED TV

---

Forward stateroom 32" LED TV

---

Garmin XHD colour radar with 24" kw Radome

---

Additional 16 Garmin installed to upper and lower helm

---

Garmin remote control keypad at the lower helm position

---

Garmin AIS 800 Class B transponder

---

Foredeck seating in upgraded Comfort Exterior II Met

---

Airconditioning/heating reverse cycle (78,000 BTU) suitable for temperature to 40 grades (tropical)

---

Aft cabin air conditioning

---

Electric overboard discharge system in addition to standard to manual system

---

Aft cabin toilet to be connected into holding tank system

---

Electric stern rope handling winches (2)

---

Foredeck sunbedcushion(with adjustable headrest) in upgraded Comfort Exterior III Met

---

Reticulated foam for foredeck sunbeds

---

Reticulated foam for all standard exterior cockpit foredeck and flybridge seating/sunpads

---

Foredeck seating in Comfort Exterior III Vogue

---

Cockpit and flybridge upholstery including helms seats in upgraded Comfort Exterior III Vogue

---

Supply of scatter cushions

---

Stools for use at dinette in forward saloon area (2)

---

Quilts rectangular quilted blankets and headboards

---

Foredecking seating Comfort Exterior III Vogue

---

Bidet Shower

---

Supply Jabsco water pump

---

Supply additional lighting

---

Supply with mood lighting under saloon

---

## MOTORIZZAZIONE

---

**2 x VOLVO PENTA 900 HP (490 hours)**

## EXTERIOR





# INTERIOR



# LAYOUTS

---

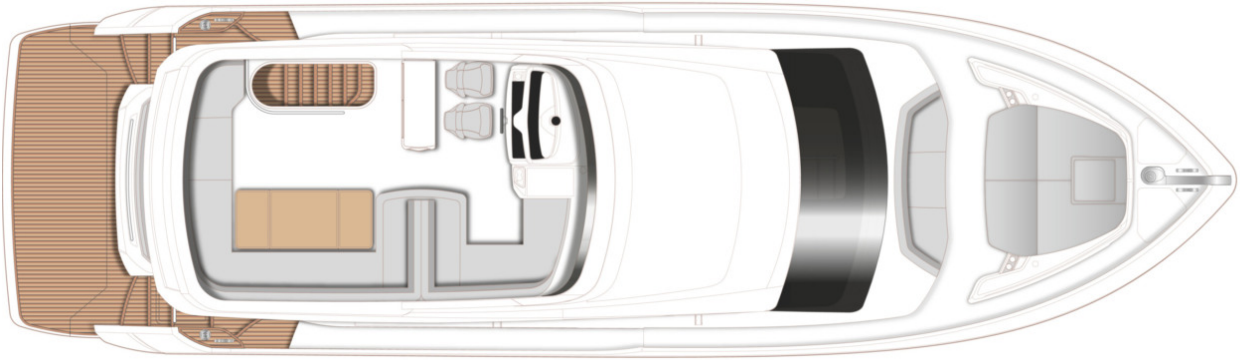

FLYBRIDGE

---

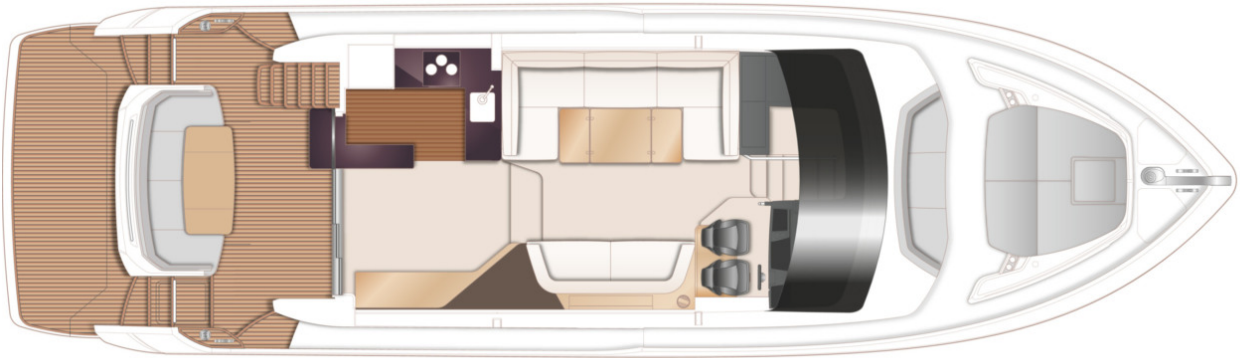

MAIN DECK

---

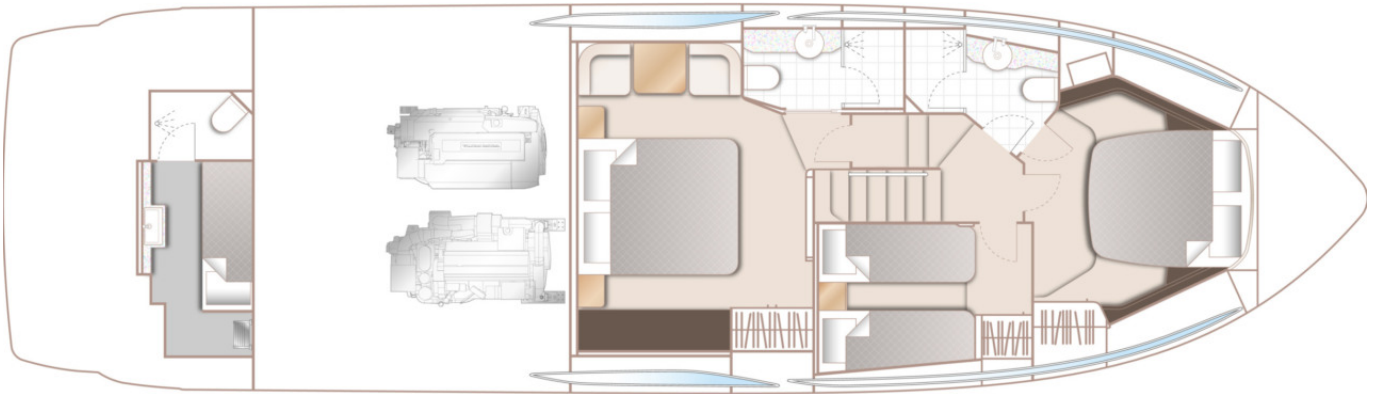

LOWER DECK

---