

## 2012 PRINCESS 60



BROKERAGE

### HIGHLIGHTS

- / IMPECCABLE CONDITION
- / FULLY SERVICED
- / LOW HOURS
- / BOTH THRUSTERS
- / PASSARELLE
- / ELECTRO-HYDRAULIC PLATFORM
- / ELECTRO-HYDRAULIC FLY Bimini
- / 13.5 KW ONAN GENERATOR
- / TENDER ON BOARD

### SPECIFICATIONS

Posizione	Trieste, Italy	Capacità carburante	2800 l
Anno	2012	Capacità acqua	793 l
Lunghezza	18.62 m	Cabine	3+1
Larghezza	4.82 m	Motorizzazione	2 x Volvo D13
Pescaggio	1.27 m	Max potenza	900 hp
Peso	26.5 tonnes	Prezzo	970 000 € (inc VAT)



































LAYOUTS



FLYBRIDGE

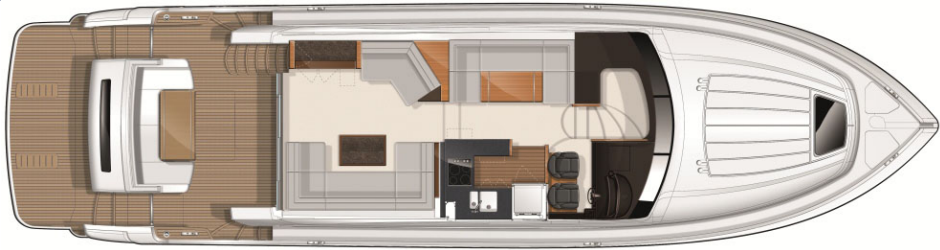

MAIN DECK



LOWER DECK

EQUIPMENT

NAVIGATIONAL EQUIPMENT

Variable speed 130kgf bow & 170kgf stern thrusters with dual control

Dual station radar/chart plotter/GPS with Simrad NSS 12 Multifunction 12.1' brilliant colour display at upper helm

Dual station speed and distance log

Dual station echo sounder with alarm

EU version VHF

Power-assisted hydraulic steering system

Dual station electric trim tabs with indicators

Dual station Autopilot

Dual station VHF

Remote control searchlight

DECK FITTINGS

Complete boat teak-laid decks

Reversible anchor winch with foredeck, helm position, and flybridge controls

Stemhead roller with automatic anchor launch

Sunbed on flybridge

Flybridge wet bar with electric BBQ

Refrigerated coolbox on flybridge



and retrieve	U-shape seating and teak folding table in cockpit
Self-stowing 25kg/55lbs Delta anchor with 80m of chain	Electro-hydraulically powered bimini with lighting
Full set of IMCO navigation lights	Passarelle
Foredeck freshwater anchor/deck wash system	Electro-hydraulic platform
Underwater transom lights	
U-shape sofa with folding table on flybridge	

## SHIP'S SYSTEMS

Electric flush toilets with holding tank	220V/240V sockets
Premium Audio system	iPod docking station in saloon
24V DC/240V AC electrical system	Automatic electric bilge pumps with manual override

## GENERATOR

ONAN 13.5Kw/50Hz generator (Hours: Contact us)

## AIR CONDITIONING / HEATING

Reverse cycle air conditioning/heating  
74,000Btu

## INTERIOR EQUIPMENT

U-shaped sofa and coffee table in saloon with sofa opposite	Cocktail cabinet (with icemaker and refrigerator)
Entertainment center incorporating LED TV and DVD/radio with surround-sound system	Starboard cabin electric sliding berths converting to double
Cocktail cabinet with storage, refrigerator, and icemaker	Separate washing machine & condenser dryer machine
Dining area with U-shaped seating and additional stools	19' LED TV/Radio/DVD/MP3 player in forward cabin
Door fitted to forward bathroom for day access	19' LED TV/Radio/DVD/MP3 player in Starboard cabin
Combination microwave/conventional	

oven/grill	LED TV/Radio/DVD/MP3 player in Master cabin
Refrigerator (full height with deep freeze)	Dishwasher in galley



## 2012 PRINCESS 60

+33 6 40 61 88 46 

[m.st.pierre@princessyachtsmonaco.com](mailto:m.st.pierre@princessyachtsmonaco.com)

---

Follow Princess Yachts Monaco

