

PRINCESS V39



SPECIFICATIONS

Posizione	London, United Kingdom	Capacità acqua	332 l
Anno	2015	Cabine	2
Lunghezza	13 m	Berths	4
Larghezza	3.8 m	Motorizzazione	2 x Volvo Penta D6
Pescaggio	0.56 m	Max potenza	660 hp
Peso	8.7 tonnes	Engine hours	170 m/h
Capacità carburante	730 l	Prezzo	395 000 € (inc VAT)

















LAYOUTS

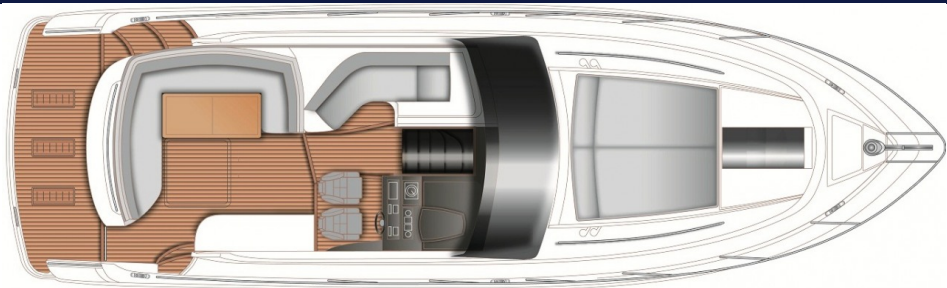

MAIN DECK

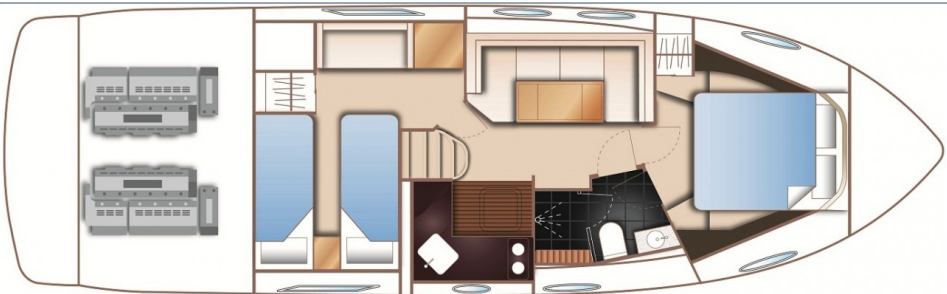

LOWER DECK

EQUIPMENT

Navigational Equipment

Volvo joystick control

Raymarine AIS class B transponder interfaced with chart plotter including 5ft aerial

Raymarine E125 chart plotter / GPS with external GPS and 12.1' brilliant colour multifunction display

Raymarine autopilot p70r with colour display / giro

Raymarine HD colour radar with 18' 4KX Radome

Full engine instrumentation including fuel gauges and engine controls

EU version VHF

European version plotter charts

Speed and distance log

Echo sounder with alarm

High speed magnetic compass

Controls for windscreen wipers / bilge pump / anchor winch / trim tabs and sterndrive trim

Remote control searchlight

Deck Equipment

Teak-laid transom platform and cockpit

Reversible electric anchor winch with helm position controls

Transom gate leading to bathing platform

High capacity air compressor to inflate dinghy

Sliding side window to helm position	Life-raft storage locker
Self-stowing 16kg / 35lbs Delta anchor with 30m of chain	Large transom storage locker
Full height cockpit cover in dark grey sunbrella with removable sides and back, on telescopic stainless steel frame	Locker housing 240V shore support inlet
Transom tender launch system	Locker with remote fuel cocks
Raised teak deck at helm position	12V exterior splash proof power point
L-shaped seat	White low level cockpit and bathing platform LED lights
Cockpit wetbar including sink, storage and electric BBQ	2 x Lumishore SMX20 blue underwater transom lights

Ship System's

Bow thruster	Battery link facility with remote control at helm position
UK 220V / 240V sockets	70 amp battery charger charging both banks of batteries via automatic switch charging system
System 2 holding tank	Shore support inlet in cockpit locker with storage for cable
Power-assisted electronic steering system with hydraulic back-up	Polarity check system
2 x heavy-duty batteries for engine starting	Earth leakage safety trip
2 x heavy-duty auxiliary batteries	Power points to all areas

Inventory

ONAN 4kW diesel generator with hydro-hush exhaust and sound shield

Air Conditioning / Heating

Eberspacher D4 Airtronic boat heating	Eberspacher heater outlet fitted to cockpit
Windscreen demist system using warm air heater from calorifier	

Interior Arrangements

2 cabin layout including forward master and aft twin cabins	White galley worktop
Aft cabin fitted with full length settee / third berth	Ice white leather interior upholstery
Walnut interior woodwork, gloss finish	Velvet ivory carpet fitted throughout the vessel

Interior Equipment

Ceramic 2 burner electric hob	28' LED TV with upgraded Fusion MS-AV700i radio / DVD / MP3 and Bluetooth facility fitted to saloon
Combination microwave / conventional oven with grill	28' LED TV with upgraded Fusion MS-AV700i radio / DVD / MP3 and Bluetooth facility fitted to master cabin
Stainless-steel sink with monobloc mixer tap	22' LED TV with upgraded Fusion MS-AV700i radio / DVD / MP3 and Bluetooth facility fitted to aft cabin
Refrigerator with freezer compartment	Loudspeakers fitted to forward coach roof

MOTORIZZAZIONE

2 x Volvo Penta D6 (2 x 330 hp)
Hours: 170

PRINCESS V39

+33 6 40 61 88 46 

m.st.pierre@princessyachtsmonaco.com

Follow Princess Yachts Monaco

