

PRINCESS V55



ALLURE STYLING UPGRADE

HIGHLIGHTS

/ OPPORTUNITY FOR YOUR NEXT SEASON

/ SEAKEEPER ON BOARD

/ JOYSTICK CONTROL AND AFT STATION

/ TROPICAL AC AND UPGRADED GENERATOR

/ 3 CABINS FOR 6 GUESTS + 1 FOR CREW

/ AFT ELECTRO CANOPY + BOW BIMINI

/ FULL TEAK

SPECIFICATIONS

| | |
|---------------------|----------------|
| Posizione | Monaco, Monaco |
| Anno | 2025 |
| Lunghezza | 17.8 m |
| Larghezza | 4.66 m |
| Pescaggio | 1.4 m |
| Peso | 31 tonnes |
| Capacità carburante | 2500 l |

| | |
|----------------|----------------------|
| Capacità acqua | 477 l |
| Cabine | 3 |
| Berths | 6 |
| Motorizzazione | Volvo Penta D13-1000 |
| Max potenza | 2x 1000 hp |
| Velocità | 37 |
| Prezzo | 2 043 000 € (ex VAT) |

The yacht is on the commission of Princess Yacht Monaco. The Company is not responsible for the accuracy of the information provided by the Yacht owner (images, specification, parameters, engine performance, legal, etc). The operating time of the engines is indicated at the time of preparation of the information and may change during further operation. The need for an inspection remains at the discretion of the Buyer. Exact parameters and characteristics can be specified in the contract of sale. Additional information is available upon request.

DESCRIPTION



The Princess V55 available for early season 2025. V55 is a stunning 59-foot yacht that blends contemporary design, advanced technology, and exhilarating performance. Powered by high-performance engines, the Princess V55 can reach a top speed of 37 knots, delivering a smooth and thrilling ride. Fitted with the latest gyro stabilizer for enhanced stability and comfort, it ensures a seamless experience even in more challenging conditions. The interior accommodates up to 6 guests in three beautifully appointed cabins, including a master suite, a VIP cabin, and a twin guest cabin, each designed with premium materials and the highest attention to detail. The open-plan saloon is bright and airy, offering panoramic views and a perfect flow between indoor and outdoor living spaces. Highlights of this yacht include a very rich specification including joystick control with an aft control station for easy maneuvering, an upgraded generator for enhanced power management, and a watermaker for extended cruising capabilities. The yacht also features the Allure styling upgrade, adding even more luxury and refinement throughout the interior. For outdoor enjoyment, the Princess V55 boasts all decks finished in teak, an electric sun awning for shade on the aft deck, and a foredeck sun awning supported by carbon fiber poles. These features ensure the perfect blend of comfort and style for outdoor relaxation. This opportunity represents the best way to start the next 2025 season without the wait. ”













LAYOUTS

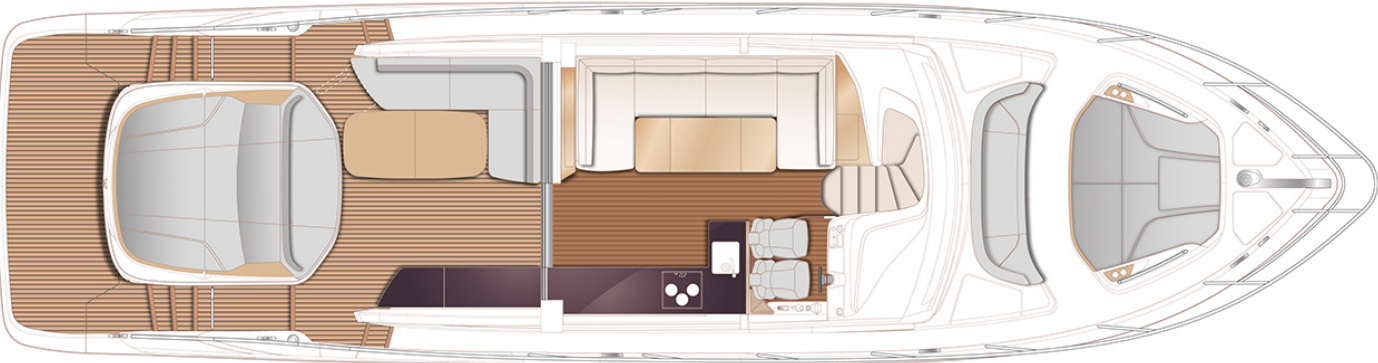

MAIN DECK

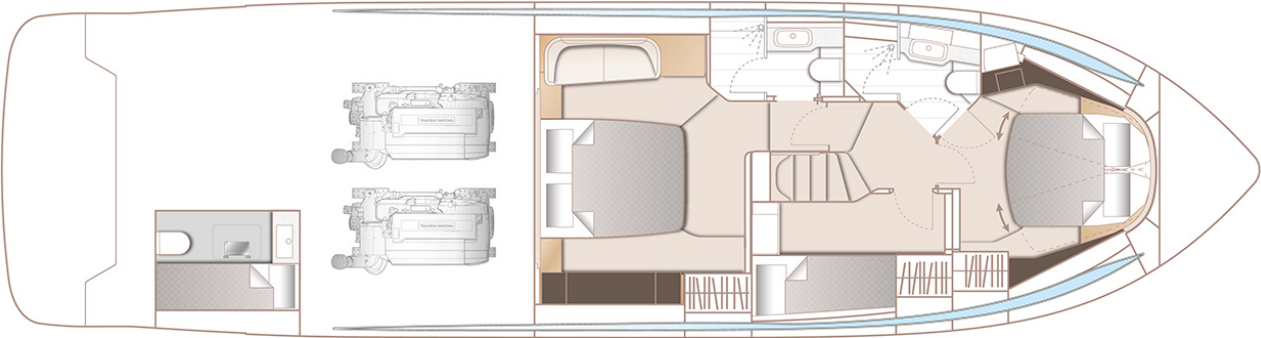

LOWER DECK

EQUIPMENT

GALLEY

2x Volvo Penta D13-1000 (2x 1000 hp)

Volvo joystick control with low speed manoeuvring in 'docking mode' and steering at any speed in 'driving mode'. Operates engines, steering and thruster(s) including stern thruster when fitted (includes upgrading standard bow thruster to 210KgF variable speed)

HOLD FUNCTION DOCKING FACILITY, includes fitting a 170 kgf variable speed sternthruster

Second station controls in cockpit including thruster controls and emergency engine stop

Gyro Stabilisation (Seakeeper 9)

Carrera White galley countertop

White (with dark grey waterline & black antifouling, hull & bathing platform fendering is white with stainless steel insert)

Engine air intake cover finished in Onyx Black metallic, canopy buttress above aft section of deckhouse glazing, cockpit

headliner and sliding roof with cover panel finished in Graphite Grey metallic. Canopy styling blade finished in Platinum gloss.

Cockpit wet-bar fascia finished in Platinum gloss with Graphite grey gloss accent to bar.

PRINCESS V55

+33 6 40 61 88 46 
m.st.pierre@princessyachtsmonaco.com

Follow Princess Yachts Monaco



The yacht is on the commission of Princess Yacht Monaco. The Company is not responsible for the accuracy of the information provided by the Yacht owner (images, specification, parameters, engine performance, legal, etc). The operating time of the engines is indicated at the time of preparation of the information and may change during further operation. The need for an inspection remains at the discretion of the Buyer. Exact parameters and characteristics can be specified in the contract of sale. Additional information is available upon request.