

PRINCESS X90



SPECIFICATIONS

Posizione	Plymouth, United Kingdom
Anno	2026
Lunghezza	26.77 m
Larghezza	6.62 m
Pescaggio	1.79 m
Peso	91 tonnes
Capacità carburante	11000 l

Capacità acqua	1500 l
Cabine	5+3
Berths	8
Motorizzazione	MAN V12-2000
Max potenza	2 x 2,000 hp
Velocità	23 - 26
Prezzo	Prezzo alla richiesta

The yacht is on the commission of Princess Yacht Monaco. The Company is not responsible for the accuracy of the information provided by the Yacht owner (images, specification, parameters, engine performance, legal, etc). The operating time of the engines is indicated at the time of preparation of the information and may change during further operation. The need for an inspection remains at the discretion of the Buyer. Exact parameters and characteristics can be specified in the contract of sale. Additional information is available upon request.

DESCRIPTION



The Princess X90, the latest model in the award-winning X-Class series, blends innovative design, luxury, and craftsmanship, positioned between the X80 and flagship X95 Vista. Notable features include a redesigned cockpit with seamless connections to the main deck, expansive glass surrounds for natural light, and a master suite on main deck with a private terrace.

The enclosed Skylounge on the flybridge offers family entertainment with an optional 85-inch TV, while the spacious aft deck provides customizable entertainment setups. The yacht offers flexible cabin options for guests and crew.

The first Princess X90 will debut in 2026 and already promises to be a very popular addition to the Princess X Class series.









LAYOUTS

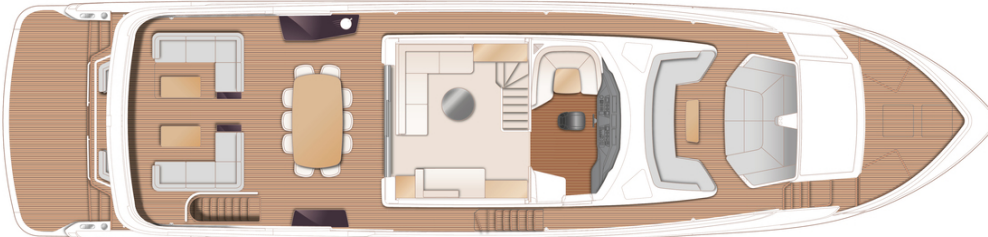

FLYBRIDGE

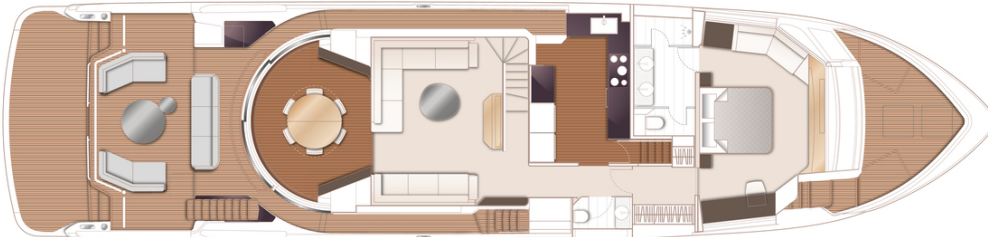

MAIN DECK

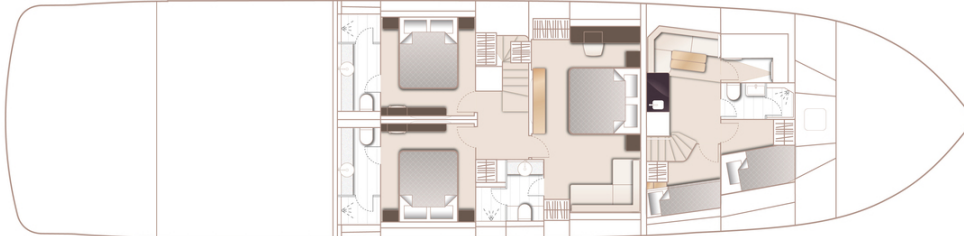

LOWER DECK

PRINCESS X90

+33 6 40 61 88 46 
m.st.pierre@princessyachtsmonaco.com

Follow Princess Yachts Monaco



The yacht is on the commission of Princess Yacht Monaco. The Company is not responsible for the accuracy of the information provided by the Yacht owner (images, specification, parameters, engine performance, legal, etc). The operating time of the engines is indicated at the time of preparation of the information and may change during further operation. The need for an inspection remains at the discretion of the Buyer. Exact parameters and characteristics can be specified in the contract of sale. Additional information is available upon request.