

PRINCESS F60 (032)



BROKERAGE

HIGHLIGHTS

/ GENERATOR ONAN 13,5 KW
/ BOW-THRUSTER

/ TENDER WILLIAMS 325
/ CREW CABIN FIT OUT

СПЕЦИФИКАЦИИ

Местоположение	Italy, Imperia	Каюты	4
Год	2012	Число спальных мест	8
Длина	18.61 м	Двигатели	Volvo D13-800
Ширина	4.83 м	Макс. мощность	2 x 800 лс
Осадка	1.27 м	Макс. скорость	33 +
Водоизмещение	30.5 tonnes	Наработка двигателей	2130 m/h
Запас топлива	2818 л	Цена	650 000 € (ex VAT)
Запас воды	793 л	Flag	Jersey

ОБОРУДОВАНИЕ

HULL COLOUR / INTERIOR FURNITURE

Hull color: white

Teak laid on flybridge

Teak laid on side deck

LAYOUT

Standard three cabin layout

Starboard cabin inboard berth to have electrically powered sliding mechanism to convert to double

Crew cabin fit out

INTERIOR/EXTERIOR STYLING

Foredeck sunbed cushions are Movida Metallic Beige

Exerior upholstery in Movida Metallic Beige with Shwarz accents

DECK HARDWARE & EQUIPMENTS

Dishwasher in a galley

Bow-thruster

Stern rope handling winches

Extra 20 meters of anchir chain, that gives 60 meters in total

Anchor chain wash system

Optional generator ONAN 13,5 kW instead of standard ONAN 11 kW

Air conditioning in all cabins

Air conditioning in a crew cabin

Electrical toilets

Front windows demyst system

Tender Williams 325

AUDIO VISUAL & COMMUNICATIONS

Audio system Bose Premium

Home theater stereo system BOSE Lifestyle 48 in saloon + speakers on flybridge

Home theater stereo system BOSE 3.2.1 GS in master cabin

19" LED TB/DVD in VIP cabin

iPod dock stations in master cabin and main saloon

NAVIGATION

Optional Raymarine chartplotters instead of Simrad

Second MFD Raymarine E120W on flybridge

ДВИГАТЕЛИ

Volvo D13-800 (2 x 800 hp)



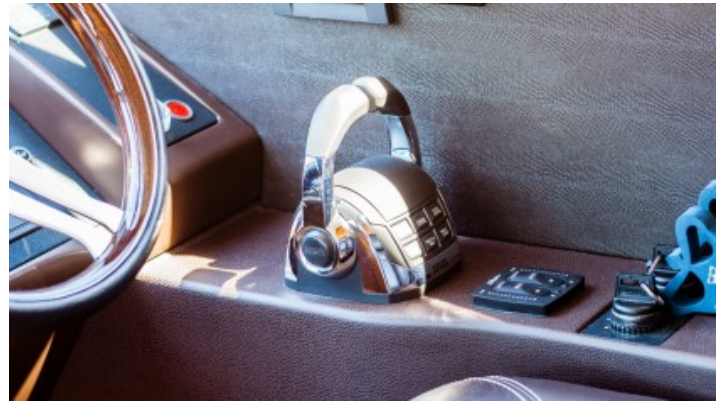

LAYOUTS



FLYBRIDGE

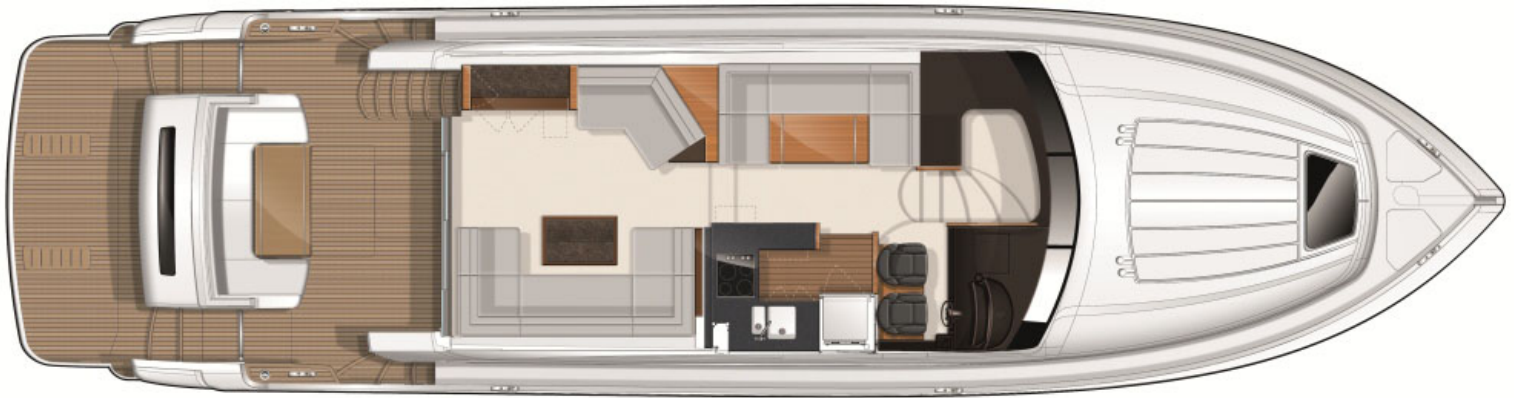

MAIN DECK



LOWER DECK
