

## PRINCESS 43 (644)



SOLD

### HIGHLIGHTS

/ 120 ENGINE HOURS  
/ VAT INCLUDED  
/ BOW/STERN THRUSTERS

/ JOYSTICK  
/

### СПЕЦИФИКАЦИИ

Местоположение	Denmark
Год	2015
Длина	14.5 м
Ширина	4.25 м
Осадка	1.14 м
Водоизмещение	15.1 tonnes
Запас топлива	1363 л
Запас воды	455 л

Каюты	2
Число спальных мест	4
Двигатели	Cummins QSB 6.7
Макс. мощность	2 x 550 лс
Макс. скорость	31 +
Наработка двигателей	120 m/h
Цена	650 000 € (inc VAT)

## ОБОРУДОВАНИЕ

---

### NAVIGATION SYSTEM

2x Simrad plotter/radar

2x autopilot

2x log/echo sounder

2x VHF

2x Compass

### DRIVE SYSTEM & MANOUVERING

Joystick

Bow and stern thrusters (2x100kg) with variabe speed and hold function

Trim tabs

Demist system

Wind screen wipers with flush

Seachlight

Horn

Hydraulic steering

### EXTERIOR

White hull

Teak side decks, flybridge, cockpit and bathing platform

Hydraulic bathing platform

Hydraulic passarelle

Electric anchor winch with stainless steel anchor and 10m extra chain

Wetbar on flybridge with BBQ griddle and sink

Cool box on flybridge

White covers cockpit + flybridge Hydraulic bimini top with light inside

Front window cover

Stereo/speakers on flybridge

Drop box pulpit

Shower on stern deck

Fresh water connection on foredeck

### INTERIOR

Interior in glossy cherry

Electric stove

Oven/microwave

Dishwasher

Washing machine/Dryer

Extra fridge in saloon

32 inch TV on elevator in saloon

22 inch TV in fore cabins with Fusion stereo

Stereo/DVD in saloon

Electric sliding berth in midcabin Electric flush on toilets

Heated floor in WC

Dimmer on lights in saloon, cockpit and galley

### OTHER

Shorepower/Charger

Calorifier

Upgraded generator to 9.5 kW Aircondition 42000 BTU (reversible)

Holding tank with ocean and deck emtying

Fenders and ropes

## ДВИГАТЕЛИ

---

Twin Cummins QSB 6.7 (2 x 550 hp) Max speed 31 knots





# LAYOUTS

---

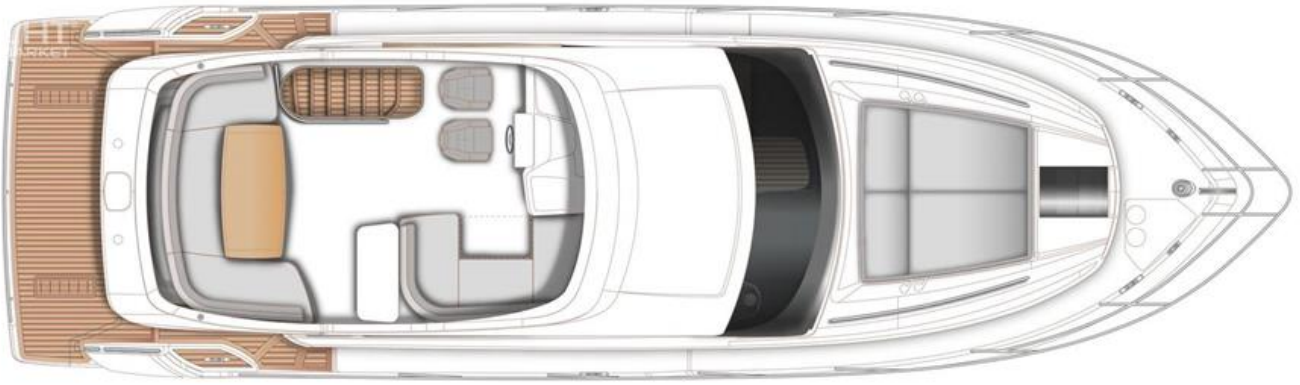

FLYBRIDGE

---



MAIN DECK

---

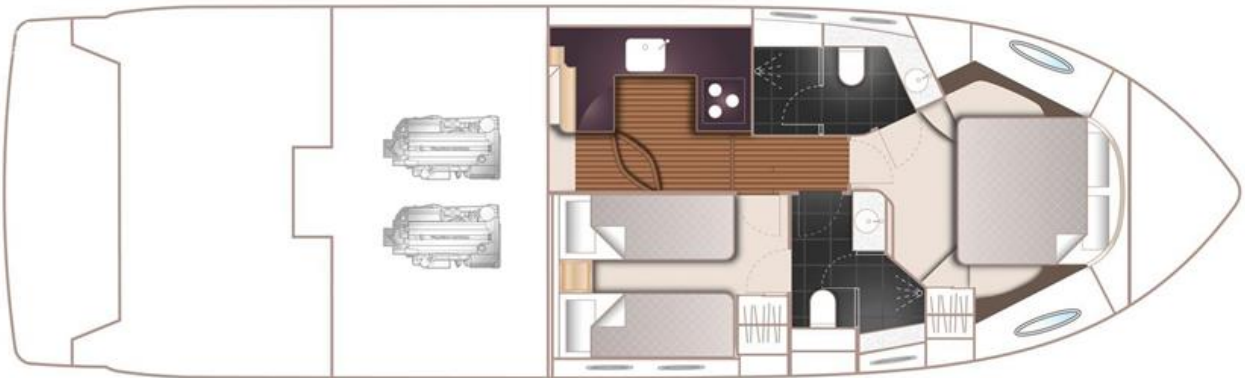

LOWER DECK

---