

PRINCESS V55



СПЕЦИФИКАЦИИ

Местоположение	United Kingdom, Plymouth
Длина	17.81 м
Ширина	4.65 м
Осадка	1.40 м
Водоизмещение	27.5 tonnes
Запас топлива	2200 л
Запас воды	550 л

Каюты	3+1
Число спальных мест	6+1
Двигатели	Volvo D13 1000
Макс. мощность	2 x 1000 лс
Макс. скорость	37 +
Цена	Цена по запросу

ОБОРУДОВАНИЕ

DECK FITTINGS

Teak-laid transom platform, cockpit deck and steps to side decks

Reversible electric anchor winch with foredeck and helm position controls

Self-stowing 32kg/70lbs Delta anchor with 40m of chain

Storage lockers for fenders and ropes

Foredeck seating and sunbathing area

Stainless steel cleats, fairleads and handrails

LED deck level lighting

Freshwater deck/anchor wash

COCKPIT

L-shaped seating with teak folding table

Sunbed aft with garage with electro-hydraulic door and tender launch system with electric winch (3.45m tender)

Twin transom gates leading to bathing platform with electro-hydraulic raise/lower mechanism, foldaway swimming ladder and hot and cold shower

Wetbar including electric barbecue and drawer fridge

Waterproof speakers linked to deck saloon sound system

Lockable gas strut assisted hatches to engine room, lazarette and optional crew cabin

Liferaft storage locker

Cockpit cover

HELM POSITION

Twin helm seats with electric adjustment for helmsman

Electric opening windows at starboard side

Full engine instrumentation including fuel gauges, exhaust temperature, fuel contamination alarms and rudder position indicator

Navigation system including colour radar, GPS and chartplotter (2 displays), VHF/RT, speed and distance log, echo sounder with alarm, autopilot and high speed magnetic compass

Controls for bow thruster, windscreen wipers, bilge pump and trim tabs (with indicators)

Chart storage

24v and 240v control panel

Red night lighting

Toughened glass screen (clear for night vision)

DECK SALOON

Stainless steel framed drop down patio door to cockpit with integrated opening window aft of galley

U-shaped sofa with dining table

Entertainment centre incorporating 49" UHD LED TV on electric raise/lower mechanism with Naim audio system and ceiling mounted speakers (2)

Electric opening roof

GALLEY

3-zone ceramic hob

Combination microwave/convection oven with grill

Stainless steel sink with mixer tap

Refrigerator with freezer compartment

Storage lockers, cupboards and drawers

ACCOMMODATION

All cabins and bathrooms feature opening portholes

All cabins feature 220/240v power points

All mattresses pocket sprung

All bathrooms feature electric freshwater toilets, extractor fan and 240v shaver points

OWNER'S STATEROOM

Large double bed with drawers below

Wardrobes with hanging and shelf storage

Storage lockers and drawers

Dressing table

Sofa

40" UHD LED TV, DVD Blu-ray with Naim audio system with speakers (2) and subwoofer

En suite bathroom

FORWARD GUEST CABIN

Large double bed with drawers below (option of scissor berths)

Wardrobe with shelves

Dressing table

Deck hatch

Storage lockers and drawers

En suite bathroom with day access

STARBOARD GUEST CABIN

Two single beds with drawers below

Wardrobe with shelves

Storage lockers and drawers





LAYOUTS

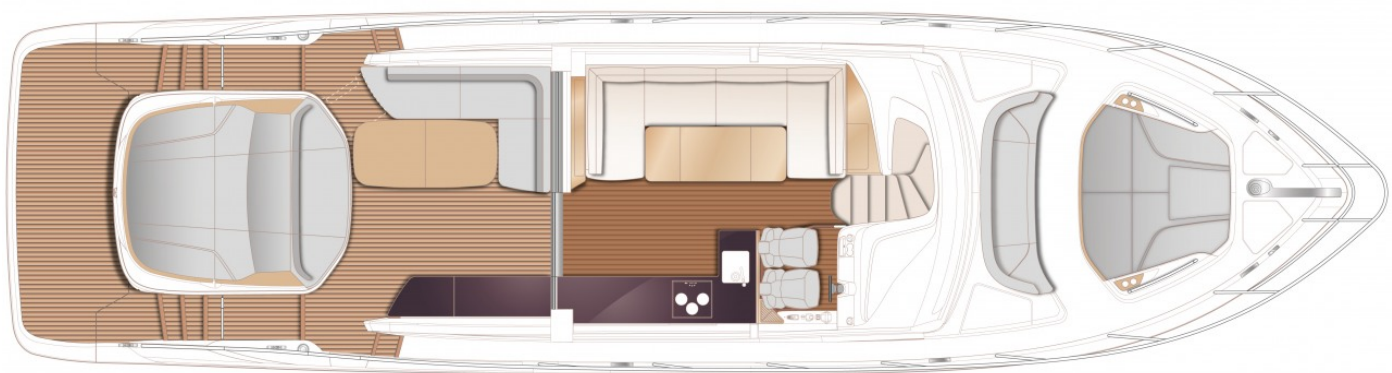

MAIN DECK

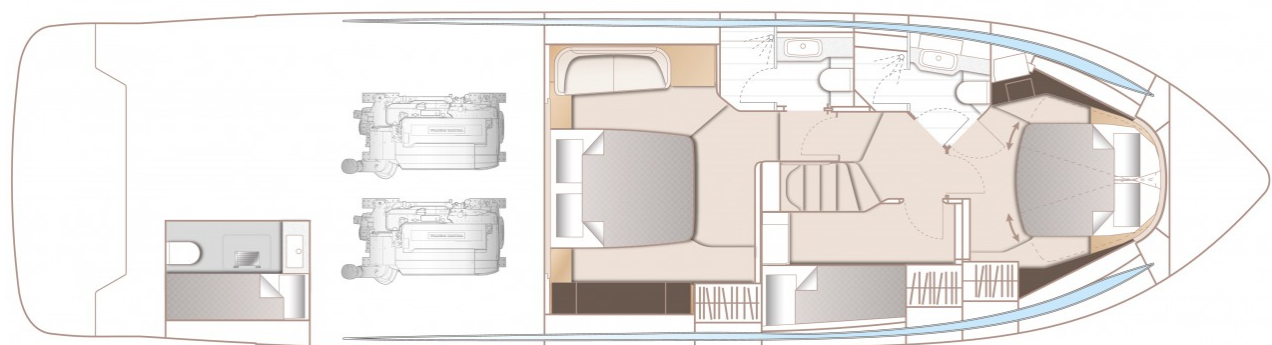

LOWER DECK

Yachts on the commission of Princess Yacht Monaco. The Company is not responsible for the accuracy of the information provided by the Shipowner (images used, yacht specifications, parameters, engine performance, legal design issues). The operating time of the engines is indicated at the time of preparation of the information and may change during further operation. The need for an inspection remains at the discretion of the Buyer. Exact parameters and characteristics can be specified in the contract of sale. Additional information is available from the manager on request.