

## PRINCESS Y75



BROKERAGE

### HIGHLIGHTS

/ BRAND NEW  
/ FULL OPTION

/ EXCLUSIVE INTERIOR DESIGN

### СПЕЦИФИКАЦИИ

Местоположение	Netherlands
Год	2019
Длина	24.67 м
Ширина	5.76 м
Осадка	1.72 м
Водоизмещение	47.7 tonnes
Запас топлива	6000 л

Запас воды	1350 л
Каюты	4+2
Число спальных мест	8+4
Двигатели	Twin MAN V12-1800
Макс. мощность	2 x 1800 лс
Макс. скорость	34-36 †
Цена	3 939 000 € (ex VAT)

## ОБОРУДОВАНИЕ

Hydraulic system consisting of separate engine driven hydraulic pumps allowing any system to be supplied with hydraulic power from either engine. Including hydraulic anchor winch and 300 kgf hydraulic bow thruster (in place of standard) 300 kgf hydraulic stern thruster and hold function docking system. All with dual station controls

Sleipner Vector Fin stabilisation system with VF1050 fins. When underway fins are driven by engine powered hydraulic motors and at zero speed by a generator powered electric motor (only available if hydraulics are specified). 27Kw generator is recommended

White hull (with Charcoal Grey waterline, Black antifouling & Charcoal Grey hull pinstripe, hull & bathing platform fendering is White with stainless steel insert)

Walnut interior wood satin finish (galley & helm floors are walnut as standard)

Port cabin to have double berth conversion with powered sliding mechanism on inboard berth

All roman blinds on maindeck are changed in venetian blinds wood in frosted white duo. (50mm)

In Forward cabin, Port cabin en Starboard cabin supply and fit Frosted Sand white duo venetian blinds instead of standard Walnut venetian

Allure pack

Transom/flybridge teak step nosing upgrade

Severy sprayed in Oyster Grey (when severy specified)

Spray flybridge console in Oyster Grey

Option to spray hardtop. If hull is painted, default option will be Oyster Grey unless otherwise stated

Internal helm seats in Sapang Bronze leather to match forward dinette seating

Inset font panel and Allure Collection additional contrast piping in Gabardine Arrow Wood novasuede.

External helmseats — main material Comfort Exterior II Met Ice. Contrast to inset panel to front of backrest an styling wedge to back of headrest Comfort Exterior II Met Meteor. Contrast stich to match Met Meteor in Serafil thread 399.

Flybridge external upholstery. Main Material Comfort Exterior II Met Ice. Contrast panelling and piping Comfort Exterior II Met Meteor

Underwater transom lights (4 LUMISHORE SMX53 Blue)

Underwater lighting to aft hull sides (4 SUMISHORE SMX53 Blue)

Lower accommodation lighting upgrade package

Includes: low level ambient lighting in all sleeping cabins wiht overhead lighting on dimmer switch (standard in master stateroom)

Upper accommodation lighting upgrade package

Includes: overhead accents lights to aft galley screens combined with additional ambient lighting in forward saloon area

Exterior lighting upgrade package

Includes: additional deck level lights on side decks and transom, flybridge deck and wetbar

Optional saloon table lamp (located on forward starboard crockery unit)

Porta Romana, Grace lamp clb29 in 5 stone

Porta Romana, shade for above: 13" top hat with chalk linen shade

Optional stateroom table lamp (located at aft end of port vanity unit)

Porta Romana, base cologne lamp glb49 in 2 olive wiht decayed gold collar

Porta Romano, shade for above: 16" straight oval with taupe silk shade

Reticulated foam to all standard exterior cockpit and flybridge seating/sunpads in place of standard

Teak coffee table (with deck mounted fixing point) for foredeck

Carbon poled Foredeck sun awning with grey mesh shade

Organic White quartz galley worktop

All guest bathrooms te be in Carrara White instead of standard Koko White

Teak laid side decks and foredeck walk through area

GRP Flybridge hardtop featuring electric opening section in soft fabric (including lighting)

Third station controls in cockpit (engine controls, thruster controls and engine emergency stop)

Stainless steel keyway plates and slider system for later fitting of tender

Cockpit servery unit (including 100l drawer fridge and storage cupboard, sink and tap)

Cockpit servery unit to have small sink and tap filled

Teak coffee table (with deck mounted fixing point) for foredeck

Prepare for later fitting of flybridge crane i.e. run copex from crane base area to AC/DC panel

ONAN 27Kw/50Hz generator fitted in place of standard (recommended if Fin stabilisers are fitted)

Continental 220v/240v sockets

Fit 12 bottle wine cooler in galley

Freshwater maker (190l/hour) complete with remote instrumentation and service/spares kit

Lava Brick BBQ in place of standard

In bathrooms supply and fit dark grey venetian blinds in place of standard gold bullion

---

Heated towel rail in bathroom in Owners cabin and Forward cabin

---

Underfloor heating in bathroom in Owners cabin and Forward cabin

---

Separate washing machine and condenser dryer located in utility area (in place of standard washer/dryer)

---

Ice maker fitted in flybridge wetbar

---

Upper accommodation lighting upgrade package

---

Includes: Overhead accent lights to aft galley screens combined with additional ambient lighting in forward saloon area

---

Lower accommodation light upgrade package

---

Includes: Low level ambient lighting in all sleeping cabins with overhead lighting on dimmer switch (standard in Master Stateroom)

---

Exterior lighting upgrade package

---

Includes: Additional deck level lights on side decks and transom, flybridge deck and wetbar.

---

Also pop up lanterns (2) in foredeck sunbathing area

---

PREMIUM AUDIO SYSTEM incorporates:

Deck Saloon – Harman Kardon 5.1 Blu-ray system (with Bluetooth connectivity) and KEF speakers

---

Owners Stateroom – Harman Kardon 5.1 Blu-ray system (with Bluetooth connectivity) and KEF speakers

---

Forward Guest Cabin – Harman Kardon 2.1 Blu-ray system (with Bluetooth connectivity) and KEF speakers (when option TV is selected)

---

Flybridge – Fusion UD750 Radio/iPod/MP3 player with waterproof speakers also linked to saloon

---

Forward Guest Cabin – 32" LED TV linked to Harman Kardon 2.1 Blu-ray system (with bluetooth connectivity) and KEF speakers

---

Cockpit speakers with local control (linked to flybridge system)

---

Foredeck seating walk through area – waterproof speakers linked to the flybridge audio system, with separate local control

---

Four Raymarine GS165 multifunction 15.4" brilliant colour multifunction displays (ie 2 at each helm position) in place of standard

---

Raymarine GS series remote control keypad (RMK-9) at upper and lower helms

---

European version plotter

---

Supply and fit AIS A – Raymarine 950 with separate VHF antenna

---

International VHF

---

Mosquito screens for portlights

---

Foredeck sunbed cushions in Comfort Exterior II, colour Met Macadamia

---

Flybridge upholstery including helm seats and sunbed cushions – Comfort Exterior II, colour Met Maccadamia, Inlay Titanium

---

Cockpit upholstery: Baumann outdoor Nevada col. 0043

---

Exterior covers – Flybridge Grey Sunbrella Supreme / Cockpit grey Sunbrella Plus

---

Carpet Jacaranda Natural Weave Square Grey

---

Premium Materials

---

Bedding

---

Scatter cushions

---

1 kg/Hull Superstructure gelcoat

---

2 x Additional fenders with ropes (36"x12") each

---

Spare set of anodes (hull, hydraulic platform & swim ladder)

---

Fill craft with fuel (6000 l)

---

## ДВИГАТЕЛИ

---

Twin MAN V12-1800 (2 x 1800 hp)

## ЭКСТЕРЬЕР

---





# LAYOUTS

---

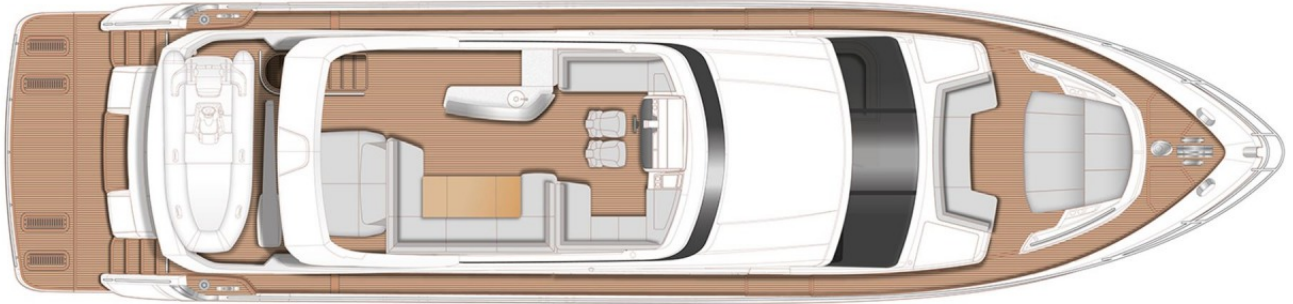

## FLYBRIDGE

---

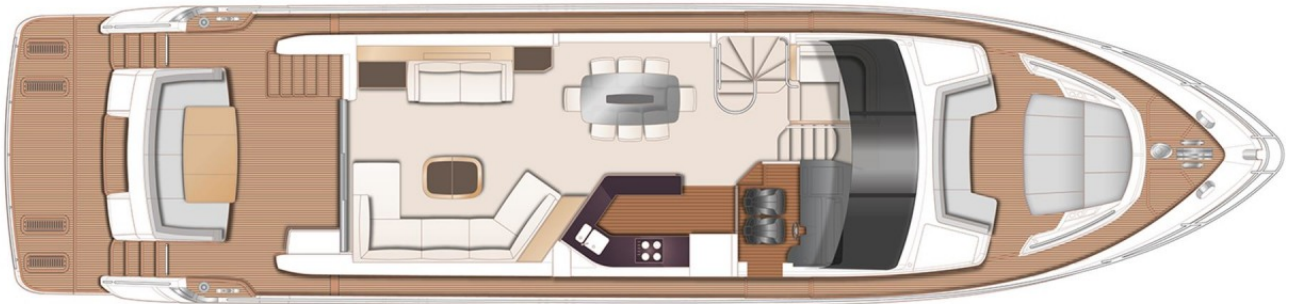

## MAIN DECK

---

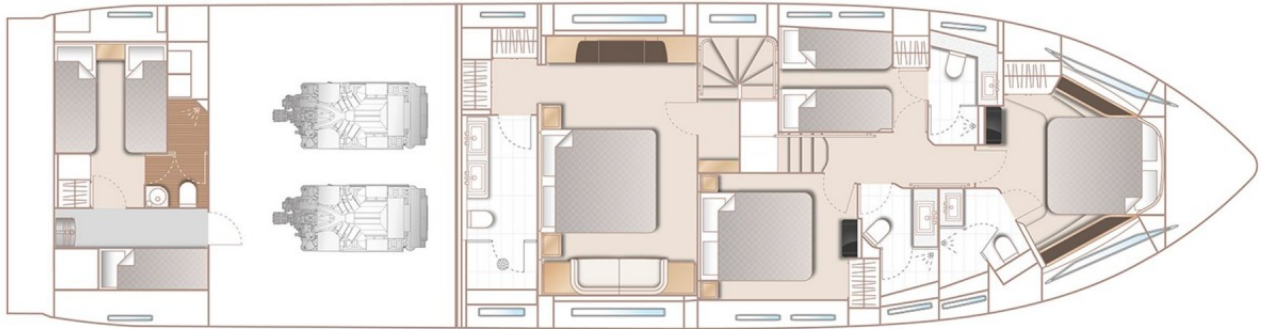

## LOWER DECK

---