



F55





Equipped with twin Volvo D13-900 engines providing speeds up to 33 knots, in addition to a deep-V resin-infused hull, the F55 delivers dynamic and effortless seakeeping.

As seen on larger yachts in the range, the cockpit servery unit connects to the galley unit, seamlessly integrating the two entertainment areas. The spacious main deck saloon is accentuated by vast saloon windows, complemented by subtle accent lighting, soft fabric finishes and hand-stitched detailing. A contemporary U-shaped sofa with convertible coffee/dining table and sofa adjacent, creates the perfect place to spend time with loved ones.









Below deck, new expansive hull windows generously flood the three cabins with light, including the master stateroom with dressing table, breakfast area and en-suite bathroom, a forward double guest cabin and starboard twin cabin with the option of a double bed conversion. An optional single aft cabin with en-suite and storage is ideal for crew.







Take a virtual tour of the F55







# F55

## Layouts and Specifications

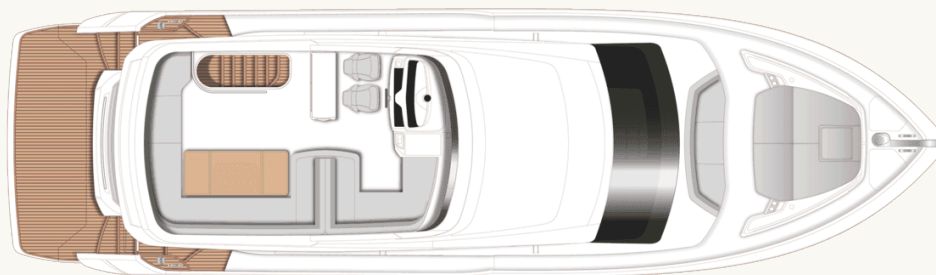

F55 Flybridge

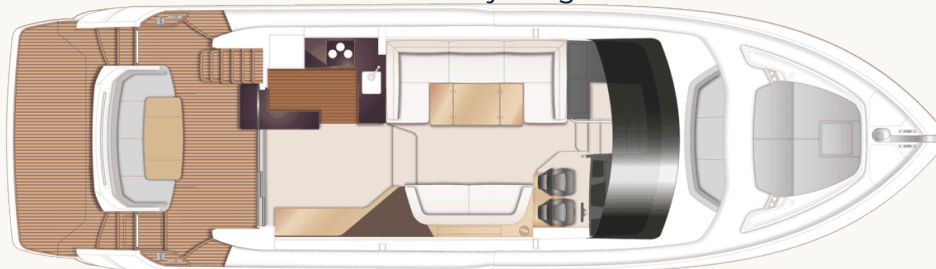

F55 Main Deck

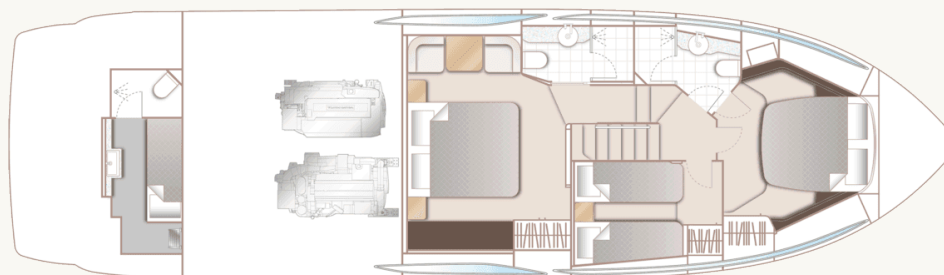

F55 Lower Deck



## Principal Dimensions

Length overall (incl. pulpit)	58 ft 0 in / 17.68m
Length overall (excl. pulpit)	55 ft 8 in / 16.98m
Beam	16 ft 0 in / 4.87m
Draft	4 ft 11 in / 1.49m
Displacement approx.	29,088 kg / 64,128 lbs*
Fuel capacity	605 gal / 726 US gal / 2,750 l
Water capacity (excl. calorifier)	136 gal / 164 US gal / 620 l
Black water tank	69 gal / 83 US gal / 315 l

## Engines - Diesel

Twin Volvo D13-900 (2 x 900mhp)	Maximum speed range – 31-33 knots <sup>†</sup>
---------------------------------	--



## Full Specification

### Deck fittings

- Teak-laid transom platform, cockpit deck, flybridge stairway and steps to side deck
- Reversible electric anchor winch with foredeck and helm position controls
- Stemhead roller with automatic anchor launch and retrieve
- Self-stowing (25kg/55lb) galvanised Lewmar Delta anchor with 40m of galvanised 9.5mm anchor chain
- Bow rope storage locker
- Foredeck forward facing seating
- Foredeck sunbathing area
- Drinks holders to foredeck seating
- Deck storage locker for fenders and ropes
- Stainless steel bow, stern and spring cleats (8)
- Stainless steel pulpit and guardrails
- Stainless steel coachroof handrails
- Foredeck hatch
- PVC rubbing band with stainless steel insert
- LED deck level lighting

- Illuminated crown logo to transom
- Full set of IMCO navigation lights
- Riding light
- Searchlight with remote control
- Twin electric horns
- Loudhailer
- Fuel and water fillers

### Cockpit and bathing platform

- Self-draining
- Fixed bathing platform
- U-shaped seating/dining area
- Folding teak table
- Stairs to flybridge
- LED overhead and deck level lighting
- Stainless steel handrails
- Rope stowage locker
- Lockable gas strut assisted hatch to engine room
- Lockable gas strut assisted hatch to lazarette
- Locker containing remote fuel cocks, manual bilge pump with valve chest and manual controls

for automatic fire extinguishers

- Twin transom gates leading to bathing platform
- Retractable bathing ladder (manual) in side of bathing platform
- Transom steps to access stern from bathing platform
- Hot and cold transom shower
- 220/240v shore support inlet in locker
- Cockpit cover

### Flybridge

- Dual station instrumentation and controls with 16" Garmin screen displaying engine instrumentation, fuel gauges, rudder position indicator and chartplotter (either individual or combined)
- Adjustable steering wheel
- Top loading coolbox adjacent to helm
- Audible and visual alarm for bilge pumps
- Twin helm seats with manual fore and aft adjustment for helmsman



- Drinks holders
- U-shaped upholstered seating starboard fore (converts to sunbed)
- U-shaped upholstered seating area starboard aft
- Teak folding table
- Fusion MS-SRX400 audio system with waterproof Fusion signature 6.5" speakers linked to saloon audio unit
- Wetbar including sink and stowage
- Clear view hatch to aft cockpit
- Wind deflector screens
- Stainless steel handrails
- Stainless steel handrail forward of flybridge hatch
- LED deck level lighting
- GRP radar arch
- Matched whip aerials for VHF R/T and radio
- Liferaft stowage
- ROKK twin USB socket
- Console and seat covers

#### **Lower helm position**

- Twin helm seats with manual fore and aft adjustment for helmsman
- Instrument console with 16" Garmin screen

displaying engine instrumentation, fuel gauges, rudder position indicator and chartplotter (either individual or combined)

- Volvo engines have a 7" display for engine instrumentation at both control positions. The 16" screen incorporates Volvo software to allow engine instrumentation and autopilot function displays, as well as the 7" display. If a second 16" screen is ordered it will be fitted immediately in front of the helm position with the engine instrumentation display to starboard.
- Dual station instruments and controls at Flybridge and Lower Helm Positions:
  - power-assisted electric steering
  - adjustable steering wheel
  - high-speed magnetic compass
  - electronic engine controls
  - trim tab controls with indicators
  - bow thruster control
  - electric anchor winch remote control
  - autopilot (incorporated into 16" screen at both control positions)
  - speed and distance log (incorporated into 16" screen at both control positions)
  - echo sounder with alarm
  - VHF with DSC R/T with intercom

- remote control searchlight
- horn button
- Footrest in boat timber
- Drinks holders
- Toughened glass screen (clear for night vision)
- Windscreen wipers with freshwater windscreen wash
- Black mesh sunscreens
- Bilge pump controls with visual pump running warnings
- 24v and 240v electrical control panel
- Riding light, helm and navigation light control switches
- Twin USB charging point
- LED overhead lighting (24v) and night lighting
- Electric drop window (Starboard)
- Fitted carpet

#### **Deck saloon**

- U-shaped sofa
- Folding leaf dining table or coffee table
- Electric drop window (port)
- Two-seater sofa
- Crockery storage drawer
- Sideboard unit with bottle and glass storage to



starboard aft saloon

- UHD LED TV (50") on rise and fall
- Apollo MS-RA670 audio system, with WiFi/DAB and external USB socket. Paired with Fusion 6" MS-CL602 speakers (2)
- Blinds or sunscreens to all windows and doors
- LED overhead and concealed lighting (24v)
- Access stairway to lower accommodation
- Fitted carpet

### **Galley**

- Solid Surface counter top in white
- Ceramic 4-zone hob
- Hob extractor
- Combination microwave/convection oven with grill
- Stainless steel sink with mixer tap
- Full height fridge/freezer (270l)
- Waste bin
- Chopping board
- Drawers and storage cupboards
- Refrigerator
- Stainless steel framed sliding door to cockpit with integrated hinging window aft of galley
- Blinds or sunscreens to all windows and doors

- LED overhead and task lighting (24v)
- 220/240v outlets (4)
- Timber-laid flooring

### **Accommodation**

- All cabins and bathrooms feature opening portholes
- All cabins feature 220/240v power points
- All bathrooms feature electric freshwater toilets and 240v shaver points

### **Owner's stateroom**

- Large double bed with drawers below
- Twin bedside tables
- Wardrobe with shelves and mirror
- Dressing table
- Pull out mirror to vanity unit
- Occasional table with seats fore and aft
- Storage lockers and drawers
- Fusion MS-SRX400 paired with Fusion 6" MS-CL602 speakers (2)
- Panoramic windows including opening porthole with venetian blinds
- LED overhead and concealed lighting (24V)

- Individual berth lights
- 220/240v outlets (2)
- 2x USB charging points (at each berth)
- Fitted carpet

### **En-suite bathroom**

- Wash basin with Solid Surface vanity top
- Mirror
- Storage lockers
- Shower compartment with automatic pump out
- Extractor fan
- Window with opening porthole and venetian blind
- LED overhead and concealed lighting (24V)
- Bathroom accessories
- Solid Surface flooring

### **Forward stateroom**

- Large double bed with drawers below
- Wardrobe with shelves and mirror
- Dressing table
- Mirror to vanity unit
- Storage lockers
- Window with opening porthole and venetian

blind

- Deck hatch
- LED overhead and concealed lighting (24v)
- Individual berth lights
- 220/240v outlets (2)
- 2 x USB charging points (at each berth)
- Fitted carpet

#### En-suite bathroom

- Wash basin with Solid Surface vanity top
- Mirror
- Storage lockers
- Shower compartment with automatic pump out
- Extractor fan
- Window with opening porthole and venetian blind
- LED overhead and concealed lighting (24V)
- Bathroom accessories
- Solid Surface flooring

#### Starboard guest cabin

- Two single beds with drawers below
- Bedside table
- Wardrobe with shelves

- Mirror
- Storage lockers and drawers
- Window with opening portholes and venetian blind
- LED overhead and concealed lighting (24v)
- Individual berth lights
- 220/240v outlets (2)
- 2 x USB charging points (at each berth)
- Fitted carpet

#### Power and drive systems

- 5-bladed propellers in nickel aluminum bronze
- Bow thruster is 130kgf/286lbf with dual-station controls
- Engine room lighting
- Engine room access hatch and ladder
- Power-assisted electro-hydraulic steering system
- Trim tabs with indicators
- Electronic engine and gear shift controls
- Engine room extractor fans with electronic time delay
- Fresh water supply point in engine room
- Dripless self-aligning shaft seals

#### Electrical systems

#### 24 Volt:

- 4 x heavy duty batteries for engine starting
- 4 x heavy duty auxiliary batteries
- Battery link facility with remote control at helm position
- Both battery banks are charged using a voltage sensitive relay that parallels both battery banks when a charging source is present
- 60-amp battery charger
- Remote battery master switches with control switch at main switch panel
- Circuit breakers on all circuits
- 12v voltage dropper for certain navigation and radio circuits
- Princess Connect telemetry and maintenance

#### 220/240 Volt:

- 9.5Kw diesel generator in own sound shield with water cooled specially silenced exhaust
- Automatic fire extinguisher situated in the engine room
- 50-amp shore support inlet
- Generator/shore support change-over switch
- Polarity check system



- Earth leakage safety trip
- Circuit breakers on all circuits
- Power points in: Owner's stateroom, guest cabins, galley and saloon area
- Shaver points in all bathrooms

#### **Fuel system**

- Twin fuel tanks (in NS8 marine grade alloy) with interconnection system giving 605 gal/726 US gal/2,750l capacity
- Fuel fillers on port and starboard side decks
- High-capacity duplex fuel filters with water traps with change-over valves
- Water warning sensors connected to warning lights at lower helm
- Remote fuel cocks in cockpit locker
- Fuel gauges at main helm console

#### **Water system**

- Water tanks totalling 136 gal/164 US gal/620l plus 16 gal/19 US gal/73l hot water calorifier
- Water heated by engines and 240v immersion heater
- Automatic water pump with filter

- Main circuit breaker at switch panel
- Water level gauge
- Deck filler
- Electric freshwater toilet system with 69 gal/83 US gal/315l black water tank, content gauge and manual overboard discharge, with macerator backup system as well as dockside discharge system

#### **Fire extinguishers**

- Automatic/manual override fire extinguishers in engine room with warning system at helm position
- Hand-operated fire extinguishers (5) in owner's stateroom, forward and starboard guest cabin, galley and helm position
- Additional extinguisher fitted when optional aft cabin is specified

#### **Bilge pumps**

- Automatic/manual override electric bilge pumps in engine room (2), lazarette and forward accommodation (5 in all)
- High-capacity manual bilge pump with valve

- system and suction points in same areas
- Electric bilge pumps have controls and warning lights at main helm and warning light with audible alarm at flybridge helm

#### **Other standard equipment**

- Ensign staff
- Fenders (6)
- Mooring warps (4)
- Boat hook
- First Aid kit
- Tool kit
- Owner's manual and engine manual
- Quilted bedspreads supplied to all cabins (except optional crew cabin)
- Ship's document case
- Anchor winch back up handle

#### **Finishes**

- Teak-laid decks to transom platform, steps to side decks, cockpit deck and steps to flybridge
- Timber-laid floor to galley area
- Furniture in Rovere oak with satin finish as standard. Optional finishes include ash or silver

oak with a satin finish or walnut wood in a satin or gloss finish

- Solid Surface floors in all bathroom suites in guest accommodation
- Solid Surface wash basin and counter tops in all bathrooms
- Galley counter top in Solid Surface finish
- Exterior flybridge helms seat upholstery in Comfort Exterior as standard
- Additional exterior upholstery in white vinyl as standard, with optional upgrade to Comfort Exterior available
- Choice of high-quality carpet and upholstery fabric from extensive range
- Blinds or sunscreens to all windows and portholes