

F 55



From the moment you step aboard her teak decking, luxurious space is a constant companion. Her 17.80m<sup>2</sup> flybridge enjoys a convertible sunbed, twin helm seats, a wetbar and ergonomic dining areas. Vast panoramic saloon windows and signature wrap around front screens offer uninterrupted vistas from the main deck whilst expansive hull windows generously flood her accommodation areas with light. This oasis of calm can then be propelled to a top speed approaching 33 knots, and all with nimble composure. Magnificent performance and uncompromising comfort in equal measure.





The F55 interior has an architectural presence and elegantly uses contrasting surfaces whilst retaining the elegance that Princess interiors are renowned for. Her spacious saloon features a U-shaped sofa opposite a twin sofa with the option of a folding leaf dining or coffee table in between. Below, both the master stateroom and forward cabin feature large double beds whilst the starboard guest cabin with two single beds can also be converted in to a double. There is also the option for a single bed aft cabin.





TAKE A VIRTUAL TOUR OF THE F55





**F55**  
SPECIFICATION

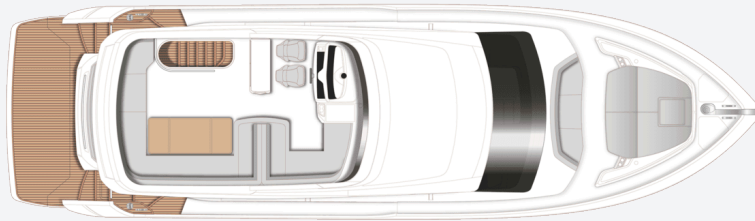

F55 Flybridge

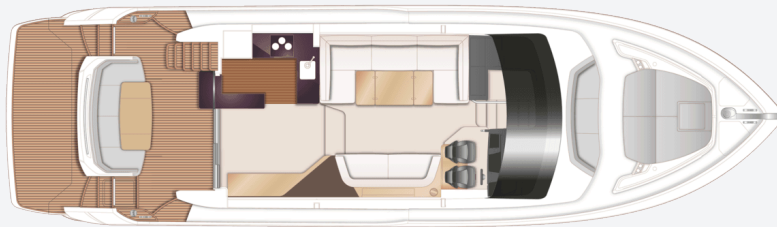

F55 Main Deck

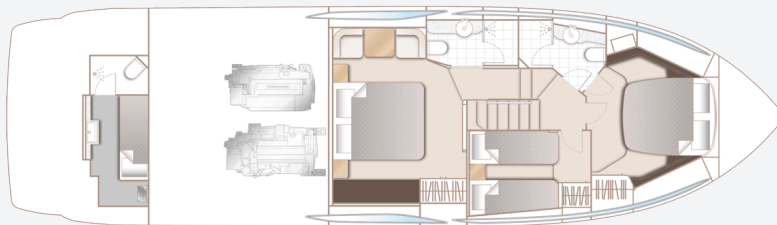

F55 Lower Deck

#### PRINCIPAL DIMENSIONS

<b>Length overall (incl. pulpit)</b>	57ft 9in (17.6m)
<b>Length overall (excl. pulpit)</b>	56ft 7in (17.24m)
<b>Beam</b>	16ft 0in (4.87m)
<b>Draft</b>	4ft 10in (1.46m)
<b>Displacement approx. (half-load)</b>	29,582kg
<b>Fuel capacity</b>	605 gal/726 US gal/2,750l
<b>Water capacity (incl. calorifier)</b>	134 gal/161 US gal/608l

#### ENGINES

<b>Twin Volvo D13-800 (2 x 800hp)</b>	Speed range: 30-32 knots <sup>†</sup>
---------------------------------------	--



## FULL SPECIFICATION

---

### DECK FITTINGS

- 6mm teak-laid transom platform, cockpit deck, flybridge stairway and steps to side deck
- Lewmar reversible electric anchor winch with foredeck and helm position controls
- Stemhead roller with automatic anchor launch and retrieve
- Self-stowing (25kg/55lb) Delta anchor with 40m of 9.5mm chain
- Bow rope storage locker
- Freshwater deck/anchor wash
- Deck storage locker for fenders and ropes
- Stainless steel bow, stern and spring cleats (8)
- Stainless steel pulpit and guardrails
- Stainless steel coachroof handrails
- Foredeck hatch
- PVC rubbing band with stainless steel insert
- LED deck level lighting
- Illuminated crown logo to transom
- Full set of IMCO navigation lights
- Riding light
- Searchlight with remote control
- Twin electric horns

- Loudhailer
- Fuel and water fillers

### COCKPIT AND BATHING PLATFORM

- Self draining
- U-shaped seating/dining area with folding teak table
- LED overhead and deck level lighting
- Stainless steel handrails
- Rope stowage locker
- Lockable gas strut assisted hatch to lazarette/engine room
- Lockable gas strut assisted hatch to lazarette/optional crew cabin
- Locker containing remote fuel cocks, manual bilge pump with valve chest and manual controls for automatic fire extinguishers
- Twin transom doors leading to bathing platform
- Retractable bathing ladder (manual) in side of bathing platform
- Transom steps to access stern from bathing platform when in lowered position
- Hot and cold transom shower

- 220/240v shore support inlet in locker
- Cockpit cover

### FLYBRIDGE

- Dual station instrumentation and controls with 16" Garmin screen displaying engine instrumentation, fuel gauges, rudder position indicator and chartplotter (either individual or combined)
- Volvo engines have a 7" display for engine instrumentation at both control positions. A 4" multifunction display for log, echo sounder and other instrumentation is also fitted although these can also be displayed on the main 16" display as required. The 16" screen incorporates Volvo software to allow engine instrumentation and autopilot function displays, (as well as the 7" display). If a second 16" screen is ordered the engine instrumentation display is fitted immediately in front of the helm position with the standard 16" screen to port
- Adjustable steering wheel
- Top loading coolbox adjacent to helm

- Audible and visual alarm for bilge pumps
- Twin helm seats with fore and aft adjustment for helmsman
- L-shaped upholstered seating (converts to sunbed)
- U-shaped upholstered seating area
- Teak folding table
- Radio/iPod/MP3 player with waterproof speakers
- Wetbar including sink, stowage and optional electric barbecue
- Clear view hatch to aft cockpit
- Wind deflector screens
- Stainless steel handrails
- LED deck level lighting
- GRP radar arch
- Matched whip aerials for VHF R/T and radio
- Liferaft stowage
- Console and seat covers
- Optional GRP hardtop with/without electric opening section (or optional folding bimini with optional electro-hydraulic operation)

#### **HELM POSITION**

- Twin leather-upholstered helm seats with manual fore and aft adjustment for helmsman

- Instrument console with 16" Garmin screen displaying engine instrumentation, fuel gauges, rudder position indicator, autopilot functions and chartplotter
- 7" Volvo display for engine instrumentation and autopilot functions. If a second 16" screen is ordered it will be fitted immediately in front of the helm position with the engine instrumentation display to starboard
- Dual station instruments and controls at Flybridge and Lower Helm Positions:
  - power-assisted electric steering with Volvo joystick control
  - adjustable steering wheel
  - high-speed magnetic compass
  - electronic engine controls
  - trim tab controls with indicators
  - bow thruster control
  - electric anchor winch remote control
  - autopilot
  - speed and distance log
  - echo sounder with alarm
  - VHF with DSC R/T with intercom
  - remote control searchlight
  - horn button
  - teak footrest

- Drinks holders
- Toughened glass screen (clear for night vision)
- Windscreen wipers with freshwater windscreen wash
- Exterior black mesh sunscreens windscreen covers
- Bilge pump controls with visual pump running warnings
- 24v and 240v electrical control panel
- Riding light, helm and navigation light control switches
- USB charging point (1)
- LED overhead lighting (24v) and night lighting
- Electric drop window
- Fitted carpet

#### **SALOON**

- U-shaped sofa
- Electric drop window to port
- Folding leaf dining table or coffee table
- Two-seater sofa
- Crockery storage drawer
- Sideboard unit
- 49" UHD LED TV on rise and fall
- Radio/DVD/MP3 player connected to Fusion 6" speakers (2)

- Blinds or sunscreens to all windows and doors
- LED overhead and concealed lighting (24v)
- Stairway to lower accommodation
- Fitted carpet

### **GALLEY**

- Solid surface worktop in Sylmar White
- 4-zone ceramic hob
- Hob extractor fan
- Combination microwave/convection oven with grill
- Stainless steel sink with mixer tap
- Full height fridge/freezer (270l)
- Waste bin
- Drawers and storage cupboards
- Sideboard unit with bottle and glass storage
- Refrigerator
- Stainless steel framed sliding door to cockpit with integrated hinging window aft of galley
- Blinds or sunscreens to all windows and doors
- LED overhead and task lighting (24v)
- 220/240v outlets (4)
- Planked timber flooring

### **ACCOMMODATION**

- All cabins and bathrooms feature opening

portholes

- All cabins feature 220/240v power points
- All bathrooms feature electric freshwater toilets and 240v shaver points

### **OWNER'S STATEROOM**

- Large double bed with drawers below
- Twin bedside tables
- Wardrobe with shelves and mirror
- Dressing table
- Pull out mirror to vanity unit
- Occasional table with seats fore and aft
- Storage lockers and drawers
- Radio/ Wi-Fi/Bluetooth player connected to Fusion 6" speakers (2)
- Panoramic windows including opening porthole
- Manual tension venetian blinds to hull windows
- LED overhead and concealed lighting (24v)
- Individual berth lights
- 220/240v outlets (2)
- USB charging point (1)
- Fitted carpet

### **EN-SUITE BATHROOM**

- Washbasin with solid surface worktop
- Mirror

- Storage lockers
- Shower compartment with automatic pump out
- Extractor fan
- Window with opening porthole
- Manual tension venetian blind
- LED overhead and concealed lighting (24v)
- Bathroom accessories
- Solid surface flooring

### **FORWARD STATEROOM**

- Large double bed with drawers below
- Wardrobe with shelves and mirror
- Dressing table
- Mirror to vanity unit
- Storage lockers
- Window with opening porthole
- Manual tension venetian blind
- Deck hatch
- LED overhead and concealed lighting (24v)
- Individual berth lights
- 220/240v outlets (2)
- USB charging point (1)
- Fitted carpet

### **EN-SUITE BATHROOM**

- Washbasin with solid surface worktop

- Mirror
- Storage lockers
- Shower compartment with automatic pump out
- Extractor fan
- Window with opening porthole and
- Manual tension venetian blind
- LED overhead and concealed lighting (24v)
- Bathroom accessories
- Solid surface flooring

#### **STARBOARD GUEST CABIN**

- Two single beds with drawers below (with option of double bed conversion)
- Bedside table
- Wardrobe with shelves
- Mirror
- Storage lockers and drawers
- Window with opening portholes and
- Manual tension venetian blind
- LED overhead and concealed lighting (24v)
- Individual berth lights
- 220/240v outlets (2)
- USB charging point (1)
- Fitted carpet

#### **OPTIONAL AFT CABIN (IN PLACE OF AFT LAZARETTE)**

- Single bed with storage below
- Wardrobe with shelf
- Mirror
- LED overhead lighting (24v)
- Individual berth lights
- 220/240v outlet (1)
- Fitted carpet

#### **EN-SUITE BATHROOM**

- Washbasin with solid surface worktop (in main cabin area)
- Storage lockers
- Opening porthole
- Shower with automatic pump out
- Extractor fan
- LED overhead lighting (24v)
- Bathroom accessories

#### **POWER AND DRIVE SYSTEMS**

- 5-bladed propellers in nickel aluminum bronze
- Bow thruster is (130kgF/286lbF) with dual-station controls
- Engine room lighting
- Engine room access hatch and ladder

- Power-assisted electro-hydraulic steering system
- Trim tabs with indicators
- Electronic engine and gear shift controls
- Engine room extractor fans with electronic time delay
- Fresh water supply point in engine room
- Dripless self aligning shaft seals

#### **ELECTRICAL SYSTEMS**

24 Volt:

- 4 x heavy duty batteries for engine starting
- 4 x heavy duty auxiliary batteries
- Battery link facility with remote control at helm position
- Both battery banks are charged using a voltage sensitive relay that parallels both battery banks when a charging source is present
- 60 amp battery charger
- Remote battery master switches with control switch at main switch panel
- Circuit breakers on all circuits
- 12v voltage dropper for certain navigation and radio circuits

220/240 Volt:

- 9.5Kw diesel generator in own sound shield with water cooled specially silenced exhaust
- Automatic fire extinguisher situated in the Engine room
- 50-amp shore support inlet
- Generator/shore support change-over switch
- Polarity check system
- Earth leakage safety trip
- Circuit breakers on all circuits
- Power points in: owner's stateroom, guest cabins, galley and saloon area
- Shaver points in all bathrooms

#### **FUEL SYSTEM**

- Twin fuel tanks (in NS8 marine grade alloy) with interconnection system giving 605gal / 726 US gal / 2,750l capacity
- Fuel fillers on port and starboard side decks
- High-capacity duplex fuel filters with water traps with change-over valves
- Water warning sensors connected to warning lights at lower helm
- Remote fuel cocks in cockpit locker
- Fuel gauges at main helm console

#### **WATER SYSTEM**

- Water tanks totalling 118 gal / 141 US gal / 535l plus 16 gal / 19 US gal / 73l hot water calorifier
- Water heated by engines and 240v immersion heater
- Automatic water pump with filter
- Main circuit breaker at switch panel
- Water level gauge
- Deck filler
- Electric freshwater toilet system with 69 gal / 83 US gal / 315l holding tank, content gauge and manual overboard discharge, with macerator backup system as well as dockside discharge system

#### **FIRE EXTINGUISHERS**

- Automatic/manual override fire extinguishers in engine room with warning system at helm position
- Hand-operated fire extinguishers (5) in owner's stateroom, forward and starboard guest cabin, galley and helm position
- Additional extinguisher fitted when optional aft cabin is specified

#### **BILGE PUMPS**

- Automatic/manual override electric bilge pumps in engine room (2), lazarette and forward accommodation (5 in all)
- High-capacity manual bilge pump with valve system and suction points in same areas
- Electric bilge pumps have controls and warning lights at main helm and warning light with audible alarm at flybridge helm

#### **OTHER STANDARD EQUIPMENT**

- Ensign staff
- Fenders (6)
- Mooring warps (4)
- Boat hook
- First Aid kit
- Tool kit
- Owner's manual and engine manual
- Quilted bedspreads supplied to all cabins (except optional crew cabin)
- Ship's document case
- Anchor winch back up handle

#### **FINISHES**

- Teak-laid decks to transom platform, steps to side decks, cockpit deck and steps to flybridge

- Timber-laid floor to galley area
- Furniture in choice of Rovere Oak or Alba Oak in satin lacquer finish as standard. Silver Oak or Walnut in satin or gloss lacquer finishes available as an option.
- Solid surface floors in all bathroom suites in guest accommodation
- Solid surface wash hand basin and counter tops in all bathrooms
- Galley worktop in solid surface finish
- Choice of high-quality carpet and upholstery fabric from extensive range
- Blinds or sunscreens to all windows and portholes
- Optional crew cabin has non-slip safety flooring with carpet and crew bathroom has white solid surface countertops

# GLOBAL COVERAGE

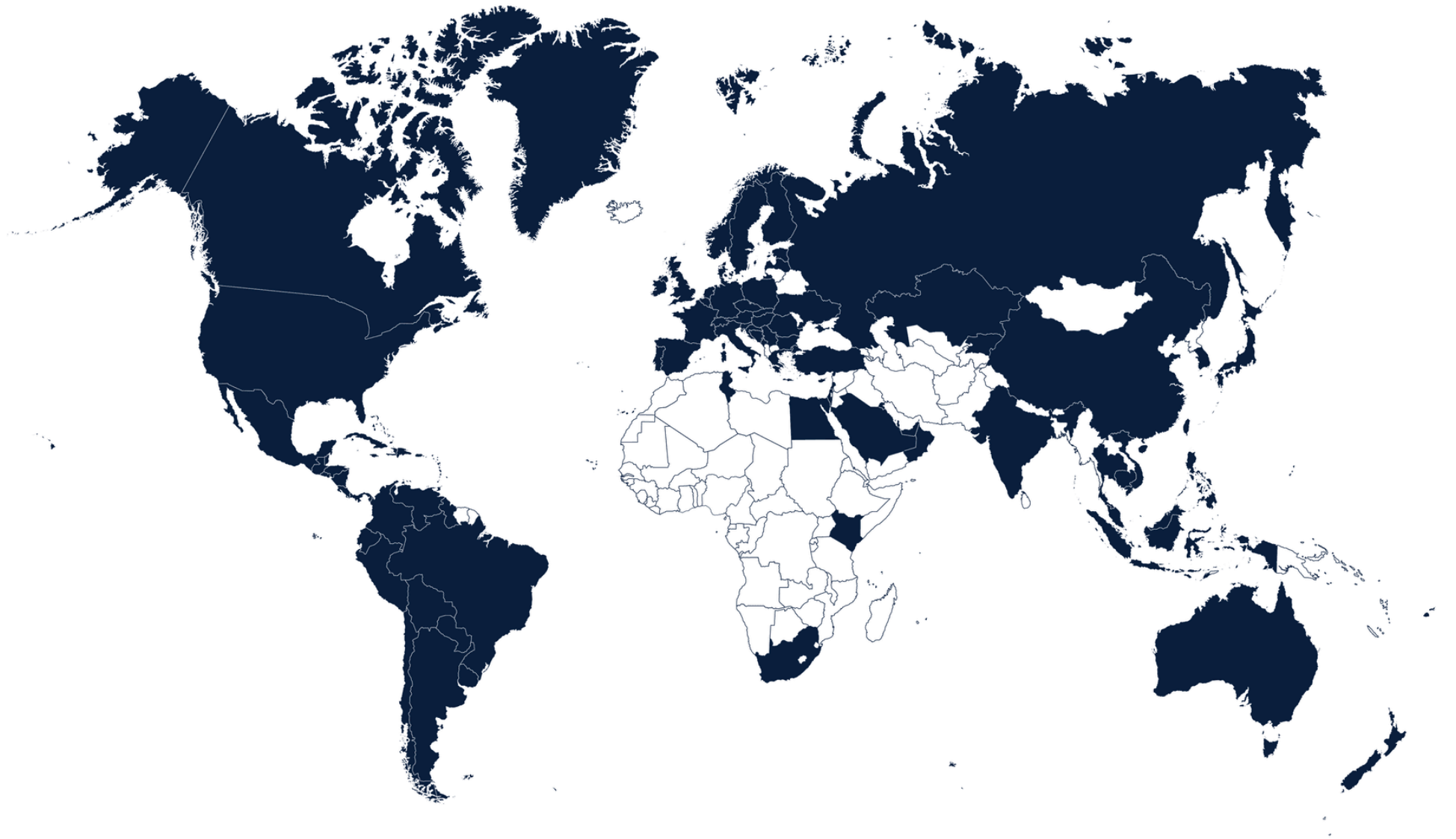



## THANK YOU

For more information or to find a distributor,  
please visit our [website](#).