

F 65





The all-new F65 boasts a contemporary use of layout featuring the latest geometric design elements. Focussed around a sociable use of space she provides accommodation for eight guests across four cabins. Vast panoramic saloon windows and signature wrap around front screens offer uninterrupted vistas from the main deck whilst elongated hull windows generously flood her accommodation areas with light. The expansive main deck is segmented into an aft galley with dinette, saloon with large U-shaped sofa plus companion seating opposite the helmsman area which features a side access door to the deck.







The foredeck provides the perfect spot to enjoy outdoor relaxation with split sunpads and the ability to include an integrated cool box.

Her contemporary flybridge is the perfect outdoor entertaining area, with ergonomic dining seating, wetbar with barbecue, coolbox and sink, plus an aft sunbed and L-shaped companion seat with infill as a secondary sunbed.





TAKE A VIRTUAL TOUR OF THE F65







**F 65**  
SPECIFICATION

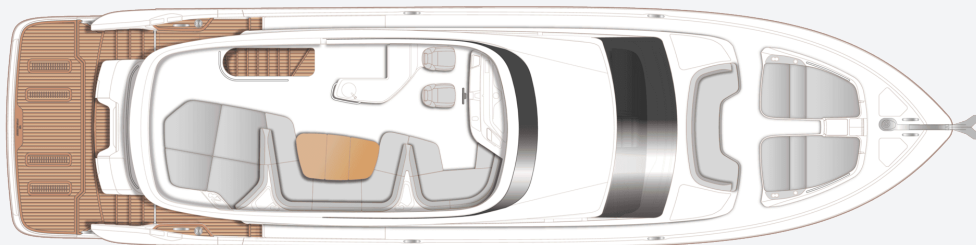

F65 Flybridge

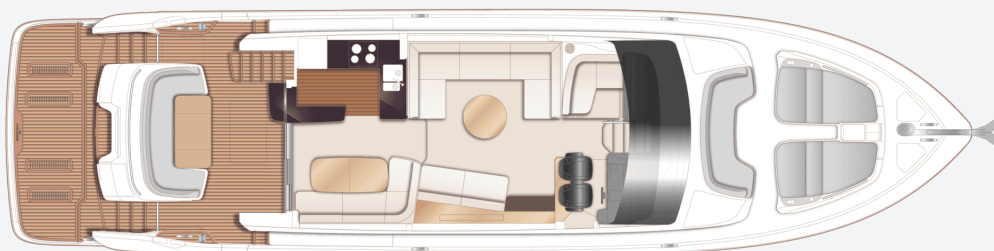

F65 Main Deck

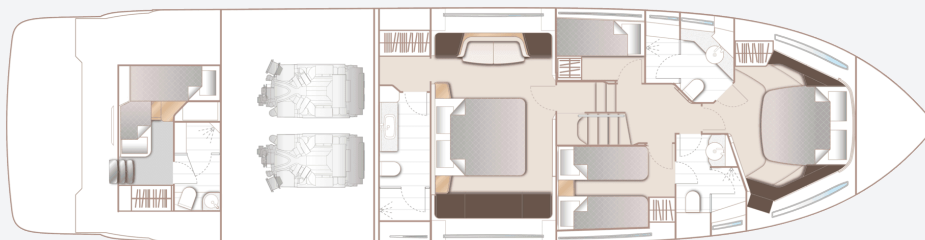

F65 Lower Deck

#### PRINCIPAL DIMENSIONS

<b>Length overall (incl. pulpit)</b>	66ft 7in (20.30m)
<b>Length overall (excl. pulpit)</b>	65ft 8in (20.03m)
<b>Beam</b>	16ft 9in (5.10m)
<b>Draft</b>	5ft 4in (1.63m)
<b>Displacement approx. (lightship)</b>	40,177kg (88,575lbs)*
<b>Fuel capacity</b>	902 gal/1,083 US gal/ gal/4,100l
<b>Water capacity (excl. calorifier)</b>	172 gal/211 US gal/ 800l

#### ENGINES

<b>Twin MAN V8 1200 (2 x 1,200hp)</b>	Speed range: 31-33 knots†
---------------------------------------	------------------------------

## FULL SPECIFICATION

---

### DECK FITTINGS

- Teak-laid transom platform, transom steps, cockpit deck, flybridge stairway and steps to side deck
- Reversible electric anchor winch with foredeck and helm position controls
- Stemhead roller with automatic anchor launch and retrieve
- Self-stowing anchor system incorporating one Lewmar Delta anchor (40kg/88lb) with 60m of 9.5mm chain
- Bow rope storage locker
- Freshwater deck/anchor wash
- Deck storage lockers for fenders
- Stainless steel forward fairleads (2)
- Stainless steel stern fairleads (2)
- Cast stainless steel bow, stern and spring cleats (8)
- Stainless steel pulpit and guardrails (32mm round)
- Stainless steel coachroof handrails
- PVC rubbing band with stainless steel insert
- LED deck level lighting

- Illuminated crown logo on transom
- Full set of IMCO navigation lights
- Riding light
- Searchlight with remote control
- Loudhailer (connected to VHF)
- Twin electric horns
- Fuel and water fillers
- Foredeck escape hatch
- Walk through foredeck seating area
- Foredeck sunbathing area with twin sunbeds including cushions with integrated storage and drinks holders (4)

### COCKPIT AND BATHING PLATFORM

- Self-draining cockpit
- U-shaped seating/dining area with folding teak table and drinks holders
- Upholstered cockpit headlining panels
- LED overhead and deck level lighting
- Integral stairway to flybridge
- Stainless steel handrails
- Liferaft stowage locker
- Rope stowage lockers

- Starboard lightweight pantograph door for access to lazarette/optional crew cabin
- Lockable gas strut assisted hatch to secondary port side lazarette
- Lockable gas strut assisted hatch to engine room
- Lockable wet locker accessed from port side transom hatch (accepts optional SEABOB (x2) storage and charging rack)
- Locker containing remote fuel cocks, manual bilge pump with valve chest and manual controls for automatic fire extinguishers
- Twin transom doors leading to bathing platform
- Transom seat in teak
- Ensign socket and transom grab rail
- Electro-hydraulic raise/lower teak laid bathing platform (500kg SWL)
- Retractable bathing ladder (manual) in side of hydraulic platform
- Transom steps to access stern from bathing platform when in lowered position
- Hot and cold transom shower
- 220/240v shore support inlet in locker



- Cockpit cover

## **FLYBRIDGE**

- Dual station instrumentation and controls (see Helm Position)
- Drinks holders (2) and storage locker tray
- 16" colour multifunctional display screen incorporating GPS/chartplotter, log and echo sounder
- 9" multifunctional display screen incorporating engine instrumentation (including fuel levels and fuel flow)
- Adjustable steering wheel
- Audible and visual alarm for bilge pumps
- Wind deflector screens (grey tinted perspex)
- Separate helm and navigator seats with fore and aft adjustment for helmsman
- L-shaped upholstered companion seating area with infill for conversion to sunbed (storage for infill below)
- Storage tray behind flybridge L-shaped seating with drinks holders
- U-shaped upholstered seating area and storage below
- Storage tray behind flybridge U-shaped

- seating with drinks holders
- Teak dining table with removable leaf
- Walkaround sunpad aft, drinks holders and storage below
- Fusion Apollo MS-SRX400 audio system paired with Fusion Signature 7.7" waterproof speakers (2)
- L-shaped wetbar including sink with electric barbecue, top loading coolbox and waste bin
- Clear view hatch to aft cockpit
- Stainless steel handrails
- LED deck level lighting
- GRP radar arch
- Matched whip aerials for VHF R/T and radio
- Console, seat, wet bar and table covers
- Optional GRP hardtop with/without electric opening section (or optional folding bimini with optional electro-hydraulic operation)
- USB-A charging point (2)

## **HELM POSITION**

- Twin helm seats with fore and aft adjustment for helmsman, F-logo to helm seat, flip up base to helm seat for door access

- Instrument console with controls incorporating engine instruments and fuel gauges
- Dual station instruments and controls at Flybridge and Lower Helm Positions:
  - 16" colour multifunction display incorporating GPS/chartplotter, log, echo-sounder
  - 9" multifunction display screen incorporating engine instrumentation (including fuel levels and fuel flow)
  - power-assisted electro-hydraulic steering
  - adjustable steering wheel
  - rudder position indicator
  - high-speed magnetic compass
  - electronic engine controls
  - trim tab controls with indicators
  - bow thruster control
  - electric anchor winch remote control
  - autopilot
  - VHF with DSC R/T with intercom
  - remote control searchlight
  - horn button
- Drinks holders
- Small storage tray
- Toughened glass screen (clear for night vision)
- Windscreen wipers with freshwater windscreen wash

- Exterior black mesh sunscreens
- Bilge pump controls with visual pump running warnings
- 24v and 240v electrical control panel
- Riding light, helm and navigation light control switches
- USB charging points (4)
- 220/240v outlet (1)
- LED overhead lighting (24v) and night lighting
- Pantograph helmsman's side door to starboard side deck
- Fitted carpet

### **SALOON**

- U-shaped sofa with storage drawers
- Coffee table
- Two-seater sofa with storage
- L-shaped seat with storage opposite helm area
- Electric opening window to port
- Bottle and glass storage below helm seat
- Sideboard with refrigerator (80l)
- 55" TV on rise and fall
- Fusion Apollo MS-RA770 audio system paired with Focal 100ICW6 speakers (2)
- Manual tension venetian blinds to all

- windows and doors
- LED overhead and concealed lighting (24v)
- Access stairway to lower accommodation
- Fitted carpet
- 220/240v outlets (2)

### **DINING AREA**

- L-shaped sofa
- Folding dining table/drinks holders and crockery drawer
- Stainless steel framed sliding door to cockpit, three panes with integrated hinging window aft of galley (one fixed pane, one sliding pane, one flip up window) and integrated Skysol blinds
- Manual tension venetian blinds to windows
- LED overhead and concealed lighting (24v)
- Fitted carpet
- 220/240v outlets (2)

### **GALLEY**

- Solid surface countertop
- 4-zone ceramic hob
- Hob extractor fan
- Combination microwave/convection oven with grill
- Full height fridge/freezer (281l)

- 1.5 bowl solid surface sink with mixer tap
- Waste bin
- Drawers and storage cupboards
- Manual tension venetian blinds to windows
- LED overhead and task lighting (24v)
- 220/240v outlets (4)
- Timber flooring (V-groove planked)

### **ACCOMMODATION**

- All cabins and bathrooms (excluding crew bathroom) feature opening portholes
- All cabins feature 220/240v power points
- All bathrooms (excluding crew bathroom) feature 240v shaver points
- All bathrooms feature electric freshwater toilets

### **OWNER'S STATEROOM**

- Large double bed with drawers below
- Twin bedside tables
- Walk-through wardrobe area with hanging, drawer storage and full-length mirror
- Dressing table
- Sofa
- Storage lockers and drawers
- 43" TV
- Fusion Apollo MS-RA770 paired with Focal



- 100ICW6 speakers (2)
- Panoramic windows including opening porthole
- Manual tension venetian blinds
- LED overhead and concealed lighting (24V)
- Individual berth lights
- 220/240v outlets (4)
- USB charging point (4)
- Fitted carpet

#### **EN-SUITE BATHROOM**

- Wash basin with solid surface vanity top
- Mirror to vanity unit
- Storage lockers
- Shower compartment with automatic pump out
- Extractor fan
- Window with opening porthole
- Manual tension venetian blind
- LED overhead lighting (24v)
- Bathroom accessories
- Solid Surface flooring

#### **FORWARD STATEROOM**

- Large double bed with drawers below
- Wardrobe with shelves and full-length mirror

- Dressing table
- Storage lockers
- Windows with opening portholes
- Manual tension venetian blind
- Deck hatch
- LED overhead lighting (24v)
- Individual berth lights
- 220/240v outlets (3)
- USB charging points (4)
- Fitted carpet

#### **EN-SUITE BATHROOM**

- Washbasin with solid surface vanity top (thermo-formed)
- Mirror
- Storage lockers
- Shower compartment with automatic pump out
- Extractor fan
- Window with opening porthole
- Manual tension venetian blind
- LED overhead lighting (24v)
- Bathroom accessories
- Solid surface flooring

#### **STARBOARD GUEST CABIN**

- Two single beds with drawers below (with option of sliding double bed conversion)
- Bedside table
- Wardrobe with shelves
- Mirror
- Storage lockers and drawers
- Window with opening portholes
- Manual tension venetian blind
- LED overhead lighting (24v)
- Individual berth lights
- 220/240v outlet (1)
- USB charging points (2)
- Fitted carpet

#### **EN-SUITE BATHROOM**

- Wash basin with solid surface vanity top (thermo-formed)
- Mirror
- Storage lockers
- Shower compartment with automatic pump out
- Extractor fan
- Window with opening porthole
- Manual tension venetian blind
- LED overhead lighting (24v)

- Bathroom accessories
- Solid surface flooring
- Day access door from lower lobby

#### **PORT GUEST CABIN**

- Two single beds
- Wardrobe with shelf
- Mirror
- Storage lockers
- Window with opening portholes
- Manual tension venetian blind
- LED overhead lighting (24v)
- Individual berth lights
- 220/240v outlet (1)
- USB charging points (2)
- Fitted carpet

#### **LOBBY AREA**

- Combination washer /dryer with storage area above located below companionway stairs (option of separate washing and drying machines if required)
- Fitted carpet
- LED overhead and concealed lighting (24v)

#### **OPTIONAL CREW CABIN (IN PLACE OF AFT LAZARETTE)**

- Furniture in specified choice of boat timber
- Single bed with storage below (optional second bunk available)
- Lockers with shelf
- Mirror
- Opening porthole
- Transom glazing with venetian blind
- Lightweight pantograph door with access from transom
- LED overhead lighting (24v)
- Individual berth lights
- 220/240v outlet (1)
- USB Charging points (2)
- Fitted Carpet
- En-suite bathroom
- Bathroom in white laminate
- Washbasin with solid surface vanity top
- Storage lockers
- Shower with automatic pump out
- Extractor fan
- LED overhead lighting (24v)
- Bathroom accessories
- Solid Surface flooring

#### **POWER AND DRIVE SYSTEMS**

- Propeller shafts in Marinemet
- 5-bladed propellers in nickel aluminium bronze
- Bow thruster (170kgf/375lbf) with dual-station controls
- High speed balanced rudders
- Power-assisted electro-hydraulic steering system
- Trim tabs with indicators
- Cathodic protection for sterngear
- Sterngear, engines, fuel tank fillers, etc all electrically bonded
- Forward and aft engine room bulkheads and engine room headlining to be integrally bonded including insulation with acoustafoam layers
- High volume air intakes
- Engine room extractor fan with electronic time delay
- Engine exhaust silencers and water-cooled exhausts
- Engine beds integrally moulded with hull for strength and vibration absorption
- Engines flexibly mounted
- Automatic fire extinguisher with remote



override control

- Automatic and manual bilge pumps
- Engine room lighting
- Engine room access hatch and ladder
- Electronic engine and gear shift controls
- Fresh water supply point in engine room
- Dripless self-aligning shaft seals

### **ELECTRICAL SYSTEMS**

24 Volt:

- 4 x heavy duty batteries for engine starting
- 4 x heavy duty auxiliary batteries
- Battery link facility with remote control at helm position
- Both battery banks are charged using a voltage sensitive relay that parallels both battery banks when a charging source is present
- 80-amp battery charger charges both banks of batteries via an automatic switch charging system
- 6-amp battery charger for generator battery
- Remote battery master switches with control switch at main switch panel
- Circuit breakers on all circuits
- 12v voltage dropper for certain navigation

and radio circuits

220/240 Volt:

- 11 kW diesel generator in own sound shield with water cooled specially silenced exhaust
- Automatic fire extinguisher situated by generator
- 60-amp shore support inlet
- 6-amp battery charger for generator battery
- Generator/shore support change-over switch
- Polarity check system
- Earth leakage safety trip
- Circuit breakers on all circuits
- Power points in: Owner's stateroom, guest cabins, galley and saloon area
- Shaver points in all bathrooms (excluding crew)

### **FUEL SYSTEM**

- Twin fuel tanks (in NS8 marine grade alloy) with interconnection system giving 902 gal/1,083 US gal/4,100l capacity
- Fuel fillers on port and starboard side deck steps
- High-capacity duplex fuel filters with water

traps with change-over valves, water warning sensors connected to warning lights at lower helm

- Remote fuel cocks in cockpit locker
- Fuel gauges at main helm console (via multifunctional display)

### **WATER SYSTEM**

- Water tanks totalling 176 gal/211 US gal/800l plus 16 gal/19 US gal/73l hot water calorifier
- Water heated by engines and 240v immersion heater
- Automatic water pump with filter
- Main circuit breaker at switch panel
- Water level gauge
- Deck filler
- Electric freshwater toilet system with 60 gal/72 US gal/272l holding tank, content gauge and manual overboard discharge, with macerator backup system as well as dockside discharge system

### **FIRE EXTINGUISHERS**

- Automatic/manual override fire extinguishers in engine room with warning system at helm position
- Hand-operated fire extinguishers (6) in owner's stateroom, forward, port and starboard guest cabins, galley and helm position
- Additional extinguisher fitted when optional aft cabin is specified

### **BILGE PUMPS**

- Automatic/manual override electric bilge pumps in engine room (2), rudder area, lazarette and forward accommodation (6 in all)
- High-capacity manual bilge pump with valve system and suction points in same areas
- Electric bilge pumps have controls and warning lights at main helm and warning light with audible alarm at flybridge helm

### **OTHER STANDARD EQUIPMENT**

- Ensign staff
- Fenders (6)
- Mooring warps (4)

- Boat hook
- First-aid kit
- Tool kit
- Owner's manual and engine manual
- Functional bed linen (fitted bottom sheet, loose top sheet and oxford pillowcases) supplied to all cabins (including optional crew cabin, where specified)
- Set of glassware (8 settings consisting of tumbler and wine glasses)
- Set of Princess china (8 settings consisting of plate, side plate, bowl, cup and saucer)
- Set of cutlery (8 settings of David Mellor "Paris" cutlery 7 pieces)
- Ship's document case
- Anchor winch back up handle
- F65 canopy badges

### **FINISHES**

- Teak-laid transom platform, transom steps, steps to side decks, cockpit deck and steps to flybridge
- Timber-laid floor (V-groove planked) to galley area and dining area
- Furniture in choice of Rovere Oak or Alba Oak in satin finish as standard. Silver Oak or

- Walnut in satin or gloss finish available as an option
- Solid surface floors in all bathroom suites in guest accommodation
- Solid surface wash hand basin vanity tops in all bathrooms
- Galley countertop in solid surface finish
- Choice of high-quality carpet and upholstery fabric from extensive range
- Exterior upholstery in white vinyl as standard, with optional upgrade to Comfort Exterior available
- Manual venetian blinds to all windows and portholes
- Optional crew cabin furniture in specified boat timber with fitted carpet. Crew bathroom has white solid surface vanity tops and floors





## THANK YOU

For more information or to find a distributor,  
please visit our [website](#).