



S62



Powerful yet elegant, the S62's sleek exterior styling presents a dynamic, agile stance. With an optimised hull form spearheading her efficiency, her MAN V8 1200 engines mean you can experience speeds up to 38 knots. When at anchor her electro-hydraulic bathing platform creates a convenient launch system for a 3.4m tender, a jet ski, or simply a secluded swimming platform.





Her sociable galley aft arrangement features an open-plan dining area with sliding doors and a fully opening window leading out to the cockpit. Below deck, six guests are comfortably accommodated across an en suite full-beam owner's stateroom and two further guest cabins with the option of an additional crew cabin aft.





Take a virtual tour of the S62





S62

Layouts and Specification

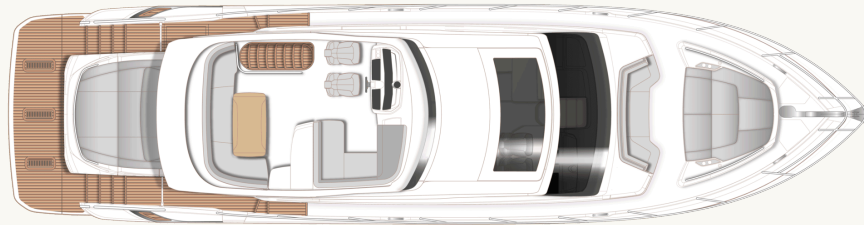

S62 Sportbridge



S62 Main Deck

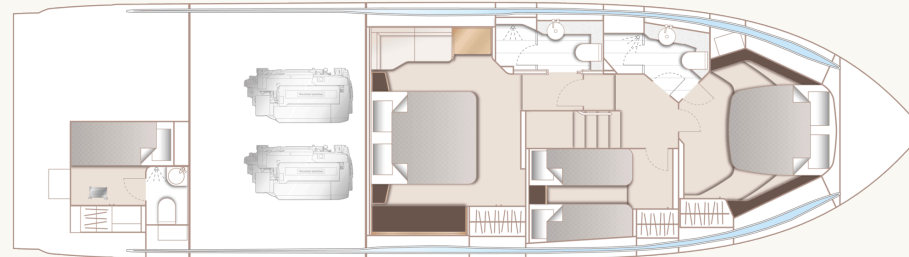

S62 Lower Deck

Principal Dimensions

Length overall (incl. pulpit)	62 ft 11 in / 19.17m
Length overall (excl. pulpit)	62 ft 1 in / 18.92m
Beam	16 ft 0 in / 4.87m
Draft	4 ft 9 in / 1.46m
Displacement approx.	28,760 kg / 63,405 lbs*
Fuel capacity	715 gal / 858 US gal / 3,250 l
Water capacity (excl. calorifier)	132 gal / 159 US gal / 603 l
Black water tank	55 gal / 66 US gal / 250 l

Engines - Diesel

Twin MAN V8-1200 (2 x 1,200mhp)	Maximum speed range – 36-38 knots [†]
---------------------------------	------------------------------------------------

Full Specification

Deck fittings

- Teak-laid transom platform, cockpit deck, sportbridge stairway and steps to side deck
- Reversible electric anchor winch with foredeck and helm position controls
- Stemhead roller with automatic anchor launch and retrieve
- Self-stowing (32kg/77lb) Delta anchor with 40m of chain
- Bow rope storage locker
- Freshwater deck/anchor wash
- Walk through coach-roof seating area
- Foredeck sunbathing area
- Deck storage locker for fenders and ropes
- Stainless steel bow, stern and spring cleats (8)
- Stainless steel pulpit and guardrails
- Stainless steel coach-roof handrails
- Foredeck hatch
- PVC rubbing band with stainless steel insert

- LED deck level lighting
- Full set of IMCO navigation lights
- Riding light
- Searchlight with remote control
- Illuminated crown logo to transom
- Twin electric horns
- Fuel and water fillers
- Ensign socket and staff

Cockpit and bathing platform

- Self-draining
- U-shaped seating/dining area with folding teak table
- Sunbed aft
- LED overhead and deck level lighting
- Stainless steel handrails
- Garage (to take tender up to 3.3m) with electro-hydraulic door and tender launch system with electric winch
- Lifteraft stowage locker
- Rope stowage lockers

- Lockable gas strut assisted hatch to lazarette
- Lockable gas strut assisted hatch to lazarette/optional crew cabin
- Lockable gas strut assisted hatch to engine room
- Locker containing remote fuel cocks, manual bilge pump with valve chest and manual controls for automatic fire extinguishers
- Twin transom doors leading to bathing platform
- Electro-hydraulic raise/lower teak laid bathing platform (450kg SWL)
- Retractable bathing ladder (manual) in side of hydraulic platform
- Transom steps to access stern from bathing platform when in lowered position
- Hot and cold transom shower
- Marine audio system with radio and streaming capabilities with waterproof speakers
- 220/240v shore support inlet in locker

- Tonneau canvas cover

Sportbridge

- Twin helm seats with fore and aft adjustment for helmsman
- Instrument console with dual station controls and 9" colour multifunctional display incorporating engine instruments, fuel gauges, alarms and rudder position indicator (see Lower Helm Position)
- 16" colour mfd screen incorporating GPS/ Chartplotter, log and echo sounder
- Adjustable steering wheel
- Drinks holders
- Wetbar with sink, storage, top loading coolbox and optional barbeque
- Aft L-shaped upholstered seating
- Teak folding table
- Upholstered L-shaped companion seating (converts to sunpad)
- Marine audio system with radio and streaming capabilities with waterproof speakers

- Clear view hatch to aft cockpit
- Wind deflector screens
- Stainless steel handrails
- LED deck level lighting
- GRP radar arch
- Matched whip aerials for VHF R/T and radio
- Console and seat covers
- Optional folding bimini with manual/ electro hydraulic operation

Helm position

- Twin helm seats with fore and aft adjustment for helmsman
- Instrument console with dual station controls and 9" colour multifunctional display incorporating engine instruments, fuel gauges, alarms and rudder position indicator
- 16" brilliant colour multi-function display incorporating GPS/chartplotter, log and echo sounder
- Dual station instruments and controls at Sportbridge and Lower Helm Positions:
 - power-assisted electro-hydraulic steering
 - adjustable steering wheel

- rudder position indicator
- high-speed magnetic compass
- electronic engine controls
- trim tab controls with indicators
- bow thruster control
- electric anchor winch remote control
- autopilot
- VHF with DSC R/T with intercom
- remote control searchlight
- horn button
- Drinks holders
- Toughened glass screen (clear for night vision)
- Windscreen wipers with freshwater windscreen wash
- Exterior black mesh windscreen covers
- Bilge pump controls with visual pump running warnings
- 24v and 240v electrical control panel
- Riding light, helm and navigation light control switches
- USB connection point
- LED overhead lighting (24v) and night lighting

- Electric drop window
- Timber flooring - V grooved planked

Saloon

- U-shaped sofa
- Coffee table
- Sideboard unit with bottle and glass storage
- Refrigerator
- 50" UHD LED TV on rise and fall
- Fusion Apollo MS-RA770 Audio stereo system paired with Focal 100 ICW5 speakers (4)
- Electric drop window to port
- Blinds or sunscreens to all windows and doors
- LED overhead and concealed lighting (24v)
- Access stairway to lower accommodation
- Skylights with reflecto-glass and sliding blinds (option of powered opening roof)
- Fitted carpet

Dining area

- L-shaped sofa

- Folding dining table
- Stainless steel framed sliding door to cockpit with integrated hinging window aft of galley
- Blinds or sunscreens to all windows and doors
- LED overhead and concealed lighting (24v)
- Timber flooring (planked)

Galley

- Solid surface counter top
- 4-zone ceramic hob
- Extractor fan
- Combination microwave/convection oven with grill
- Stainless steel sink with mixer tap
- Full height fridge/freezer (270l)
- Waste bin
- Drawers and storage cupboards
- Blinds or sunscreens to all windows and doors
- LED overhead and task lighting (24v)
- 220/240v outlets (4)
- Timber flooring (planked)

Accommodation

- All cabins and bathrooms feature opening portholes
- All cabins feature 220/240v power points
- All bathrooms feature electric freshwater toilets and 240v shaver points

Owner's stateroom

- Large double bed with drawers below
- Twin bedside tables
- Wardrobes with hanging and drawer storage
- Dressing table
- Mirror
- Sofa
- Storage lockers and drawers
- 43" UHD LED TV
- Fusion MS-RA670 audio system paired with Fusion 6" CL602 (2) speakers
- Panoramic windows including opening porthole
- Curtains or blinds
- LED overhead and concealed lighting (24v)

- Individual berth lights
- 220/240v outlets (2)
- USB charging point
- Fitted carpet

En-suite bathroom

- Wash basin with solid surface counter top
- Mirror
- Storage lockers
- Shower compartment with automatic pump out
- Extractor fan
- Window with opening porthole
- Manual tension venetian blind
- LED overhead and concealed lighting (24v)
- Bathroom accessories
- Solid surface flooring

Forward stateroom

- Large double bed with drawers below
- Wardrobe with shelves
- Dressing table
- Mirror

- Storage lockers
- Window with opening porthole
- Manual tension venetian blind
- Deck hatch
- LED overhead and concealed lighting (24v)
- Individual berth lights
- 220/240v outlets (2)
- USB charging point
- Fitted carpet

En-suite bathroom

- Wash basin with solid surface counter top
- Mirror
- Storage lockers
- Shower compartment with automatic pump out
- Extractor fan
- Window with opening porthole
- Manual tension venetian blind
- LED overhead and concealed lighting (24v)
- Bathroom accessories
- Solid surface flooring
- Access door from passageway

Starboard guest cabin

- Two single beds with drawers below (with option of double bed conversion)
- Bedside table
- Wardrobe with shelves
- Mirror
- Storage lockers and drawers
- Window with opening porthole
- Manual tension venetian blind
- LED overhead and concealed lighting (24v)
- Individual berth lights
- 220/240v outlets (2)
- USB charging point
- Fitted carpet

Optional crew cabin (in place of aft lazarette)

- Single bed with storage below
- Wardrobe with shelf
- Mirror
- Wash basin with solid surface counter top
- Storage lockers
- Opening porthole

LED overhead and concealed lighting (24v)

- LED overhead lighting (24v)
- Individual berth light
- 220/240v outlet (1)
- Non-slip safety flooring

En-suite bathroom

- Shower with automatic pump out
- Extractor fan
- LED overhead lighting (24v)
- Bathroom accessories

Power and drive systems

- 5-bladed propellers in nickel aluminium bronze
- Bow thruster (130kgf/287lbf) with dual-station controls
- Engine room lighting
- Engine room access hatch and ladder
- Power-assisted electro-hydraulic steering system
- Trim tabs with indicators
- Electronic engine and gear shift controls
- Engine room extractor fan with electronic

time delay

- Fresh water supply point in engine room
- Dripless self-aligning shaft seals

Electrical systems

24 Volt:

- 4 x heavy duty batteries for engine starting
- 4 x heavy duty auxiliary batteries
- 1 x generator battery
- Battery link facility with remote control at helm position
- Both battery banks are charged using a voltage sensitive relay that parallels both battery banks when a charging source is present
- 60 amp battery charger charges both banks of batteries via an automatic switch charging system
- Remote battery master switches with control switch at main switch panel
- Circuit breakers on all circuits
- 12v voltage dropper for certain navigation and radio circuits

and radio circuits

- Princess Connect telemetry and maintenance system

220/240 Volt:

- 11Kw diesel generator in own sound shield with water cooled specially silenced exhaust
- Automatic fire extinguisher situated by generator
- 50 amp shore support inlet
- Generator/shore support change-over switch
- Polarity check system
- Earth leakage safety trip
- Circuit breakers on all circuits
- Power points in: owner's stateroom, guest cabins, galley and saloon area
- Shaver points in all bathrooms

Fuel system

- Twin fuel tanks (in NS8 marine grade alloy) with interconnection system giving 715 gal / 858 US gal / 3,250l
- Fuel fillers on port and starboard side decks

- High-capacity duplex fuel filters with water traps with change-over valves, water warning sensors connected to warning lights at lower helm
- Remote fuel cocks in cockpit locker
- Fuel gauges at main helm console

Water system

- Water tanks totalling 116 gal / 159 US gal / 530l plus 16 gal / 19 US gal / 73l hot water calorifier
- Water heated by engines and 240v immersion heater
- Automatic water pump with filter
- Main circuit breaker at switch panel
- Water level gauge
- Deck filler
- Electric freshwater toilet system with 55 gal / 66 US gal / 250l holding tank, content gauge and low noise manual overboard discharge, with macerator backup system as well as dockside discharge system

Fire extinguishers

- Automatic/manual override fire extinguishers in engine room with warning system at helm position
- Hand-operated fire extinguishers (5) in owner's stateroom, forward and starboard guest cabins, galley and helm position
- Additional extinguisher fitted when optional aft cabin is specified

Bilge pumps

- Automatic/manual override electric bilge pumps in engine room (2), rudder area, lazarette and forward accommodation (6 in all)
- High-capacity manual bilge pump with valve system and suction points in same areas
- Electric bilge pumps have controls and warning lights at main helm and warning light with audible alarm at sportbridge helm

Other standard equipment

- Ensign staff
- Fenders (6)
- Mooring warps (4)
- Boat hook
- First-aid kit
- Tool kit
- Owner's manual and engine manual
- Quilted bed covers supplied to all cabins (except optional crew cabin)
- Ship's document case
- Anchor winch back up handle

Finishes

- Teak-laid decks to transom platform, steps to side decks, cockpit deck steps to sportbridge, sportbridge and steps to side decks
- Timber-laid floor to galley and dining area, planked
- Furniture in Rovere oak with satin finish as standard. Optional finishes include ash or silver oak with a satin finish or walnut wood

in a satin or gloss finish

- Solid surface floors in all bathroom suites in guest accommodation
- Solid surface counter tops in all bathroom suites in guest accommodation
- Galley counter top in solid surface
- Choice of high-quality carpet and upholstery fabric from extensive range
- Blinds or sunscreens to all windows and portholes
- Optional crew cabin has non-slip safety flooring, crew bathroom has white solid surface counter tops