

V40





The V40 quintessentially showcases the sleek exterior, performance and exceptional seakeeping of the Princess V Class range. Her port light windows cascade across the length of her deep-V hull, flooding the saloon and cabins with natural light. When entertaining, her spacious cockpit provides the perfect setting with the option to specify a convertible sunbed aft.









Below deck, her interior design depicts the modern V Class look throughout. Her spacious saloon and well equipped galley combine for a highly sociable entertaining space, while both cabins exude contemporary style and generous proportions. The forward cabin has an en-suite bathroom with secondary access to the saloon whilst the aft cabin can be fitted with optional sliding berths to provide easy conversion to a double bed when required.









EXPERIENCE THE V40





TAKE A VIRTUAL TOUR OF THE V40







**V40**  
SPECIFICATION



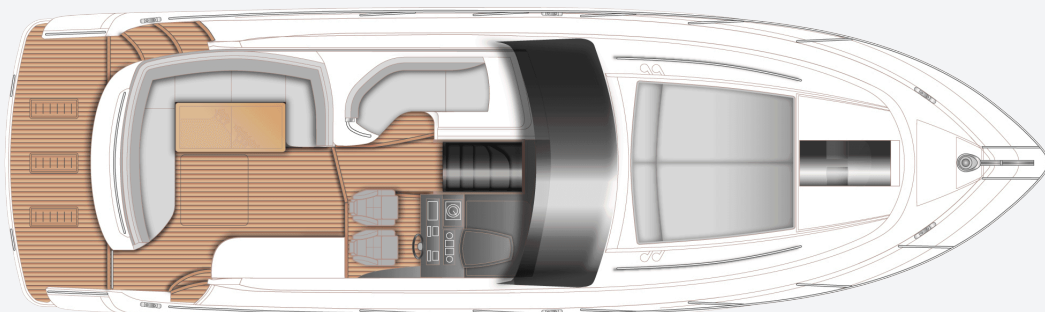

V40 Main Deck

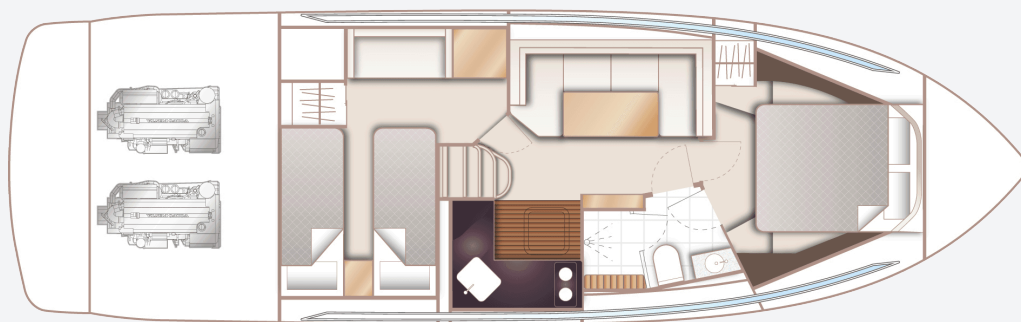

V40 Lower Deck

## PRINCIPAL DIMENSIONS

<b>Length overall (incl. pulpit)</b>	42ft 6in (12.98m)
<b>Length overall (excl. pulpit)</b>	41ft 6in (12.65m)
<b>Beam</b>	12ft 5in (3.81m)
<b>Draft (Drives lowered)</b>	3ft 4in (1.02m)
<b>Displacement approx. (half load)</b>	10,145 kg (22,366 lbs)
<b>Fuel capacity</b>	160 gal/192 US gal/ 730l
<b>Water capacity (incl. calorifier)</b>	71 gal/85 US gal/ 322l

## ENGINES

<b>Twin Volvo D6-340 (2 x 340mhp)</b>	Speed range: 34-36 knots <sup>†</sup>
---	--



## FULL SPECIFICATION

---

### DECK FITTINGS

- Teak laid transom platform, cockpit deck and steps to side decks
- Reversible electric anchor winch with helm position controls
- Self-stowing (16 kg/35 lbs) Delta anchor with 30m of chain
- Stemhead roller with automatic anchor launch and retrieve
- Chain locker with stowage for 4 fenders (stowage for an additional 2 fenders in engine room)
- Stainless steel bow, stern and spring cleats
- Bow fairleads
- Stainless steel pulpit and guardrails
- Foredeck hatch with integrated skylight
- Rubbing band with stainless steel insert
- Full set of IMCO navigation lights
- Riding light
- Remote control searchlight
- Twin electric horns
- Fuel and water fillers

### COCKPIT

- Self draining
- L-shaped seat opposite helm position
- U-shaped seating/dining area
- Teak table (with optional conversion to double sunbed)
- Cockpit lighting
- Audio unit linked to saloon with local control, paired with Fusion 6" FR-602 speakers (2)
- Sliding sun roof (electrically operated) within fixed GRP structure and integrated radar arch
- Aft tonneau canvas cover
- Stainless steel grabrails
- Wetbar with sink, top loading cool box and optional electric barbecue
- Locker with remote fuel cocks
- 220/240v shore support inlet
- Life raft storage locker
- Engine access hatch with gas strut support and storage for 2 fenders
- Transom gate leading to integral bathing platform
- Teak laid bath platform with retractable

- swimming ladder (manual), hot and cold transom shower, and space for tender
- Large transom storage locker with access via transom doors and hatch in stern seat (will accept deflated dinghy and outboard engine)

### HELM POSITION

- Double helm seat with sit/stand facility
- Instrument console incorporating engine instruments and fuel gauges
- Instruments and controls at helm position:
  - Power-assisted electro-hydraulic steering
  - Adjustable steering wheel
  - Electric anchor winch remote control
  - Trim tab controls with indicators
  - Sterndrive trim controls
  - VHF with DSC R/T
  - Speed and distance log (with sea temperature)
  - Echo sounder with alarm
  - Remote control searchlight
  - High-speed compass
  - Horn button



- Chart table
- Windscreen wipers (2 speed)
- Freshwater windscreen wash
- Bilge pump controls with visual 'pump running' warnings

### **SALOON**

- U-shaped sofa, converting to double berth with built in stowage for infill cushions
- Dining table
- Cocktail cabinet
- Cupboards and lockers
- Fusion Apollo RA-670 audio unit with WiFi and Bluetooth connected to saloon Fusion 6" CL602 speakers and cockpit speakers (2)
- Window with opening porthole
- Manual tension venetian blind
- LED overhead and concealed lighting (12v)
- Access stairway to lower accommodation
- Fitted carpet

### **GALLEY**

- Solid surface worktop
- 2-zone gas hob with flame-failure device
- Combination microwave/conventional oven with grill

- Stainless steel sink with mixer tap
- Waste bin
- Drawers and storage cupboards
- Refrigerator with freezer compartment
- Window with opening porthole
- Manual tension venetian blind
- LED overhead and task lighting (12v)
- 220/240v outlets (4)
- Timber flooring

### **ACCOMMODATION**

- All cabins and bathrooms feature opening portholes
- All cabins feature 220/240v power points
- All bathrooms feature electric freshwater toilets and 240v shaver points

### **OWNER'S CABIN**

- Large double bed with drawers below
- Wardrobe with shelves
- Dressing table
- Mirror
- Storage lockers and drawers
- Window with opening porthole
- Manual tension venetian blind
- Deck hatch with integrated skylight and blind

- LED overhead and concealed lighting (12v)
- Individual berth lights
- 220/240v outlets (2)
- Fitted carpet

### **EN-SUITE BATHROOM**

- Wash basin with solid surface worktop
- Mirror
- Storage lockers
- Shower compartment with automatic pump out
- Window with opening porthole
- Manual tension venetian blind
- LED overhead and concealed lighting (12v)
- Bathroom accessories
- Solid surface flooring

### **GUEST CABIN**

- Two single berths
- Wardrobe with shelves
- Mirror
- Storage lockers
- Panoramic with opening porthole
- Manual tension venetian blind
- LED overhead and concealed lighting (12v)
- Individual berth lights
- 220/240v outlets (2)



- Fitted carpet

## **GAS**

- Overboard vented and drained locker for 2 gas bottles
- Copper gas line sheathed in PVC
- Gas regulator
- Gas low/system test meter

## **POWER AND DRIVE SYSTEMS**

- Twin duo-prop stern drives
- Engine room lighting
- Engine room access hatch and ladder
- Power-assisted electro-hydraulic steering system
- Trim tabs with indicators
- Electronic engine and gear shift controls
- Engine room extraction

## **ELECTRICAL SYSTEMS**

12 Volt:

- 2 x heavy duty batteries for engine starting
- 2 x heavy duty auxiliary batteries
- Battery link facility with remote control at helm position
- Both battery banks are charged using a voltage

sensitive relay that parallels both battery banks when a charging source is present

- 75-amp 12v float battery charger
- Remote battery master switches with control switch at main switch panel
- Circuit breakers on all circuits
- 12v voltage dropper for certain navigation and radio circuits

220/240 Volt:

- Automatic fire extinguisher
- 30-amp shore support inlet
- Polarity check system
- Earth leakage safety trip
- Circuit breakers on all circuits
- Power points in: owner's cabin, guest cabin, galley and saloon area
- Shaver point in bathroom

## **FUEL SYSTEM**

- Twin fuel tanks (in NS8 marine grade alloy) with interconnection system giving 160 gal / 192 US gal / 730l capacity
- Fuel fillers on port and starboard side decks
- Volvo fuel filter/ water separator (one per engine) with water warning sensors connected

to warning lights at helm position

- Remote fuel cocks in cockpit locker
- Fuel gauges at main helm console

## **WATER SYSTEM**

- Water tanks totalling 64 gal / 77 US gal / 290l plus 7 gal / 8.5 US gal / 32l hot water calorifier
- Water heated by engines and 240v immersion heater
- Automatic water pump with filter
- Main circuit breaker at switch panel
- Water level gauge
- Deck filler

## **FIRE EXTINGUISHERS**

- Automatic/manual override fire extinguishers in engine room with warning system at helm position
- Hand-operated fire extinguishers (4) in owner's cabin, guest cabin, galley and helm position

## **BILGE PUMPS**

- Automatic/manual override electric bilge pumps in engine room (2), rudder area, lazarette and forward accommodation (6 in all)
- High-capacity manual bilge pump with valve



system and suction points in same areas

- Electric bilge pumps have controls and warning lights at main helm and warning light with audible alarm at flybridge helm

#### **OTHER STANDARD EQUIPMENT**

- Ensign staff
- Fenders (6)
- Mooring warps (4)
- Boat hook
- First-aid kit
- Tool kit
- Owner's manual and engine manual
- Quilted bedspreads supplied to both cabins
- Ship's document case
- Anchor winch back up handle

#### **FINISHES**

- Teak-laid decks to transom platform, cockpit deck and steps to side decks
- Timber-laid floor to galley area
- Furniture in choice of Rovere Oak or Alba Oak in satin lacquer finish as standard. Silver Oak or Walnut in satin or gloss lacquer finish available as an option
- Tiled floor in bathroom suite in guest

accommodation

- Solid surface wash basin counter tops in bathroom suite in guest accommodation
- Galley worktop in solid surface finish
- Choice of high-quality carpet and upholstery fabric from extensive range
- Blinds or sunscreens to all windows and portholes

## GLOBAL COVERAGE

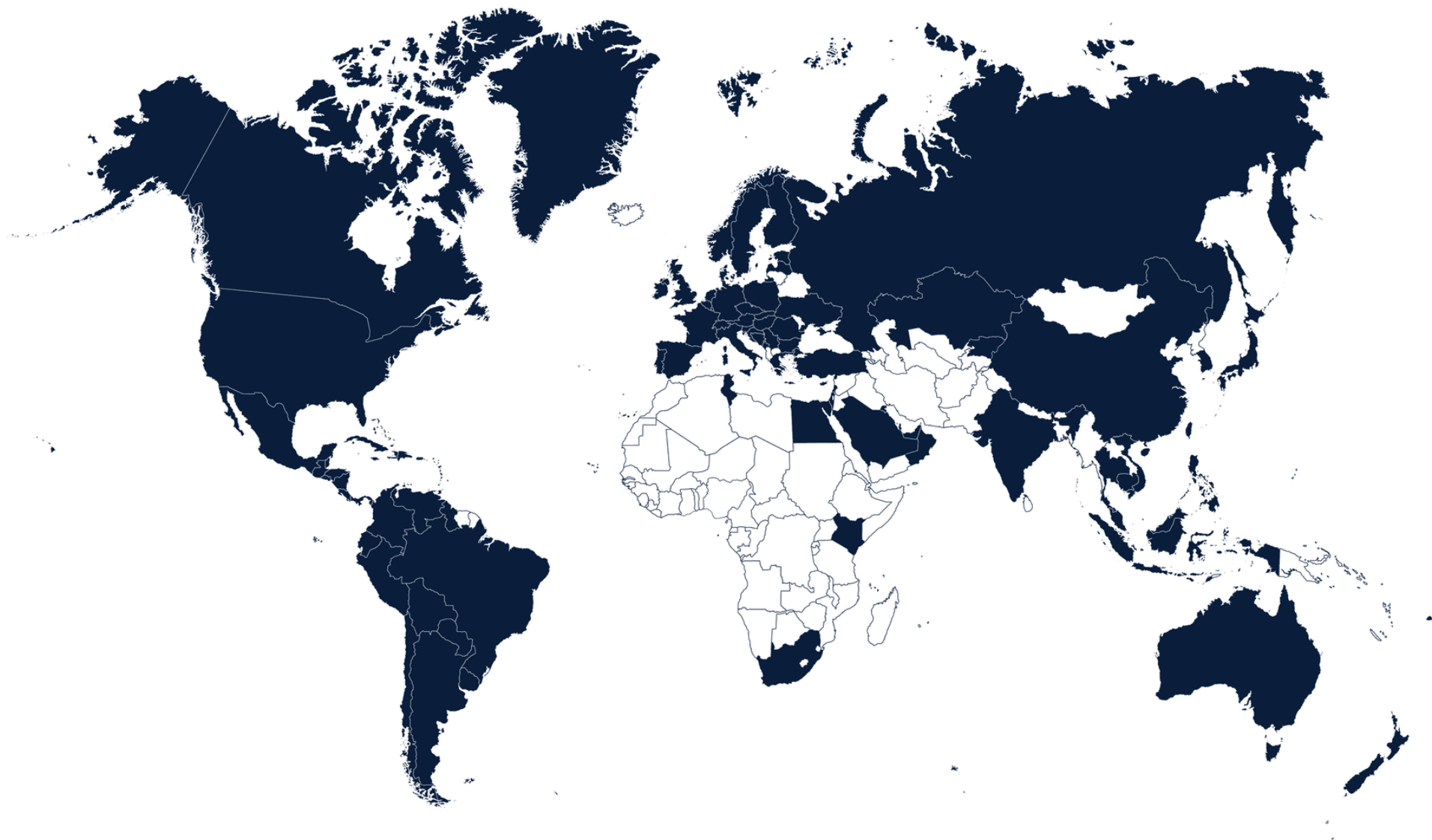





## THANK YOU

For more information or to find a distributor,  
please visit our [website](#).