

Y 78



The Y78 features the very latest in Princess exterior design and interior materials and finishes. Her flexible deck layout features a walkthrough foredeck with U-shaped seating and sunbathing area, whilst her flybridge aft has space for free standing furniture or can accommodate a crane and a tender.





Natural light flows in to her main deck through extended window lines and a unique full-height window on the port side to make the free standing dining area a spectacular place to entertain. Forward on the lower deck, all three guest cabins are en-suite whilst a dedicated staircase leads to the owner's stateroom amidships via a private lobby area.





TAKE A VIRTUAL TOUR OF THE Y78





Y78
SPECIFICATION

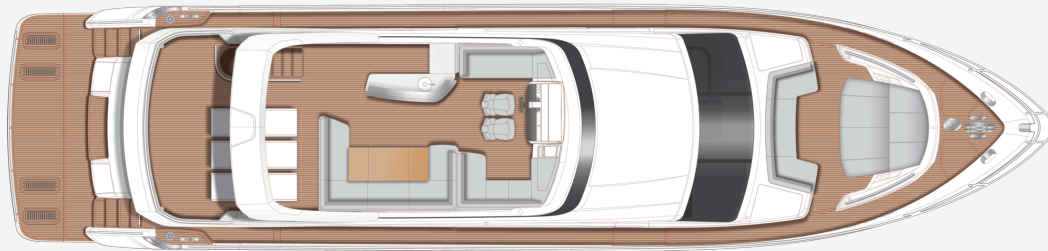

Y78 Flybridge

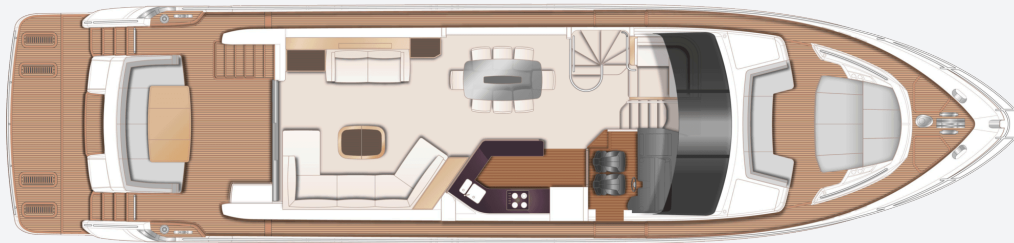

Y78 Main Deck

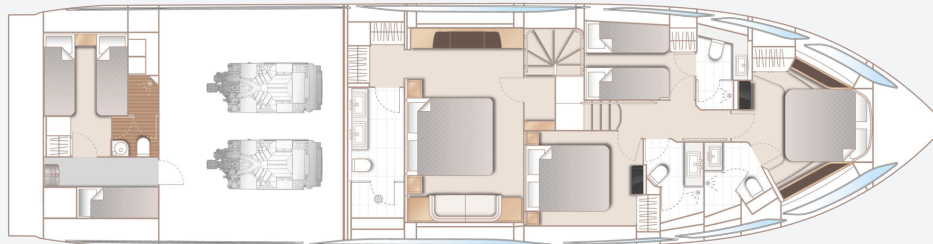

Y78 Lower Deck

PRINCIPAL DIMENSIONS

Length overall (incl. pulpit)	80ft 9in (24.67m)
Length overall (excl. pulpit)	79ft 7in (24.25m)
Beam	18ft 11in (5.76m)
Draft (full load)	5ft 8in (1.72m)
Displacement (half load)	54,085kg (119,237lbs)*
Fuel capacity	1,320 gal/1,585 US gal/6,000l
Water capacity (excl. calorifier)	235 gal/304 US gal/1,150l

ENGINES

Twin MAN V12 (2 x 1,800mhp)	Speed range: 34-36 knots†
------------------------------------	------------------------------

FULL SPECIFICATION

DECK FITTINGS

- Teak-laid transom platform, cockpit deck, flybridge, flybridge stairway and steps to side decks.
- Lewmar V6 24v DC windlass
- Stemhead roller with automatic anchor launch and retrieve
- Self-stowing 50kg/110lbs Delta anchor with 100m of chain
- Twin electric sternline mooring winches
- Deck hatch access to chain locker
- Bow rope stowage locker
- Freshwater deck/anchor wash (with both fore and aft deck outlets)
- Stainless steel bow and stern fairleads
- Stainless steel bow, stern and spring cleats (2 pairs)
- Stainless steel pulpit and guard rails
- Stainless steel coachroof and flybridge handrails
- Foredeck escape hatch
- Foredeck U-shaped seating area
- Foredeck sunbathing area with integrated

- adjustable headrests and storage
- Twin coachroof lockers for storage of fenders, ropes and cushions
- PVC rubbing band with stainless steel insert
- LED deck level lighting
- Full set of IMCO navigation lights
- Riding light
- Twin beam searchlight with dual station remote controls
- Stern docking lights
- Twin electric horns
- Fuel and water fillers

COCKPIT AND BATHING PLATFORM

- Self-draining
- Upholstered U-shaped seating
- Folding teak dining table
- LED overhead and deck level lighting
- Stainless-steel handrails
- Remote control 4.0m telescopic passarelle with folding handrails
- Watertight pantograph door giving direct access from bathing platform to crew cabin/

- utility area/engine room
- Lockable gas strut assisted hatch to engine room
- Liferaft stowage lockers
- Rope storage lockers
- Locker containing remote fuel cocks, manual bilge pump with valve chest and manual controls for automatic fire extinguishers
- Integral stairway to flybridge with teak step treads
- Twin transom gates leading to bathing platform
- Electro-hydraulic raise/lower teak laid bathing platform (550kg SWL)
- Retractable bathing ladder (manual) in side of hydraulic platform
- Swim platform transom seat in teak
- Transom access to lazarette
- Transom steps to access stern from bathing platform when in lowered position
- Dinghy chock system
- Hot and cold transom shower
- 220/240v shore support inlet
- Cockpit canvas cover

FLYBRIDGE

- Instrument console with dual station controls and LED display incorporating engine instruments, fuel gauges, alarms and rudder position indicator (see Lower Helm Position)
- Power assisted electro-hydraulic steering with adjustable wheel
- Twin adjustable helm seats with honeycomb quilting and contrast panelling
- Port seating/sunpad
- Starboard forward-facing L shaped seating (converts to sunpad)
- Large U-shaped upholstered seating
- Folding leaf teak table
- Wetbar with barbecue, sink, drawer refrigerator, waste bin and storage
- Sunpad aft with storage below
- Naim Uniti Atom audio system with waterproof speakers (2)
- Clear view hatch to aft cockpit
- Wind deflector screens
- Stainless steel handrails with glass balustrade and partial teak capping to aft end of flybridge
- LED deck level lighting
- GRP radar arch
- Twin matching whip aerials for VHF R/T and

radio

- Console and seat covers
- Optional crane (450kg SWL)
- Optional GRP hardtop with/without electric opening section (or optional folding bimini with electro-hydraulic operation)

HELM POSITION

- Twin leather upholstered helm seats with honeycomb quilting, contrast panelling and fore/aft adjustment for helmsman. Y logo to outboard helmseat.
- Instrument console with LED display incorporating engine instruments, fuel gauges, alarms and rudder position indicator
- Dual station instruments and controls at Flybridge and Lower Helm Positions:
- power-assisted electro-hydraulic steering
- adjustable steering wheel
- high-speed magnetic compass
- electronic engine controls
- trim tab controls with indicators
- bow thruster control
- electric anchor winch remote control
- colour radar (with scanner) and GPS/chartploter (twin displays at lower helm)

- autopilot
- speed and distance log
- echo sounder with alarm
- VHF with DSC R/T with intercom
- remote control searchlight
- horn button
- Intercom to flybridge
- Automatic fog horn with loudhailer
- Chart table
- Drinks holders
- Toughened glass screen (clear for night vision) with windscreen de-mist system
- Windscreen wipers with freshwater windscreen wash
- Black mesh windscreen covers
- Bilge pump controls with visual pump running warnings
- 24v and 240v electrical control panel
- Riding light, helm and navigation light control switches
- USB charging point
- LED overhead lighting (24v) and night lighting
- Pantograph helmsman's door to starboard side deck
- Timber flooring (V groove planked)

SALOON

- U-shaped sofa
- Coffee table
- Two-seater sofa to port
- Sideboard unit with bottle and glass storage
- Refrigerator
- 55" UHD LED TV on rise and fall with Blu-ray player
- Naim Uniti Atom audio system connected to Focal 100 ICW6 speakers (2) with Focal Cub Evo subwoofer
- Onboard ethernet and 4G internet.
- Triple stainless steel framed sliding door to aft cockpit
- Roman blinds or curtains to all windows and doors
- LED overhead and concealed lighting (24v)
- Fitted carpet

DINING AREA

- Glass dining table
- Dining chairs (8)
- Full height panoramic window
- L-shaped sofa opposite helm area
- Electric drop window to port
- Roman blinds or curtains to all windows

- LED overhead and concealed lighting (24v)
- Access stairway to lower accommodation
- Separate access stairway to master stateroom
- Fitted carpet

GALLEY

- Galley worktop in choice of granite or quartz
- 4-zone ceramic hob
- Extractor fan
- Combination convection oven with grill/microwave
- Twin-bowl stainless steel sink with mixer tap
- Chopping board
- Full height refrigerator/deep freeze
- Icemaker
- Dishwasher
- Waste bin
- Drawers and storage cupboards
- Manual tension venetian blind to window
- Electrically operated sliding partition
- LED overhead and task lighting (24v)
- 220/240v outlets (4)
- Timber flooring (planked)

ACCOMMODATION

- All cabins and bathrooms feature opening

portholes and air conditioning

- All cabins feature 220/240v power points
- All bathrooms feature electric freshwater toilets and 240v shaver points

OWNER'S STATEROOM LOBBY

- Access stairway to owner's stateroom
- Panoramic window
- Manual tension venetian blind
- LED overhead and concealed lighting (24v)
- Fitted carpet

OWNER'S STATEROOM

- Large double bed with drawers below
- Twin bedside tables
- Dressing area with wardrobes and storage
- Built-in safe
- Dressing table with chair
- Mirror
- Sofa
- Storage lockers and drawers
- 43" UHD LED TV with Blu-ray player
- Naim Unit Atom audio system connected to Focal 100 ICW6 speakers (2) with Focal Cub Evo subwoofer
- Panoramic windows including opening

- portholes
- Manual tension venetian blinds
- LED overhead and concealed lighting (24v)
- Individual berth lights
- 220/240v outlets (2)
- USB charging point
- Fitted carpet

EN-SUITE BATHROOM

- Twin washbasins with solid surface worktop
- Mirror
- Storage lockers
- Shower compartment with automatic pump out
- Extractor fan
- Window with opening porthole
- Manual tension venetian blind
- LED overhead and concealed lighting (24v)
- Bathroom accessories
- Solid surface flooring

FORWARD STATEROOM

- Large double bed with drawers below
- Wardrobe with shelves
- Dressing table with stool
- Mirror
- Storage lockers

- Naim Uniti Atom audio system connected to Focal 100 ICW6 speakers (2)
- Windows with opening portholes
- Manual tension venetian blinds
- Deck hatch
- LED overhead and concealed lighting (24v)
- Individual berth lights
- 220/240v outlets (2)
- USB charging point
- Fitted carpet

EN-SUITE BATHROOM

- Washbasin with solid surface worktop
- Mirror
- Storage lockers
- Shower compartment with automatic pump out
- Extractor fan
- Window with opening porthole
- Manual tension venetian blind
- LED overhead and concealed lighting (24v)
- Bathroom accessories
- Solid surface flooring

PORT GUEST CABIN

- Two single beds with drawers below (with option of double bed conversion)

- Bedside table
- Wardrobe with shelves
- Mirror
- Storage lockers
- Windows with opening portholes
- Manual tension venetian blinds
- LED overhead and concealed lighting (24v)
- Individual berth lights
- 220/240v outlets (2)
- USB charging point
- Fitted carpet

EN-SUITE BATHROOM

- Washbasin with solid surface worktop
- Mirror
- Storage lockers
- Shower compartment with automatic pump out
- Extractor fan
- Window with opening porthole
- Manual tension venetian blind
- LED overhead and concealed lighting (24v)
- Bathroom accessories
- Solid surface flooring

STARBOARD GUEST CABIN

- Large double bed with drawers below (with

option of two single beds which slide to form a double as required)

- Twin bedside tables
- Wardrobe with shelves
- Dressing table with stool
- Mirror
- Storage lockers
- Windows with opening portholes
- Manual tension venetian blinds
- LED overhead and concealed lighting (24v)
- Individual berth lights
- 220/240v outlets (2)
- USB charging point
- Fitted carpet

EN-SUITE BATHROOM

- Washbasin with solid surface worktop
- Mirror
- Storage lockers
- Shower compartment with automatic pump out
- Extractor fan
- Window with opening porthole
- Manual tension venetian blind
- LED overhead and concealed lighting (24v)
- Bathroom accessories
- Solid surface flooring

- Day access door from passageway

CREW CABIN

- Two single beds with storage below
- Bedside table
- Wardrobe with shelf
- Mirror
- Storage lockers
- Window with opening porthole and venetian blind
- LED overhead lighting (24v)
- Individual berth lights
- 220/240v outlets (2)
- USB charging point
- Fitted carpet

EN-SUITE BATHROOM

- Washbasin with solid surface worktop
- Mirror
- Storage lockers
- Shower compartment with automatic pump out
- Extractor fan
- LED overhead lighting (24v)
- Bathroom accessories
- Solid surface flooring

CREW AREA

- Access from transom door
- Access to engine room
- Storage space, cupboards and lockers
- Washer/dryer fitted in crew utility space (a separate washer and dryer may be optionally installed in place of the standard unit)
- Option of single berth as required
- Window with opening porthole and venetian blind
- LED overhead lighting (24v)
- Non-slip safety flooring

POWER AND DRIVE SYSTEMS

- Engine room soundproofed
- High volume air intakes
- Engine room extractor fan with electronic time delay
- Engine exhaust silencers and water-cooled exhausts
- Engine beds integrally moulded with hull for strength and vibration absorption
- Forward and aft engine room bulkheads integrally bonded
- Engines flexibly mounted
- Automatic fire extinguisher with remote

override control

- Automatic and manual bilge pumps
- Propeller shafts in Marinemet
- 5-bladed propellers in nickel aluminum bronze
- High speed balanced rudders
- Cathodic protection for sterngear
- Sterngear, engines, fuel tank fillers, etc all electrically bonded
- Engine room lighting
- Engine room access from transom door and from cockpit deck
- Power-assisted electro-hydraulic steering system
- Trim tabs with indicators
- Electronic engine and gear shift controls
- Bow thruster (250kgf/551lbf) with dual-station controls
- Fresh water supply point in engine room
- Dripless self-aligning shaft seals

ELECTRICAL SYSTEMS

24 Volt:

- 4 x heavy-duty batteries for engine starting and windlass operation
- 6 x heavy-duty auxiliary batteries
- Battery link facility with remote control at helm

position

- Both battery banks are charged using a voltage sensitive relay that parallels both battery banks when a charging source is present
- 1 x 60-amp 24v battery chargers and 1x combination 3.5kW inverter/100-amp charger
- Remote battery master switches with control switch at main switch panel
- Circuit breakers on all circuits
- 12v voltage dropper for certain navigation and radio circuits

220/240 Volt:

- 22.5kW generator in own sound shield with water-cooled and specially silenced exhaust
- 2 x 63-amp shore support inlet
- Generator/shore support change-over switch
- Polarity check system
- Earth leakage safety trip
- Circuit breakers on all circuits
- Power points (240v) in: owner's stateroom, guest cabins, galley and saloon area
- Shaver points in all bathrooms

FUEL SYSTEM

- Fuel tanks (in NS8 marine grade alloy) with

interconnection system giving 1,320 gal / 1,585 US gal / 6,000l capacity

- Fuel fillers on port and starboard side decks
- High-capacity duplex fuel filters with water traps and change-over valves, water warning sensors connected to warning lights at lower helm
- Remote fuel cocks in cockpit locker
- Dual station fuel gauges on helm consoles

WATER SYSTEM

- Water tanks totalling 253 gal / 304 US gal / 1,150l plus 44 gal / 53 US gal / 200l hot water calorifier
- Water heated by engines and 240v immersion heater
- Automatic water pump with filter
- Main circuit breaker at switch panel
- Water level gauge
- Deck filler
- Electric toilet system with 99 gal / 119 US gal / 450l holding tank, content gauge and low noise electric overboard discharge, with macerator backup system as well as dockside discharge system

AIR CONDITIONING SYSTEM

- Air conditioning/heating reverse cycle (165,000 BTU) suitable for temperature of 40°C (tropical) is fitted as standard. With controls in all cabins and outlets in all areas (including bathrooms)
- Standard generator is suitable

FIRE EXTINGUISHERS

- Automatic/manual override fire extinguishers in engine room with warning system at both helm positions and incorporating engine air vent closure system
- Hand operated fire extinguishers (8) in master stateroom, forward stateroom, port and starboard guest cabins, crew cabin, utility area, galley and lower helm position
- Separate automatic fire extinguisher fitted in electrical space

BILGE PUMPS

- Automatic/manual override electric bilge pumps in engine room (2), rudder area and forward accommodation (7 in all)
- High-capacity manual bilge pump with valve system and suction points in same areas

- Electric bilge pumps have controls and warning lights at main helm and warning light with audible alarm at flybridge helm

OTHER STANDARD EQUIPMENT

- Ensign staff
- Fenders (8)
- Mooring warps (4)
- Boathook
- First-aid kit
- Tool kit
- Owner's manual and engine manual
- Quilted bedspreads supplied to all cabins (except crew cabin)
- Set of towels (8 large, 8 hand)
- Set of crystal glassware (8 settings consisting of tumbler, highball and wine glasses)
- Set of Princess china (8 settings consisting of plate, side plate, bowl, cup & saucer)
- Set of cutlery (8 settings of David Mellor "Paris" cutlery 7 pieces)
- Ship's document case
- Anchor winch back up handle

FINISHES

- Teak-laid decks to transom platform, cockpit deck, steps to side decks, steps to flybridge and flybridge
- Timber (planked) floor to galley and helm
- Furniture in choice of Rovere Oak or Alba Oak in satin lacquer finish as standard. Silver Oak or Walnut in satin or gloss lacquer finishes available as an option
- Solid surface floors in all bathroom suites
- Solid surface counter tops in all bathroom suites
- Galley worktop in granite/quartz
- Choice of high-quality carpet and upholstery fabric from extensive range
- Curtains, blinds or sunscreens to all windows and portholes
- Crew cabin has fitted carpet
- Crew bathroom has solid surface flooring with white solid surface countertops

GLOBAL COVERAGE

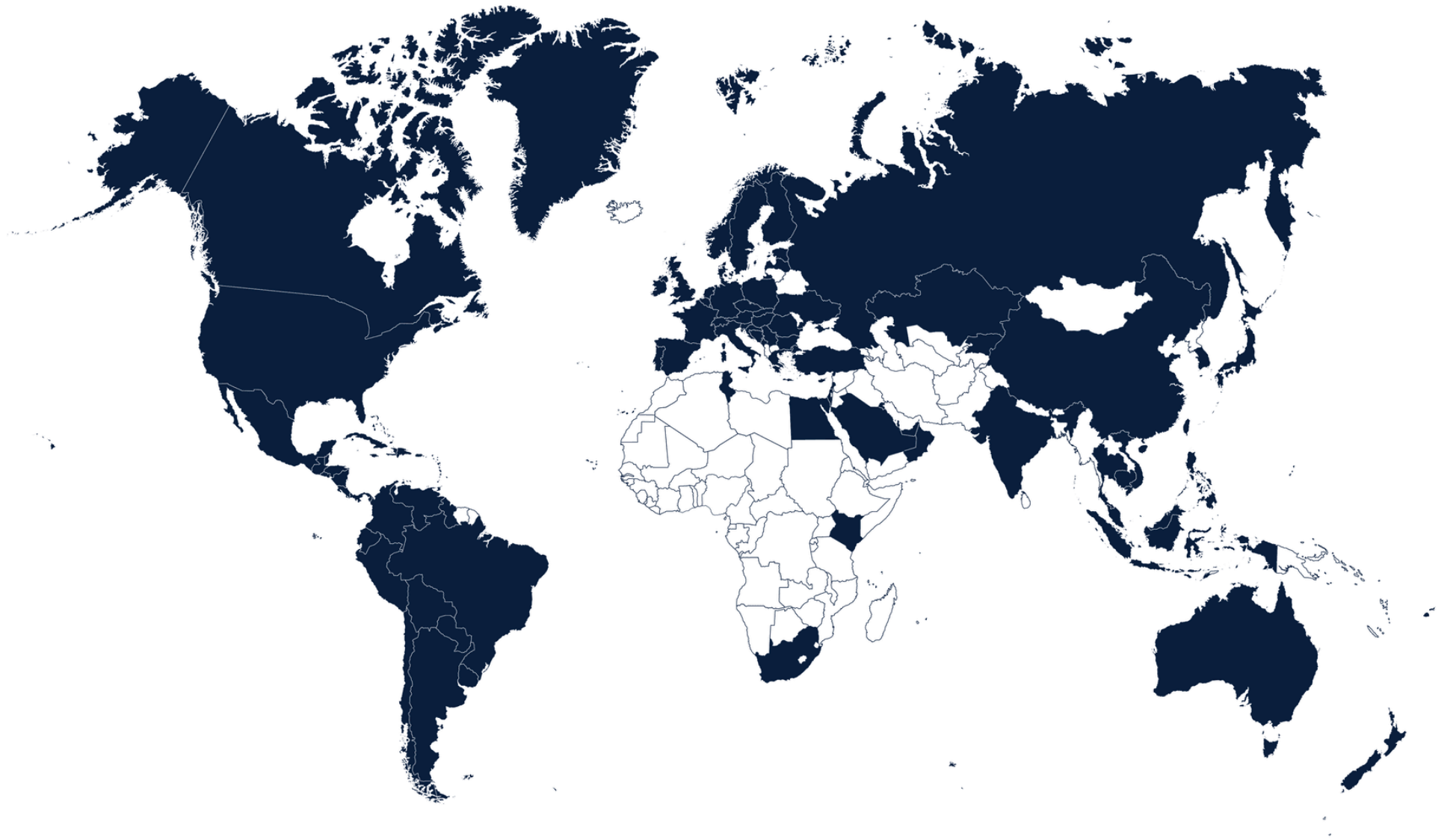



THANK YOU

For more information or to find a distributor,
please visit our [website](#).

