

SANLORENZO SL86

Price on application



STOCK

HIGHLIGHTS

/ BRAND NEW
/ FULLY EQUIPPED

/ FAST DEAL

SPECIFICATIONS

Location	Italy	Water capacity	1700 l
Year	2021	Cabins	4+1
Length	26.76 m	Engines	2 x MTU 12V2000M96L - 1947 HP
Beam	6.35 m	Max speed	32 †
Draft	1.80 m	Engine hours	Contact seller
Displacement	78 tonnes	Price	Price on application
Fuel capacity	8000 l		

EQUIPMENT

Technical Equipment

- Battery charger 12V 25A for generator batteries
- CCTV system n.1 fixed camera in cockpit + n.2 fixed in engine room
- Internet WiFi system 4G with Harbour hot spot antenna
- Searchlight with control in main helmstation and flybridge
- Additional insulation for fin stabilizer
- Additional waterproof 220V socket in the flybridge barcabinet
- Raymarine DIAMOND package
- N.4 underwaterlights (n. 2 aft + n. 2 sides)
- Upgrade second generator 25kW
- Hydraulic stern thrust propeller
- Electric fins stabilizer Zero Speed (at anchor and in navigation)
- Hard top with electric blades opening roof
- Antenna TV-Sat SEATEL ST24E
- Empty radome SEATEL ST24E for symmetry on HT
- Predisposition for third command station MTU in cockpit
- Watermaker 180 L/h
- Predisposition for Glendinning CM7 (space in E.R. + braker in principal electrical panel)

Complements for the interior

- Parquet in salon (diff. from moquette std)
- Bed and headboard in all cabins (Owner, VIP and guests) in NUVOLA leather (diff. from std leather)
- Bow wall (in front of stairs) and bow walls SN + DN in foyer lower deck in NUVOLA leather (diff. From STD)
- Headshower in VIP Cabin
- Eucalypto wood for cabinets and walls for all boat (Diff. From std)
- Dining ceiling in parquet wood
- Sliding bed in Portside guest cabin
- All integrated sinks in Silk Georgette marble (diff. Da n. 4 lavabi std)
- WC in crew area with integrated shower
- Bow Additional storage in wheelhouse + additional socket
- Additional cabinet storage DX in wheelhouse
- Modifica scala al Fly con Piattaforma Custom aggiuntiva
- Vanity cabinet in owner's cabin in NUVOLA CRETA 159 leather
- Profiles of cabinet's handles in chrome steel in polished finishing for: lower cabinets in salon + wheelhouse, lower cabinets SN in owner's cabin and for all bedside tables in cabins.
- Profiles of cabinet's handles in chrome steel in polished finishing for beds in all cabins (except crew area)
- Electric blackout for owner and VIP's cabins (n°3 curtainins + n°3 movements)
- Silk Georgette marble wall in owner's shower (diff. from STD lacquered)

Salon

- Carpet for salon SUPER TUFT RIBCORD color 4422, with board

2 cm in Polypropylene in Opal grey color

- n°2 sofas MINOTTI ANDERSEN SLIM 90 MINOTTI DOUGLAS 07 GHIACCIO fabric, n°1 "L" shape sofa and n°1 aft chaise longue (diff. from std)
- N°1 round coffee table POLTRONA FRAU FIDELIO with marble top CALACATTA ORO polished, 32 FRASSINO TINTO WENGE' structure and dimension diam. 90 cm e h 30 cm + N°1 elliptical small table POLTRONA FRAU FIDELIO with hardleather POLTRONA FRAU SADDLE TORTORA, 32 FRASSINO TINTO WENGE' structure and dimension 45x35 cm e h 55 cm (diff. from coffee table STD)
- Dining custom table in dining area with rounded corners r. 20 mm, marble top FIOR DI BOSCO in polished finishing (ANTOLINI) and central base with n°2 rectangular profiles and crossed in polished steel chrome, dim. 130x130cm (diff. from STD dining table)
- n°8 dining chairs POLTRONA FRAU MONTERA without armrests, in POLTRONA FRAU SC 21 AMIANTO leather with 32 FRASSINO TINTO WENGE' structure (diff. from STD dining chairs)

Curtainins

- Predisposition for electric curtains in Owner's and Vip Cabin
- Electric curtains in Salon and dinette (tot n.4 curtains)

Household appliances

- Predisposition electric cables for Teppan Yaki on flybridge cabinet
- Wine cooler in salon
- Cooking top 75 Cm in Kitchen (diff. from std)

Audio/Video

- TV in Salon 55" (diff. From std 40")
- TV in Owner's cabin da 40" (diff. From std 32")

Complements for the exterior

- Teak floor for bow area
- Teak floor on flybridge
- Additional storage cabinet SN on flybridge with Corian top and sides
- Bar cabinet DN on flybridge with Corian top and sides and slats teak doors (diff. From STD)
- Dining table on flybridge RODA Spinnaker with metal smoke structure and teak top
- Sun awning for stern area of the fly
- Sun awning for boa area
- Bow dining with stainless steel polished finishing with hi-low manual system, folding top
- Column inox shower on flybridge
- N°2 small tables on flybridge RODA ROOT 045 with "pietra luna" stone top and teak base (diam. 45cm e h=44cm)
- N°1 small table RODA LEAF 001 with GRES IVORY top and smoke structure

EXTERIOR



INTERIOR



LAYOUTS

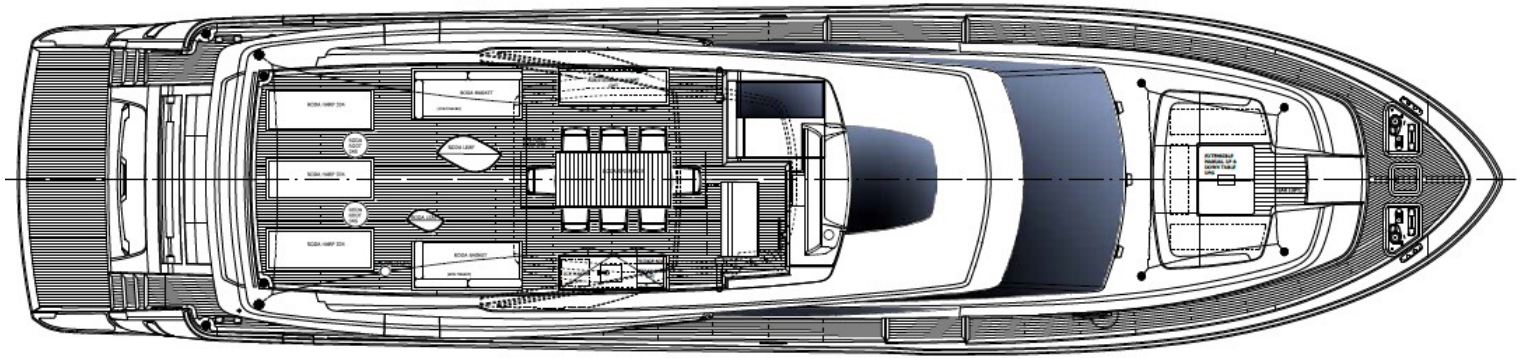

FLYBRIDGE

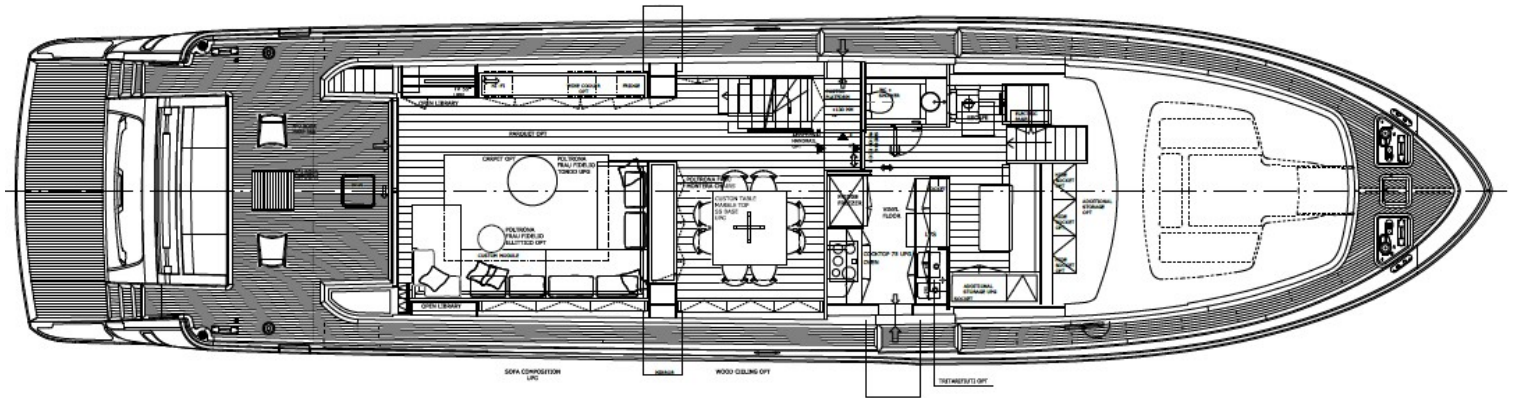

MAIN DECK

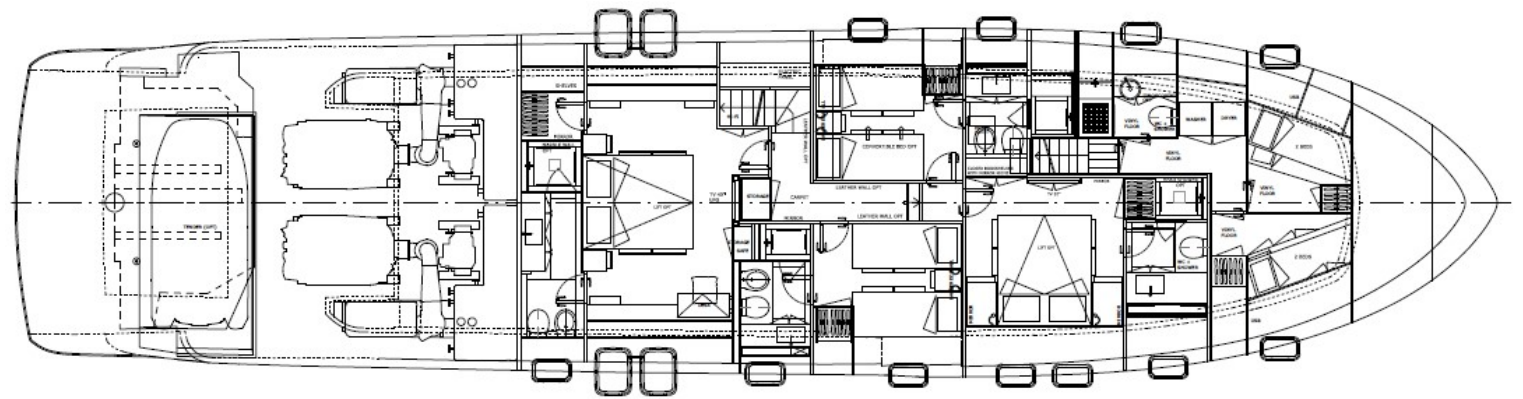

LOWER DECK
