

## 2024 PRINCESS F45 (2024)

€1 150 000



### HIGHLIGHTS

/ BUILT 2024

/ MINIMUM HOURS

/ SEAKEEPER STABILISER

/ FULL TEAK DECKING

/ POWERED SLIDING COCKPIT SOFA

/ ELECTRO-HYDRAULIC BATHING  
PLATFORM

/ ELECTRO-HYDRAULIC PASSERELLE

### SPECIFICATIONS

Location	Monaco, Monaco	Cabins	2
Year	2024	Berths	4
Length	14.35 m	Engines	Volvo IPS 650
Beam	4.25 m	Engine hours	80
Draft	1.14 m	Max power	2 x 480 hp
Fuel capacity	1363 l	Max speed	31 kn
Water capacity	487 l	Price	€1 150 000 (VAT excl.)

## DESCRIPTION

---



Delivered in 2024 and showing only 80 engine hours, this Princess F45 is offered in as-new condition with maximum specification. Featuring rare options including Seakeeper stabilisation, she is one of the most highly equipped F45s on the market today.

Her design combines elegant lines with versatile outdoor spaces: full teak decking, a powered sliding cockpit sofa, hydraulic bathing platform, and electro-hydraulic passerelle ensure comfort and practicality. The flybridge, complete with wetbar and bimini, creates the perfect setting for Mediterranean cruising.

Inside, the light-filled saloon connects seamlessly to the cockpit, with accommodation for four guests across two en-suite cabins, including a full-beam master. Offered ex-VAT and available for viewings in Monaco at short notice, this is a rare opportunity to step into a virtually new Princess F45 without waiting for a new build.

”



GALLERY

---



GALLERY

---

















## LAYOUTS

---

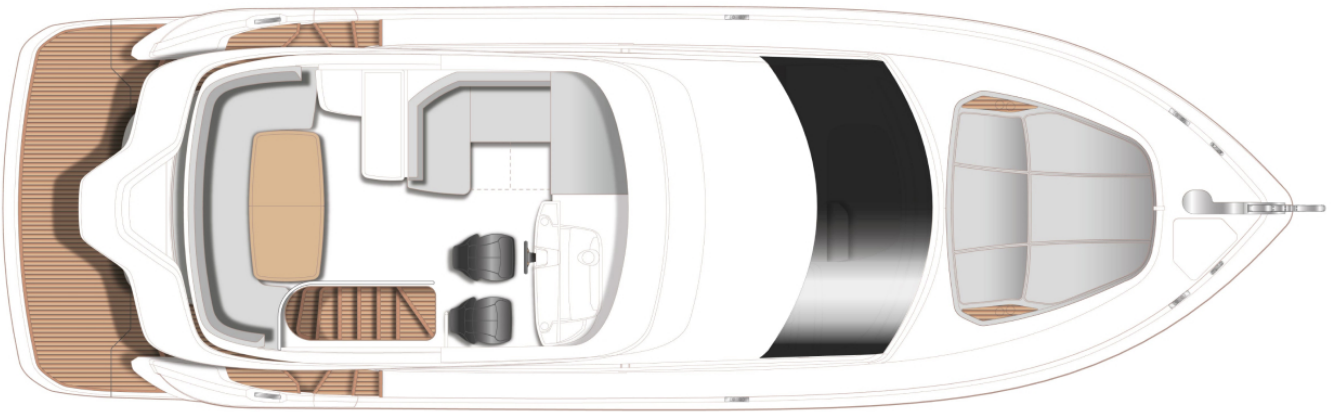

## FLYBRIDGE

---

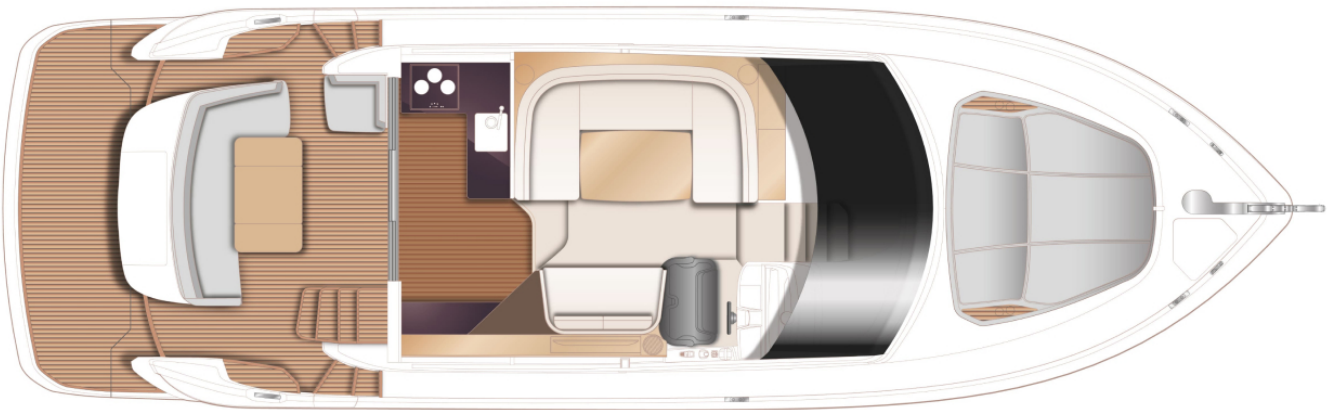

## MAIN DECK

---

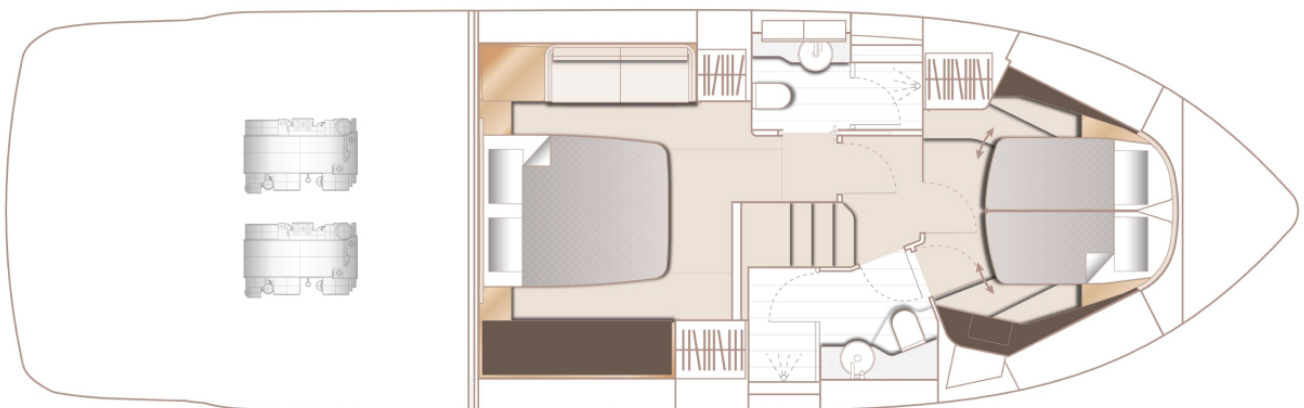

## LOWER DECK

---

## EQUIPMENT

---

### Electronics

- American version plotter
- Second Volvo/Garmin 16" color multifunction display fitted at lower helm
- On-board Wi Fi network with external Wi Fi and 3G/4G antenna
- Bow thruster (120 Kg F) with dual station controls
- USA VHF
- Garmin AIS Class B transponder interfaced with chartplotters
- Volvo Dynamic Positioning System

### Electrical Equipment

- ONAN 9.5 k W/50Hz generator (with hydrohush exhaust system)
- AGM 90Ah batteries (for start, domestic, and generator)
- Reverse cycle air conditioning/heating (58,000 Btu, tropical specification)
- Multi sockets, in place of standard 220v/240v sockets
- Single Glendinning cablemaster
- Electric discharge system with automated valve operation
- Windscreen demist system using warm air heater powered from calorifier

### Performance & Handling

- Gyro Stabilization (Seakeeper 6) with upper helm control via chart plotter screens
- Antifoul IPS drives & propellers

### Deck & Flybridge

- Hull color: White Gel Coat Finish (dark grey waterline, black antifouling, white hull & bathing platform fendering with stainless steel insert)
- Optional flybridge wet bar (sink, electric griddle/BBQ, waste bin, top-loading coolbox)
- Radar arch finished in metallic Graphite Grey (equipment mounted on radar arch left standard)
- Bimini top - Grey canvas
- Foredeck sunbed cushions with adjustable headrests
- Foredeck freshwater anchor/deck wash system
- Teak with black caulking (6mm) to flybridge deck
- Cockpit seat with powered sliding mechanism and infill cushion (extends cockpit by 400mm)
- Electro-hydraulic swimming platform (400 Kg SWL, max tender weight 150Kg) with dinghy chock system
- Additional 10m of 9.5 mm anchor chain (total 50m)
- Exterior upholstery in Met Ice with Met Macadamia contrast panels and piping
- Flybridge console finished in metallic Oyster Grey
- Quilting detail with contrast piping and paneling to flybridge helm seats
- Exterior covers - Grey canvas
- Foredeck sunbed with integrated headrest and contrast flat-stitched pleat
- Teak step nosing upgrade (to include side decks)
- Teak with black caulking (6mm) to side decks (teak in cockpit - standard)
- Sliding tender chock system allowing cockpit seat to move into aft position without deploying tender
- Electro-hydraulic passerelle (2.5m letterbox type)
- Stainless steel Ultra anchor and swivel (27kg)

- Fit reticulated foam to all standard exterior cockpit, foredeck, and flybridge seating/sunpads

- Fit reticulated foam to forward sunbed

## Accommodations

- Forward cabin with scissor berth conversion
- Interior furniture: Walnut wood gloss finish
- Combination washing machine/dryer (below companionway stairs in Master cabin)
- Ceramic electric hob (3 burner) in place of diesel hob
- Sliding window to portside of saloon
- Galley worktops in Carrara White solid surface
- Dishwasher in galley (drawer type, 6 place setting)
- Mosquito screens for all opening portlights

## Lighting & Additional Features

- Underwater transom lights (2 LUMISHORE SMX 53 White)
- Run all sink/shower outlets into standard grey water tank and grey water outlet into holding tank
- Underwater lights to aft hull sides (4 LUMISHORE SMX 53 White) (2 per side)

## Additional Equipment

- Princess China (5-piece set) - 6 place setting
- Princess Glasses (6 wine, 6 tumbler)
- Ecoworks for Princess - complete boat sustainable cleaning solution
- David Mellor 'Paris' Cutlery (6-piece) - 6 place setting
- Fender socks with Princess Logo - Grey (x6)

2024 PRINCESS F45 (2024)

€1 150 000

+33 640 61 88 46 

m.st.pierre@princessyachtsmonaco.com

---

Follow Princess Yachts Monaco

