

PRINCESS 64

Price on application



BROKERAGE

## SPECIFICATIONS

Location	After request	Fuel capacity	3409 l
Year	2014	Water capacity	909 l
Length	19.70 m	Engines	2 x Volvo D13-900
Beam	5.03 m	Max power	2 x 900 hp
Draft	1.45 m	Price	Price on application
Displacement	34 tonnes		



It's all about the performance: fast, agile and technological. Behind sporty profile of Princess 64 motor yacht you can find incredibly decent characteristics.

Spacious light interior, welcoming teak-laid flybridge with a large table for alfresco dining, seating area and wetbar with barbecue. Of course, all finished with the finest fittings and materials.

As the matter of fact Princess 64 features four spacious cabins, three of which enjoy en-suite facilities. A fifth cabin with twin beds and en-suite shower room can also be specified for crew or occasional guests. Moreover, there is an electro-hydraulic bathing platform which can accommodate a jet-rib and enables effortless launch and recovery.

”







GALLERY

---



























# LAYOUTS

---

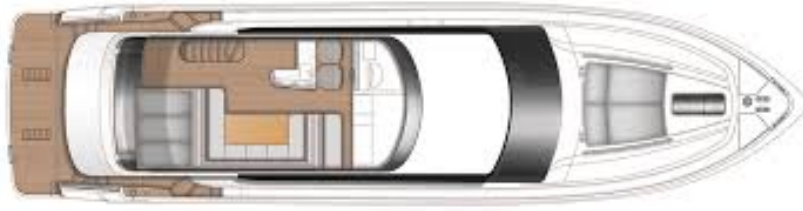

FLYBRIDGE

---

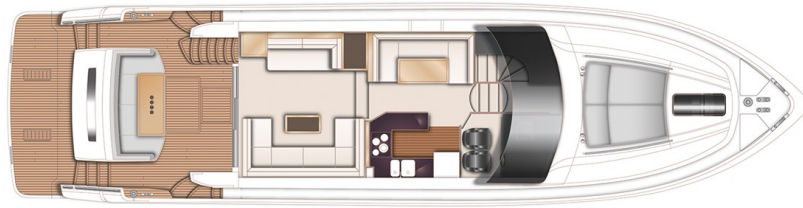

MAIN DECK

---

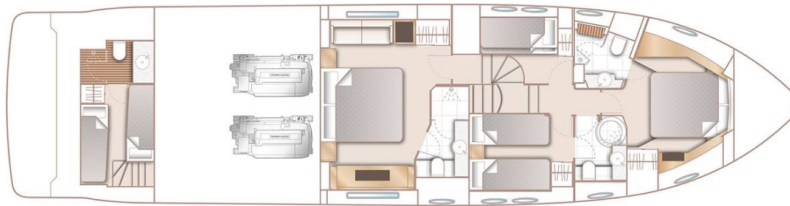

LOWER DECK

---



# EQUIPMENT

---

## HULL COLOR

White

---

## INTERIOR

Walnut interior wood Gloss finish

---

Standard helm console in Chocolate Brown

---

Lower Helm seats to be Cocoa Brown leather  
Bathroom worktops are in Kokoura avonite  
Bathroom floors in Midnight Sky  
Copper Canyon galley worktop 8 place setting of China, Cutlery & Glasses

---

Wood finish galley floor to be in wenge

---

Aft Cabin Fit out

---

Starboard Cabin to have double berth conversion with powered sliding mechanism

---

Additional charge for Platinum Leather upholstery

---

Princess China (5 piece consisting)

---

David Mellor 'Paris' Cutlery

---

Princess Glasses

---

## NAVIGATION

Standard Navigation equipment incorporates:  
Raymarine e125 Radar/Chartplotter with GPS & 12.1' brilliant colour multifunction display and with 4kw SHD 48' digital colour open array scanner at lower helm. Raymarine p70 R autopilot with rate gyro and i70 colour multifunction instruments (for speed, distance, trip, depth, depth alarm, water temperature etc) at both helm positions (two i70's at lower and one at upper)

---

Raymarine e125 multifunction 12.1' brilliant colour multifunction display at upper helm

---

Raymarine AIS Class B transponder

---

## GENERATOR

ONAN 17.5 kW / 50 Hz generator in place of standard ONAN 11.0 kW

---

## ELECTRICAL

Continental 220v/240v sockets

---

Underwater transom lights (4 LUMISHORE SMX Blue)

---



## AUDIO VISUAL & COMMUNICATIONS

PREMIUM AUDIO SYSTEM: Deck Saloon – Harman Kardon 5.1Blu-ray system (with Bluetooth connectivity) and KEF speakers Flybridge linked to the saloon audio system

---

Forward Guest Cabin – 22' LED TV with Fusion MS-AV700i Radio/DVD/MP3 player

---

## AIR CONDITIONING

Airconditioning/heating reverse cycle (72,000 BTU)

---

Aft Cabin airconditioning

---

## EXTERIOR UPHOLSTERY / COVERS

Craft are supplied with white PVC cockpit covers as standard

---

White mesh windscreen covers in place of standard black

---

Bimini top – Dark Blue sunbrella canvas

---

Teak laid side decks

---

Bimini top to have LED overhead lighting

---

Flybridge teak deck as standard

---

Bimini top to be electro-hydraulically powered

---

Foredeck sunbed cushions in Movida

---

Cockpit & flybridge seating including helm seats and sunbed cushions Movida

---

## DECK HARDWARE

Dinghy chocks on bathing platform

---

Stainless steel anchor in place of standard

---

Electro-hydraulic telescopic passerelle

---

Sternthruster

---

Additional 20m of 10 mm anchor chain to give a total of 60 metres

---

## MOSQUITO SCREENS

Mosquito screens for all opening portlights

---

## YACHT TENDER

Turbojet 325-2014 – Sport 100HP

---

PRINCESS 64

Price on application

+33 6 40 61 88 46 

[m.st.pierre@princessyachtsmonaco.com](mailto:m.st.pierre@princessyachtsmonaco.com)

---

Follow Princess Yachts Monaco

