

PRINCESS C48 (2026)

PRICE ON APPLICATION



SPECIFICATIONS

Year	2026	Cabins	1
Length	14.9 m	Engines	Triple V12 Mercury Verado
Beam	4.2 m	Max power	3 x 600hp
Draft	1.2 m	Max speed	56 kn
Fuel capacity	2346 l		
Water capacity	300 l		



The Princess C48 Deck Saloon is designed for those who value a perfect balance of luxury and practicality in any environment. Its fully enclosed main deck, featuring panoramic windows, sliding doors, and an optional retractable roof, allows you to enjoy the sea in all weather conditions — from hot sunny days to cool evenings. The interior embodies Princess’s timeless craftsmanship, with elegant lines, soft tones, natural materials, and meticulous attention to detail. The main deck seamlessly connects a comfortable salon with a dining area and a fully equipped galley, creating an open, flowing space with the cockpit. This versatile layout provides the ideal setting for dining, relaxing, or entertaining guests while maintaining a sense of openness and light. Below deck, the C48 Deck Saloon offers two well-appointed cabins, a spacious bathroom, and a central lobby with ample storage — perfectly designed for both short escapes and extended cruising. The Michael Peters SVVT hull delivers outstanding stability, smooth performance, and efficiency, ensuring the C48 Deck Saloon moves with confidence, agility, and elegance across the water.

”



LAYOUTS

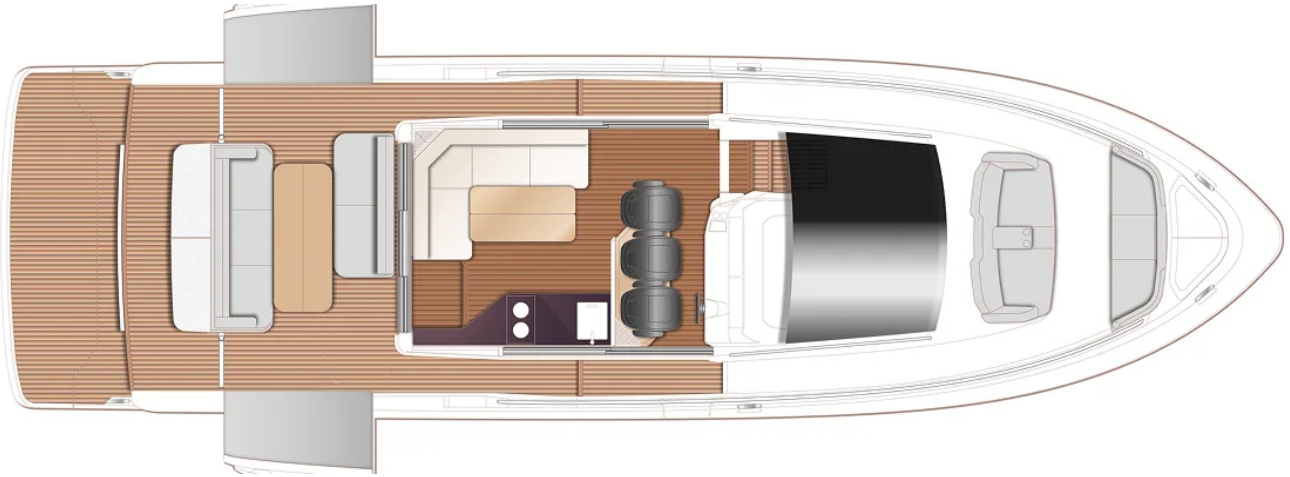

MAIN DECK

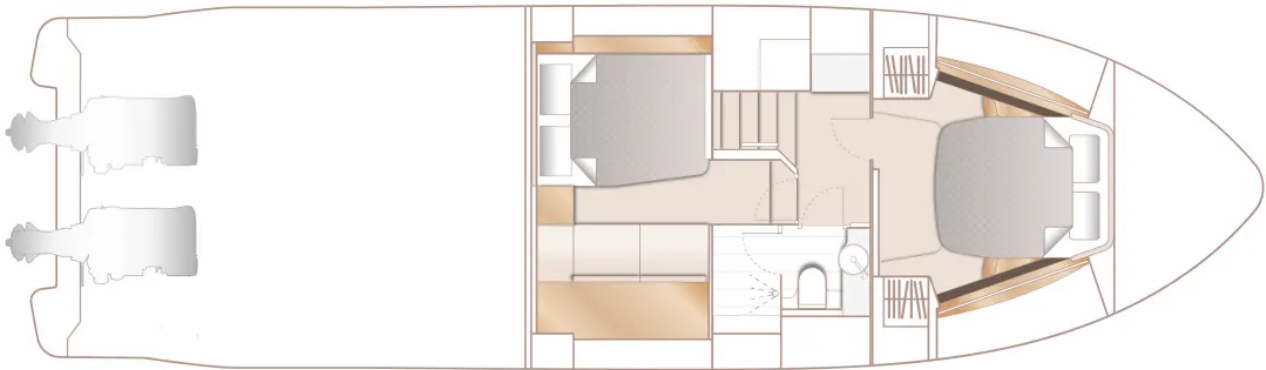

LOWER DECK

PRINCESS C48 (2026)

PRICE ON APPLICATION

+33 640 61 88 46 

m.st.pierre@princessyachtsmonaco.com

Follow Princess Yachts Monaco

