

PRINCESS F50 (2026)

1 435 900 £



STOCK

SPECIFICATIONS

Location	After request	Cabins	3
Year	2026	Berths	6
Length	15.65 m	Engines	Volvo IPS 800
Beam	4.30 m	Max power	(2 x 600) hp
Draft	1.39 m	Max speed	34
Displacement	22 tonnes	Engine hours	Contact seller
Fuel capacity	1850 l	Price	1 435 900 £ (ex VAT)
Water capacity	420 l		



Introducing the all-new Princess F50 – available for sale (**readiness march 2026**)!

For more details, don't hesitate to get in touch with us today!

”









LAYOUTS

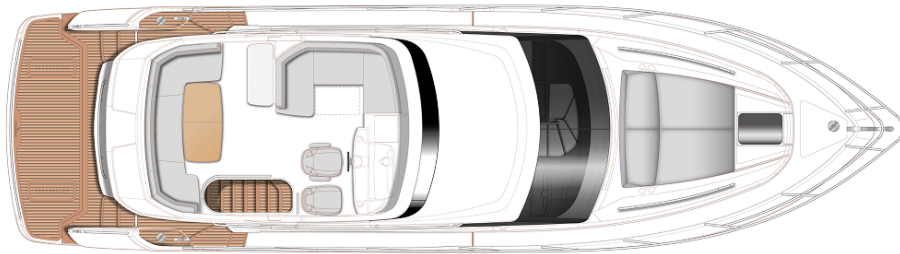

FLYBRIDGE

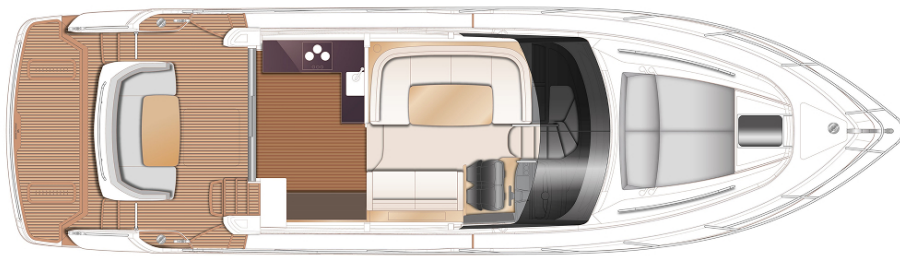

MAIN DECK

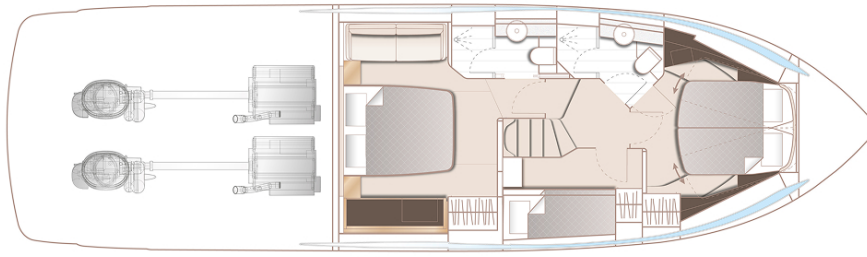

LOWER DECK

EQUIPMENT

“HULL COLOUR: White Gel Coat Finish (with dark grey water line, black antifouling, hull & bathing platform fendering is white with stainless steel insert)”

Gyro Stabilisation – Quick X16

Flybridge wetbar incorporating sink, electric griddle/ BBQ and storage

“Transom platform to have electro-hydraulic raise/lower facility (450Kg

Electro-hydraulic Passerelle (2.9m letterbox type) – with teak

Dimmer switch for deck saloon lighting

Stainless steel Lewmar Epsilon anchor with swivel in place of standard (20kg)

Teak (6mm) with black caulking to flybridge deck

“AGM 140 Ah batteries in place of standard (start, domestic and generator batteries) (not required when E-vision thrusters are selected as the battery upgrade is included in this package)”

Continental 220v/240v sockets

Foredeck freshwater anchor / deckwash system

Icemaker fitted in fat saloon sideboard

Bowthruster (120 Kgf) with dual station controls

“Walnut interior wood satin finish (helm foot rest and galley floor are V groove walnut as standard)”

Carrera White galley countertop

SWL – maximum advised tender weight 300Kg) with tender chock mounting system. Please note if both Gyro & Passerelle are fitted, the dinghy weight must not be greater than 125kg.”

Passerelle to be wired via the master switch in addition to its own switch

Additional 10m of 9.5mm anchor chain to give a total of 50 metres

Teak (6mm) with black caulking to side decks and foredeck

Full height fridge/freezer (270ltr) fitted in galley in place of standard

“ONAN 11 kW / 50Hz generator (with hydrohush exhaust system) in place of standard (recommended if airconditioning and/or a gyro is fitted)”

Underwater transom lights (4 Lumishore SMX54 Blue/White)

Dishwasher in galley (drawer type – 6 place setting)

“Deck Saloon Audio Package
Fusion Apollo MS-RA770 with
AM/FM/Bluetooth/DAB/WIFI in place of
standard Fusion Apollo MSRA670
• Paired with Focal speakers (4)
• Subwoofer”

“Deck Saloon TV Package •43” LED TV on a power lift mechanism linked to audio system”

“Cockpit Audio Package •Fusion Apollo SRX-400.
Paired with Fusion waterproof speakers (2)”

Garmin AIS Class B transponder interfaced with chartplotters

International VHF

“Tempered water Air Conditioning/heating reverse cycle (63,000 BTU fan capacity with 48,000 BTU chiller capacity) suitable for temperatures to 40°C (tropical) with controls in all cabins and outlets in all areas (including bathrooms)”

“Electric discharge In addition to the manual overboard and dockside discharge facilities an electric overboard discharge system is fitted. The electric overboard discharge system incorporates an electric valve with timer. When the pump is turned on a time delay allows the electric valve to open before the pump starts. When the pump is switched off the valve closes. This means the through hull seacock does not need to be opened/closed every time the pump is switched on. The through hull seacock is itself fitted with a micro switch which prevents operation of the pump when it is closed. The electric valve has a manual override facility”

“Foredeck Sunbeds with integrated headrest- Comfort Exterior IV MET/LINETEX/TANNERY – no contrast. Main Colour: MET MACADAMIA”

“Fit reticulated foam to all standard exterior cockpit and flybridge seating in place of standard”

“Owners Stateroom TV & Audio Package • 32” LED TV

Fusion Apollo MS- RA770 with AM/FM/Bluetooth/DA B/WIFI
“ Paired with Focal speakers (4)

“Garmin GMR 24 xHD3 colour radar with 24”, 4Kw Radome (with display on standard 16” screen which allows separate or split displays with standard chartplotter and engine instrumentation)”

European version plotter

“Windscreen demist system using warm air heater powered from calorifier”

Mosquito screens for all opening portholes

“Cockpit and Flybridge upholstery including helm seats in Comfort Exterior IV MET/LINETEX/TANNERY Main Upholstery Colour: MET MACADAMIA”

“Fit reticulated foam to foredeck sunpad cushion in place of standard. Note only applicable with Foredeck sunbed cushion option”

Exterior canvas – Grey canvas

Bimini top Grey Canvas	Additional Charge for Bimini to have LED dimmable overhead lightning
Princess China (6 [place setting)	Davide Mellor Paris Cutlery (6 place setting)
Fender Socks with Princess Logo (each) (Grey)	Additional charge for Milan X fabrics
“Helm seat upholstery leather upgrade with allure styling Helm seat in Putty leather with Arrow wood Novasuede contrast accents and added quilting.”	Carpet: MALDIVES TUSK

PRINCESS F50 (2026)

1 435 900 £ (ex VAT)

+33 6 40 61 88 46 

m.st.pierre@princessyachtsmonaco.com

Follow Princess Yachts Monaco

