

## PRINCESS V50 OPEN

Price on application



### SPECIFICATIONS

Location	United Kingdom, Plymouth
Length	15.49 m
Beam	4.11 m
Draft	1.14 m
Displacement	16.45 tonnes
Fuel capacity	1325 l
Water capacity	364 l

Cabins	2
Berths	4
Engines	Twin Volvo IPS 600
Max power	2 x 435 hp
Max speed	32-34 †
Price	Price on application

EQUIPMENT

DECK FITTINGS

Teak-laid transom platform, cockpit deck and steps to side decks

Reversible electric anchor winch with foredeck and helm position controls

Self-stowing 20kg/44lbs Delta anchor with 40m of chain

Stainless steel cleats, fairleads and handrails

Remote control searchlight

COCKPIT

Seating with folding teak table

Lockable gas strut assisted hatch to engine room

Transom gate leading to bathing platform with foldaway swimming ladder and hot and cold shower (with optional electro-hydraulic raise/lower mechanism and dinghy chock system)

Liferaft storage locker

220/240v shore support inlet

Locker with remote fuel cocks

Cockpit cover

Transom hatch to stern lazarette

Storage locker for 2 gas bottles

The V50 Open also incorporates: electro-hydraulic bathing platform with dinghy chock system as standard, aft sunpad and tender garage (up to 3.25m), large seating area aft with fixed teak table, electrically operated canvas sun roof, wetbar including sink, coolbox and storage with optional barbecue, L-shaped seating opposite the helm and sliding door to lower accommodation

HELM POSITION

Twin helm seat with bolster

Electric opening helmsman's window

Full engine instrumentation including fuel gauges, joystick control and rudder position indicator

Navigation system including VHF/RT, speed and distance log, echo sounder with alarm and high speed magnetic compass

Controls for windscreen wipers, bilge pump, anchor winch and trim tabs (with indicator)

Chart table

Remote control searchlight

DECK SALOON

Triple opening stainless steel framed sliding doors to cockpit

U-shaped sofa and dining table

Sideboard unit with glass and bottle storage and refrigerator

Electric opening roof

Stereo radio/MP3 with saloon and cockpit speakers

Timber-laid floor

GALLEY

3-zone gas hob with flame-failure device (3-zone ceramic hob standard on Open)

Remote solenoid switch for gas system

Combination microwave/convection oven with grill

Stainless steel sink with monobloc mixer tap

Full-height fridge/freezer

Waste bin

Storage cupboards, drawers and lockers

ACCOMMODATION

All cabins and bathrooms feature opening portholes

All cabins feature 220/240v power points

All mattresses pocket sprung

All bathrooms feature full shower stalls, electric freshwater toilets, extractor fan and 240v shaver points

OWNER'S STATEROOM

Large double bed with drawers below

Wardrobe with shelves

Sofa

Storage lockers and drawers

Overhead and individual berth lights

En suite bathroom

FORWARD GUEST CABIN

Large double bed with drawers below (option of scissor berths)

Wardrobe with shelves

Storage lockers

Deck hatch with integrated skylight and blind

Overhead and individual berth lights

En suite bathroom with optional day access

INTERIOR FINISH

Furniture in Rovere Oak with satin or high gloss finish. Walnut or Alba Oak available as an option

Solid surface worktops and tiled floors in all guest bathrooms

Solid surface worktop and timber-laid floor in galley

Choice of high quality carpet and upholstery fabric from extensive range
Curtains, blinds or sunscreens to all windows and portholes
POWER AND DRIVE SYSTEMS
Twin Volvo IPS-600 with joystick control
Volvo active corrosion protection system
Power-assisted electronic steering system with hydraulic back-up
Electronic engine and gear shift controls
Engine room extractor fan with electronic time delay
ELECTRICAL SYSTEMS
<b>24 Volt:</b>
4 x heavy duty batteries for engine starting
4 x heavy duty auxiliary batteries
40 amp battery charger charging both banks of batteries via automatic switch charging system
LED lighting throughout
<b>220/240 Volt:</b>
7kW diesel generator in own sound shield with water cooled specially silenced exhaust (Open only)
Shore support inlet in cockpit locker with storage for cable
Polarity check system
Earth leakage safety trip
Power points to all areas

FUEL SYSTEM

Twin fuel tanks (in NS8 marine grade alloy) with interconnection system giving 291 gal/350 US gal/1,325l capacity
Fuel fillers on port and starboard side decks

High capacity fuel filters/water traps
WATER SYSTEM
79 gal/95 US gal/358l plus 11 gal/13 US gal/50l hot water calorifier and heated by engine and 240v immersion heater
Water level gauge
Deck filler
FIRE EXTINGUISHERS
Automatic/manual override fire extinguishers in engine room with manual override
Hand-operated fire extinguishers (4) in owner's stateroom, guest cabin, galley and deck saloon
BILGE PUMPS
Automatic electric bilge pumps (3)
High-capacity manual bilge pump with valve system and suction points in same areas
OTHER ITEMS SUPPLIED AS STANDARD
Ensign staff
Fenders (6) and warps (4)
First aid kit
Tool kit
Set of manuals
Quilted bedspreads in all cabins

EXTERIOR

---





## INTERIOR



LAYOUTS

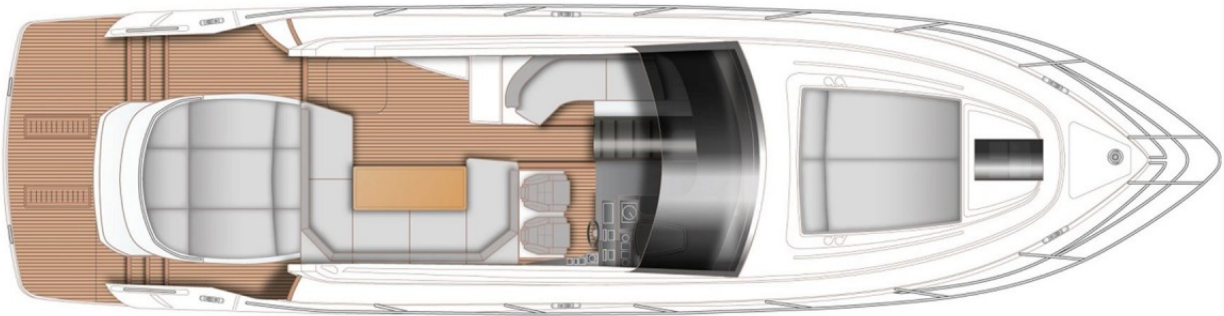

MAIN DECK

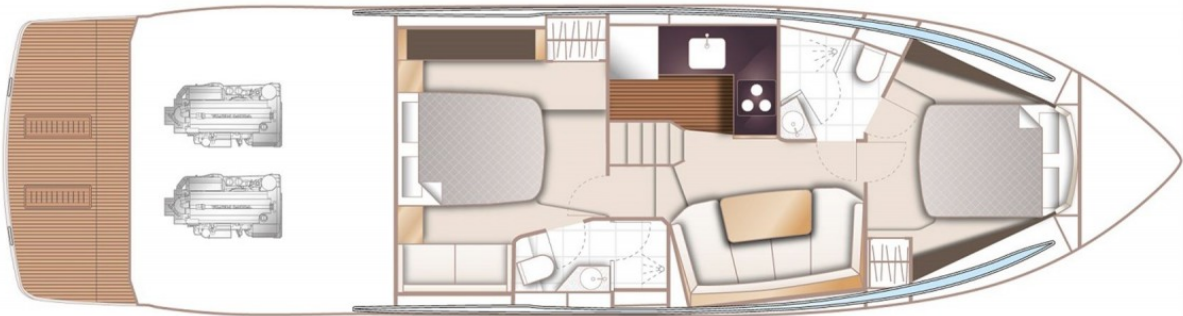

LOWER DECK

Yachts on the commission of Princess Yacht Monaco. The Company is not responsible for the accuracy of the information provided by the Shipowner (images used, yacht specifications, parameters, engine performance, legal design issues). The operating time of the engines is indicated at the time of preparation of the information and may change during further operation. The need for an inspection remains at the discretion of the Buyer. Exact parameters and characteristics can be specified in the contract of sale. Additional information is available from the manager on request.