

PRINCESS Y72 MOTOR YACHT

Price on application



SPECIFICATIONS

Location	United Kingdom, Shipyard	Cabins	4+1
Length	21.77 m	Berths	8+2
Beam	5.52 m	Engines	MAN V12-1650
Draft	1.72 m	Max power	2 x 1650 hp
Displacement	51.8 tonnes	Max speed	35 +
Fuel capacity	4500 l	Price	Price on application
Water capacity	909 l		

EQUIPMENT

DECK FITTINGS

Teak-laid transom platform, cockpit deck, flybridge, flybridge stairway and steps to side decks

Self-stowing 50kg/110lbs Delta anchor with 60m of chain

Reversible electric anchor winch with foredeck, helm position and flybridge controls

Stainless steel cleats, fairleads and handrails

Twin electric-powered sternline mooring winches

Freshwater deck/anchor wash

Foredeck seating and sunbathing area

Storage lockers for fenders and ropes

LED deck level lighting

COCKPIT

U-shaped seating with folding teak table

Twin transom gates leading to bathing platform with electro-hydraulic raise/lower mechanism, foldaway swimming ladder, hot and cold shower

Transom seat with storage locker

Lockable gas strut assisted hatch to engine room/ lazarette

Access to aft lazarette/optional crew cabin via transom door

Liferaft storage locker

Locker housing 220/240v shore support inlet

Cockpit cover

FLYBRIDGE

Dual station instrumentation, controls and alarm system including VHF/RT, speed and distance log, echo sounder with alarm and autopilot

Large U-shaped seating area with teak table

L-shaped seat (converts to a sunbed)

Sunpad aft with storage below

Twin helm seats with fore and aft adjustment for helmsman

Wetbar with barbecue, sink and drawer fridge

Naim audio system with waterproof speakers

Console, table and seat covers

LOWER HELM POSITION

Twin helm seats with fore and aft adjustment for helmsman

Helmsman's door to side deck

Full engine instrumentation including fuel gauges, exhaust temperature and engine warning system and rudder position indicator

Navigation system including colour radar, GPS and chartplotter, VHF/RT, speed and distance log, echo sounder with alarm, autopilot and high speed magnetic compass

Controls for bow thruster, windscreen wipers, bilge pump and Princess active ride control

24v and 240v control panel

12v outlet

Red night lighting

DECK SALOON

Stainless steel framed sliding doors to aft cockpit with integrated opening window aft of galley

U-shaped seating area with coffee table

Two-seater sofa

Entertainment centre incorporating 49" UHD LED TV on electric raise/lower mechanism and audio system with streaming capability and Blu-ray player connected to speakers

L-shaped sofa opposite helm area

Sideboard unit with bottle and glass storage

Refrigerator

Aft dining area

GALLEY

4-zone ceramic hob

Hob extractor

Combination microwave/convection oven with grill

Twin stainless steel sink with mixer tab

Full-height fridge/freezer

Icemaker

Dishwasher

Storage cupboards, drawers and lockers

ACCOMMODATION

All cabins and bathrooms feature opening portholes and air conditioning outlets

All cabins feature 220/240v power points

All mattresses pocket sprung (excluding crew)

All bathrooms feature full shower stalls, electric freshwater toilets, extractor fan and 240v shaver points

A combination washer/dryer is fitted in the stateroom lobby

OWNER'S STATEROOM

Large double bed with drawers below

Dressing area with wardrobes and drawer storage
Dressing table with stool
Sofa
Built-in safe
49" UHD LED TV and DVD Blu-ray system with Naim audio system
Storage lockers and drawers
En suite bathroom
Dedicated access with lobby area
FORWARD GUEST CABIN
Large double bed with drawers below
Wardrobe with shelves
Vanity unit
Storage lockers and drawers
Deck hatch
En suite bathroom
STARBOARD GUEST CABIN
Two single beds with drawers below (with option of sliding berths)
Wardrobe with shelves
Storage lockers and drawers
PORT GUEST CABIN
Two single beds with drawers below (with option of sliding berths)
Wardrobe with shelves
Storage lockers and drawers
En suite bathroom (with day access)
CREW CABIN
Two single berths with storage below
Wardrobe with shelf
En suite bathroom with stall shower
INTERIOR FINISH
Furniture in Rovere Oak or Alba Oak with a satin finish. Walnut or Silver Oak available as an option
Solid surface worktops and floors in all guest bathrooms
Galley worktops in choice of granite or quartz
Choice of high quality carpet and upholstery fabric from extensive range
Blinds or sunscreens to all windows and portholes

Timber-laid galley and helm floors
POWER AND DRIVE SYSTEMS
5-bladed propellers in nickel aluminium bronze
Princess active ride control
Bow thruster (250kgf/551lbf)
Power-assisted electro-hydraulic steering system with hydraulic back-up
Electronic engine and gear shift controls
Electronic engine controls
Dripless shaft seals
Engine room extractor fan with electronic time delay
ELECTRICAL SYSTEMS
24 Volt:
4 x heavy duty batteries for engine starting
6 x heavy duty auxilliary batteries
2 x 60 amp battery charger charges both banks of batteries via an automatic switch charging system
Remote battery master switches with control switch at main panel
LED lighting throughout
220/240 Volt:
22.5kW diesel generator in own sound shield with water cooled specially silenced exhaust
63 amp shore support inlet
Earth leakage safety trip, polarity check system, circuit breakers on all circuits
Power points in all areas
FUEL SYSTEM
Fuel tanks (in NS8 marine grade alloy) with interconnection system giving 990 gal/1,189 US gal/4,500l capacity
Fuel fillers on port and starboard side decks
High capacity duplex fuel filters/water traps with audible and visual fuel contamination warning system
Remote fuel isolation controls in cockpit locker
WATER SYSTEM
184 gal/221 US gal/836l plus 16 gal/19 US gal/73l hot water calorifier, heated by engines and 240v immersion heater
Water level gauge
Deck filler
Electric freshwater WC system with 88 gal/106 US gal/400l holding tank
FIRE EXTINGUISHERS

Automatic/manual override fire extinguishers in engine room with warning system at both helm positions

Hand-operated fire extinguishers in all cabins, galley and lower helm (6)

BILGE PUMPS

Automatic electric bilge pumps (6)

High capacity manual bilge pump with valve system and suction points in same areas

OTHER ITEMS SUPPLIED AS STANDARD

Set of cutlery, crockery and glasses (8)

Set of towels (8 large, 8 small)

Ensign staff

Fenders (6) and wraps (4)

First aid kit

Set of manuals

Tool kit

ENGINES

Twin MAN V12-1650 (2 x 1,650mhp)

EXTERIOR



INTERIOR



LAYOUTS

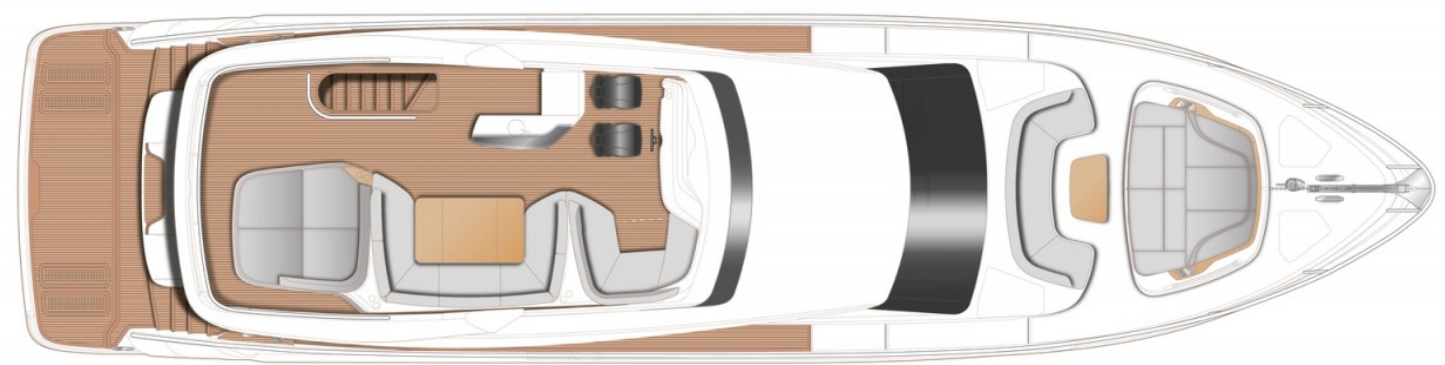

FLYBRIDGE

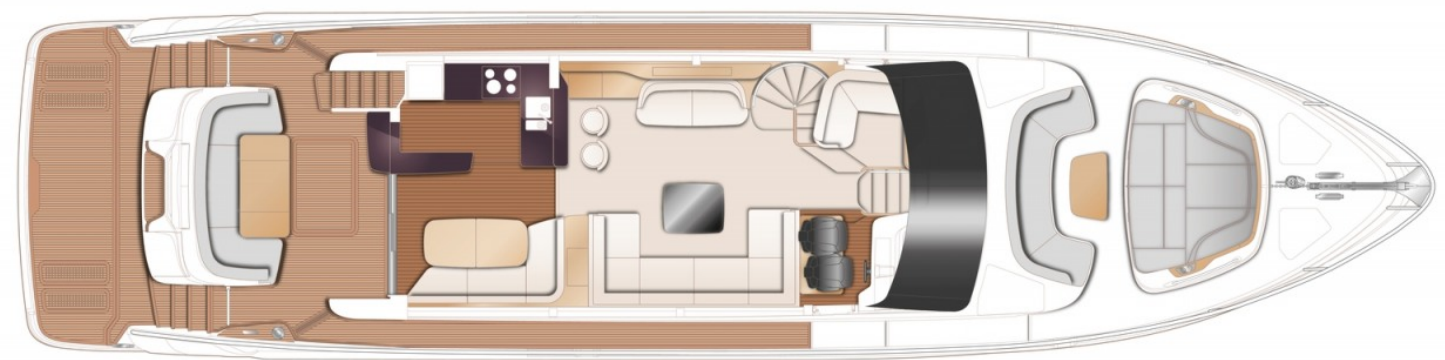

MAIN DECK

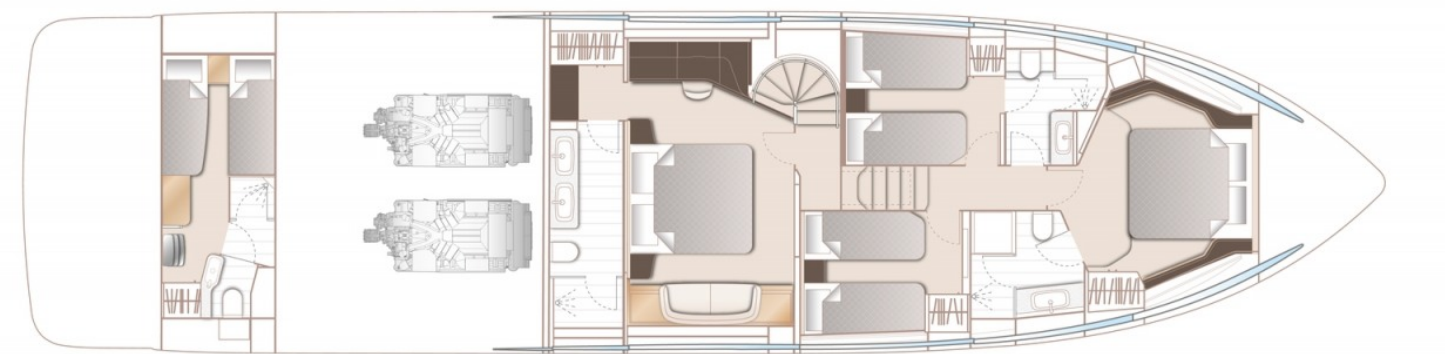

LOWER DECK

Yachts on the commission of Princess Yacht Monaco. The Company is not responsible for the accuracy of the information provided by the Shipowner (images used, yacht specifications, parameters, engine performance, legal design issues). The operating time of the engines is indicated at the time of preparation of the information and may change during further operation. The need for an inspection remains at the discretion of the Buyer. Exact parameters and characteristics can be specified in the contract of sale. Additional information is available from the manager on request.