

PRINCESS Y75

3 939 000 €



SOLD

HIGHLIGHTS

/ / /

SPECIFICATIONS

Location	Netherlands	Cabins	4+2
Year	2019	Berths	8+4
Length	24.67 m	Engines	Twin MAN V12-1800
Beam	5.76 m	Max power	2 x 1800 hp
Draft	1.72 m	Max speed	34-36
Displacement	47.7 tonnes	Engine hours	35 m/h
Fuel capacity	6000 l	Price	3 939 000 € (ex VAT)
Water capacity	1350 l		



New Princess Y75 for sale. VAT excluded. Located in Netherlands.

”















LAYOUTS

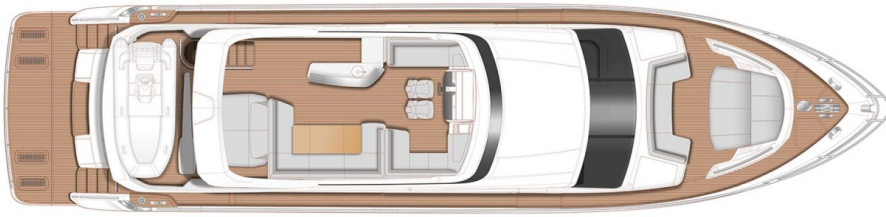

FLYBRIDGE

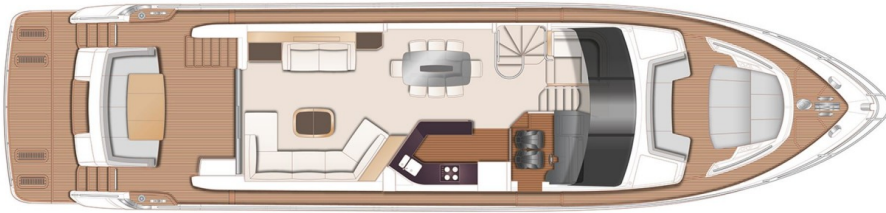

MAIN DECK

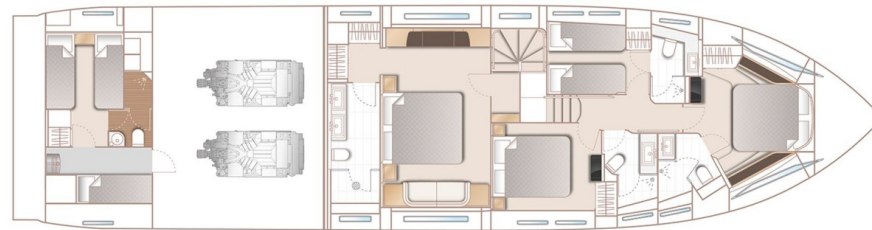

LOWER DECK

EQUIPMENT

PREMIUM AUDIO SYSTEM incorporates:

Hydraulic system consisting of separate engine driven hydraulic pumps allowing any system to be supplied with hydraulic power from either engine. Including hydraulic anchor winch and 300 kgf hydraulic bow thruster (in place of standard) 300 kgf hydraulic stern thruster and hold function docking system. All with dual station controls

Sleipner Vector Fin stabilisation system with VF1050 fins. When underway fins are driven by engine powered hydraulic motors and at zero speed by a generator powered electric motor (only available if hydraulics are specified). 27Kw generator is recommended

White hull
(with Charcoal Grey waterline, Black antifouling & Charcoal Grey hull pinstripe, hull & bathing platform fendering is White with stainless steel insert)

Walnut interior wood satin finish (galley & helm floors are walnut as standard)

Port cabin to have double berth conversion with powered sliding mechanism on inboard berth

All roman blinds on maindeck are changed in venetian blinds wood in frosted white duo. (50mm)

In Forward cabin, Port cabin en Starboard cabin supply and fit Frosted Sand white duo venetian blinds instead of standard Walnut venetian

Allure pack

Transom/flybridge teak step nosing upgrade

Severy sprayed in Oyster Grey (when servery specified)

Spray flybridge console in Oyster Grey

Option to spray hardtop. If hull is painted, default option will be Oyster Grey unless

Reticulated foam to all standard exterior cockpit and flybridge seating/sunpads in place of standard

Teak coffee table (with deck mounted fixing point) for foredeck

Carbon poled Foredeck sun awning with grey mesh shade

Organic White quartz galley worktop

All guest bathrooms to be in Carrara White instead of standard Koko White

Teak laid side decks and foredeck walk through area

GRP Flybridge hardtop featuring electric opening section in soft fabric (including lighting)

Third station controls in cockpit (engine controls, thruster controls and engine emergency stop)

Stainless steel keyway plates and slider system for later fitting of tender

Cockpit servery unit (including 100l drawer fridge and storage cupboard, sink and tap)

Cockpit servery unit to have small sink and tap filled

Teak coffee table (with deck mounted fixing point) for foredeck

Prepare for later fitting of flybridge crane i.e. run copex from crane base area to AC/DC panel

ONAN 27Kw/50Hz generator fitted in place of standard (recommended if Fin stabilisers are fitted)

Continental 220v/240v sockets

otherwise stated	Fit 12 bottle wine cooler in galley
Internal helm seats in Sapang Bronze leather to match forward dinette seating	Freshwater maker (190l/hour) complete with remote instrumentation and service/spares kit
Inset font panel and Allure Collection additional contrast piping in Gabardine Arrow Wood novasuede.	Lava Brick BBQ in place of standard
External helmseats – main material Comfort Exterior II Met Ice. Contrast to inset panel to front of backrest an styling wedge to back of headrest Comfort Exterior II Met Meteor. Contrast stich to match Met Meteor in Serafil thread 399.	In bathrooms supply and fit dark grey venetian blinds in place of standard gold bullion
Flybridge external upholstery. Main Material Comfort Exterior II Met Ice. Contrast panelling and piping Comfort Exterior II Met Meteor	Heated towel rail in bathroom in Owners cabin and Forward cabin
Underwater transom lights (4 LUMISHORE SMX53 Blue)	Underfloor heating in bathroom in Owners cabin and Forward cabin
Underwater lighting to aft hull sides (4 SUMISHORE SMX53 Blue)	Separate washing machine and condenser dryer located in utility area (in place of standard washer/dryer)
Lower accommodation lighting upgrade package	Ice maker fitted in flybridge wetbar
Includes: low level ambient lighting in all sleeping cabins wiht overhead lighting on dimmer switch (standard in master stateroom)	Upper accommodation lighting upgrade package
Upper accommodation lighting upgrade package	Includes: Overhead accent lights to aft galley screens combined with additional ambient lighting in forward saloon area
Includes: overhead accents lights to aft galley screens combined with additional ambient lighting in forward saloon area	Lower accomodation light upgrade package
Exterior lighting upgrade package	Includes: Low level ambient lighting in all sleeping cabins with overhead lighting on dimmer switch (standard in Master Stateroom)
Includes: additional deck level lights on side decks and transom, flybridge deck and wetbar	Exterior lighting upgrade package
Optional saloon table lamp (located on forward starboard crockery unit)	Includes: Additional deck level lights on side decks and transom, flybridge deck and wetbar.
Porta Romana, Grace lamp clb29 in 5 stone	Also pop up lanterns (2) in foredeck sunbathing area
Porta Romana, shade for above: 13' top hat with chalk linen shade	
Optional stateroom table lamp (located at aft	

end of port vanity unit)

Porta Romana, base cologne lamp glb49 in 2
olive wiht decayed gold collar

Porta Romano, shade for above: 16' straight
oval with taupe silk shade

ENGINES

Twin MAN V12-1800 (2 x 1800 hp)

PRINCESS Y75

3 939 000 € (ex VAT)

+33 6 40 61 88 46 

m.st.pierre@princessyachtsmonaco.com

Follow Princess Yachts Monaco

