

2010 SANLORENZO 88

2 600 000 €



BROKERAGE

## HIGHLIGHTS

- / PERFECTLY MAINTAINED      / 4 CABIN LAYOUT                      / WATERMAKER
- / 2 GENERATORS                      / HYDRAULIC GANGWAY              / ELECTRO-HYDRAULIC  
TRANSOM PLATFORM
- / TV/AV EQUIPPED                      / ZERO SPEED STABILIZERS      / CCTV
- / WILLIAMS TENDER                      / RELIABLE CAT ENGINES

## SPECIFICATIONS

Location	Monaco	Cabins	4
Year	2010	Berths	9
Length	26.75 m	Engines	Caterpillar C32 DITA
Beam	6.75 m	Max power	2 x 1902 hp
Draft	2.15 m	Max speed	28
Fuel capacity	12000 l	Engine hours	1200 m/h
Water capacity	3000 l	Price	2 600 000 € (inc VAT)

The yacht is on the commission of Princess Yacht Monaco. The Company is not responsible for the accuracy of the information provided by the Yacht owner (images, specification, parameters, engine performance, legal, etc). The operating time of the engines is indicated at the time of preparation of the information and may change during further operation. The need for an inspection remains at the discretion of the Buyer. Exact parameters and characteristics can be specified in the contract of sale. Additional information is available upon request.



Built in 2010 and privately used only, this Sanlorenzo 88 offers sumptuous accommodation for up to 9 guests in 3 en-suite Staterooms plus one convertible office cabin, and 4 Crew. Featuring an Aft Master Stateroom on the Lower Deck with walk-in wardrobe and large hammam shower, a full-beam VIP en-suite Cabin, a Starboard Twin en-suite and a Portside Office Cabin, which could easily be converted into an en-suite double. Fitted with the CAT C32 DITA Engines she is capable of top speeds of 28 Knots. Flybridge layout with freestanding aft sunbathing cushions offers a lot of space for onboard entertainment. The spacious aft cockpit area is ideal for an alfresco experience or evening cocktails.

For more information, please contact Michael St. Pierre +33640618846 (WhatsApp)









GALLERY

---



GALLERY

---









GALLERY

---





# LAYOUTS

---

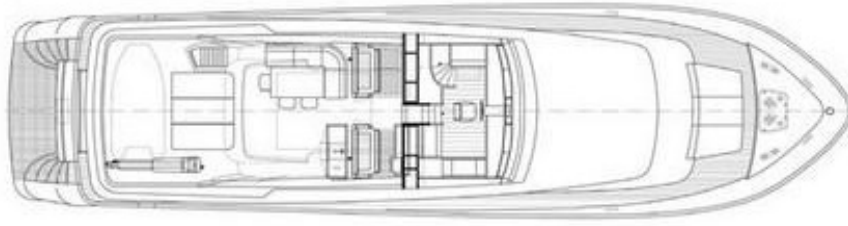

FLYBRIDGE

---

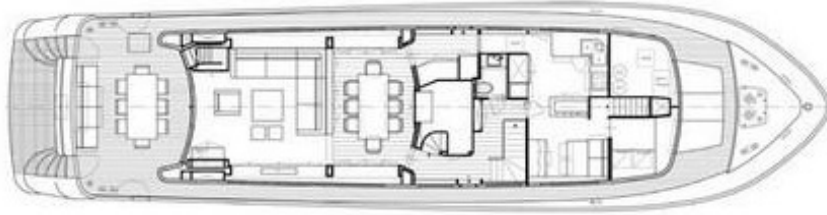

MAIN DECK

---



LOWER DECK

---

## EQUIPMENT

---

Kohler generators, 1×33 kw + 1×27 kw	Condaria air conditioning
Hydraulic bow thruster	Hydraulic stern thruster
230 lt / h water maker	Retractable hydraulic gangway
Air compressor	Mitsubishi Zero Speed stabilizers
System Hamman black water purification	Infrared anti-intrusion system -
Fire -fighting system	Closed circuit TV system with cameras in the engine room and stern, monitor on the bridge,
GSM telephone	system - Mobile on flybridge with Miele electric plate, mini bar and sink
Electro-hydraulic crane on flybridge	Williams tender with hydrojet engine
Teak on the flybridge	Rigid bimini
Third maneuvering station aft	Underwater lights (6)
Two anchor winches with mooring bells and chain counter (fly and bridge)	Mooring winches aft
Mini Black communication satellite antenna	Satellite TV antenna
N. 7 LCD TV with 7 decoders, CD and DVD	LED lighting with dimmer
Miele coffee machine with built-in coffee grinder	Refrigerated wine cellar
Ice maker	Additional fridge / freezer
Miele washing machine and dryer ( professional)	Total winter and summer closure for the cockpit
Two Raymarine G170 monitors	Radar
Autopilot	GPS / plotter
Wind station	2 VHF
SSB	Ecosonde
On-board computer	Caterpillar engine control monitor
Intercom system	<b>INTERIOR DESCRIPTION</b>

Living room with “L” -shaped sofa, armchair and low table, opposing cabinet

---

Daily service bathroom

---

microwave oven, dishwasher, waste compactor, crew dinette and ladder down to the crew

---

**LOWER DECK:**

---

A double cabin with twin beds + foldaway third bed, bathroom with shower

---

VIP cabin forward with double bed, bathroom with shower

---

**CREW:**

---

Dining area with table and eight chairs

---

Large kitchen with 75 cm induction hob, fridge / freezer column, double electric oven,

---

Raised wheelhouse with dinette.

---

Owner cabin amidships with double bed, double bathroom with shower

---

A double guest cabin currently used as an office, bathroom with shower

---

Rosewood interiors, leather sofas, parquet flooring on the day deck

---

Two double cabins with bunk beds, two bathrooms

---

---

2010 SANLORENZO 88

2 600 000 € (inc VAT)

+33 6 40 61 88 46 

[m.st.pierre@princessyachtsmonaco.com](mailto:m.st.pierre@princessyachtsmonaco.com)

---

Follow Princess Yachts Monaco

